

ROHS

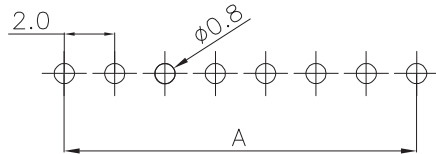
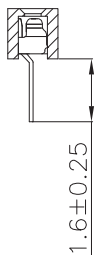
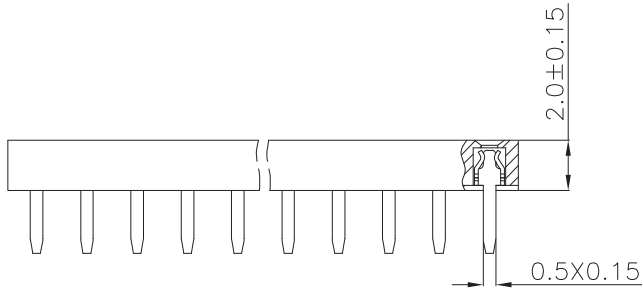
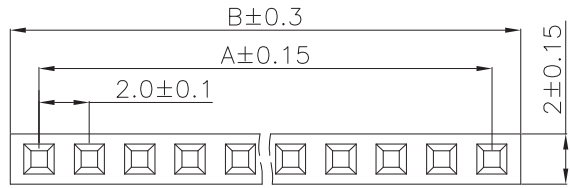

Recommended P.C.B Layout(Top Side)  
(PCB BOARD TOLERANCE±0.05)

1,ELECTRICAL SPECIFICATIONS:

- 1.1 Rated current and voltage(额定电流):  
1.5A 125V AC(r.m.s)
- 1.2 Dielectric Withstanding Voltage(耐电压) :  
500V AC for one minute
- 1.3 Contact Resistance(接触电阻) :  
<20mΩ
- 1.4 Insulation Resistance(绝缘电阻) :  
>1000MΩ
- 1.5 Operating Temperature(工作温度) :  
-40°C ~ 105°C

2,MATERIAL SPECIFICATION:

- 2.1 Insulator Material(绝缘体材质):  
High Temperature Plastic ,  
UL94V-0 PA6T
- 2.2 Contact Material(端子材质):  
Phosphor Bronze/AU

▲ Non-tooled parts  
NO.of positions DIM list:

CONTACTS	DIMENSIONS	
	A	B
2	2.00	4.30
3	4.00	6.30
4	6.00	8.30
5	8.00	10.30
6	10.00	12.30
7	12.00	14.30
8	14.00	16.30
9	16.00	18.30
10	18.00	20.30
11	20.00	22.30
12	22.00	24.30
13	24.00	26.30
14	26.00	28.30
15	28.00	30.30
16	30.00	32.30
17	32.00	34.30
18	34.00	36.30
19	36.00	38.30
20	38.00	40.30
21	40.00	42.30
22	42.00	44.30
23	44.00	46.30
24	46.00	48.30
25	48.00	50.30
26	50.00	52.30
27	52.00	54.30
28	54.00	56.30
29	56.00	58.30
30	58.00	60.30
31	60.00	62.30
32	62.00	64.30
33	64.00	66.30
34	66.00	68.30
35	68.00	70.30
36	70.00	72.30
37	72.00	74.30
38	74.00	76.30
39	76.00	78.30
40	78.00	80.30

PART NO. LEGEND:

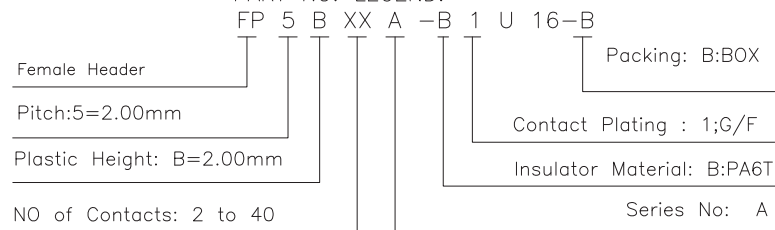

E				DRAWING:	GENERAL TOLERANCE .X:=±0.30 .X*:=±2° .XX:=±0.20 .XX*:=±1° .XXX:=±0.10 .XXX*:=±0.5°
D				Hu yatao	
C				CHECKED:	UNIT: MM PROJECTION:
B				Tony	
A				APPROVAL:	SCALE: N/A
NO.	DATE	DESCRIPTION	APPROVAL	Yang jie	
					SHEET: 1/1



**CHIN-BAN**  
electronics (H.K.) co., ltd

DESCRIPTION:  
2.00mm Pitch Female Header Single Row DIP 180°

PART NO:	FP5BXXA-B1U16-B	REV:1.0
CUSTOMER NO:		SIZE: A4