

SUMMARY

Wires

| | |
|-------------|---|
| Fiber optic | 1 |
|-------------|---|



Image is for illustrative purpose only

| | |
|------------------|------------------------------------|
| Series | 2B |
| Termination type | Hybrid contacts |
| IP rating | 50 |
| AWG wire size | 26.00 - 22.00 |
| Cable Ø | 0.00 - 0.00 mm |
| Status | active |
| Matching parts | FGG.2B.96C.CLCD62Z |

Download

[Request a quote](#)

[Catalog](#)

TECHNICAL DETAILS

Mechanics

| | |
|-------------------|---|
| Shell Style/Model | EG*: Fixed receptacle, nut fixing |
| Keying | 1 key (alpha=0, plug: male contacts, receptacle: female contacts) |
| Housing Material | Brass (chrome plated [SAE AMS 2460]) shell and collet nut, nickel plated [SAE AMS QQ N 290] brass latch sleeve and mid pieces |
| Weight | 14.27 g |

Performance

| | |
|---------------|-----------------------------|
| Configuration | 2B.96C : 1 FO Type F1, 4 LV |
| Insulator | L: PEEK (UL 94 / V-0/1.5) |
| Rated Current | 6 Amps |

Specifications

| | |
|--------------------------|--------------------------------------|
| Contact Type: | Crimp |
| Fiber Optic Contact: | Type F1 (must be ordered separately) |
| Vtest (contact-shell): | 1250 V (AC), 1770 V (DC) |
| Vtest (contact-contact): | 850 V (AC), 1200 V (DC) |

Others

| | |
|--------------------|------|
| Endurance (Shell): | 5000 |
|--------------------|------|

LEMO products and services are provided "as is". LEMO makes no warranties or representations with regard to LEMO product & services or use of them, express, implied or statutory, including for accuracy, completeness, or security. The user is fully responsible for his products and applications using LEMO components.

Temp (min / max): -40° C / +80° C
Humidity (max): <=95% [at 60 deg C /140 F]
Vibration: 15 g [10 Hz - 2000 Hz]
Shock Resistance: 100 g [6 ms]
Climatical Category: 50/175/21
Shielding (min): 75 dB (10 MHz)
Shielding (min): 40 dB (1 GHz)
Salt Spray Corrosion: >1000 hr

DRAWINGS

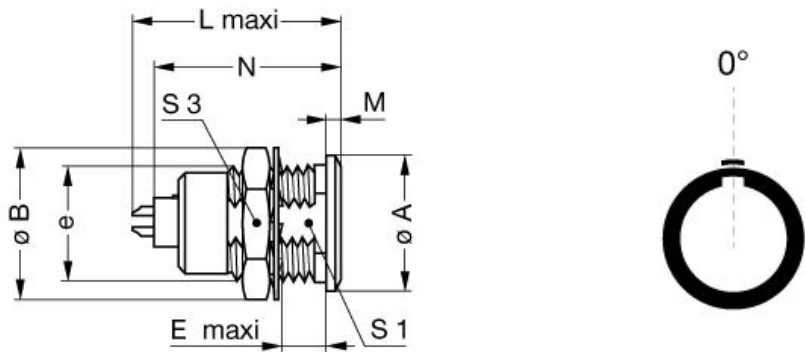

Dimensions

| | A | B | E | L | M | N | S1 | S3 | e |
|-----|------|------|------|------|------|------|------|------|---------|
| mm. | 18 | 19.5 | 8.5 | 26.7 | 1.8 | 24.6 | 13.5 | 17 | M15x1.0 |
| in. | 0,71 | 0,77 | 0,33 | 1,05 | 0,07 | 0,97 | 0,53 | 0,67 | |

RECOMMENDED BY LEMO

Tools

- Crimp settings: AWG/Selector = 22-24-26/6-5-5
Positionner: [DCE.91.072.BVM](#)
Extractor: [DCC.91.070.5LA](#)
Extractor 2: [DCF.91.070.2LT](#)

LEMO products and services are provided “as is”. LEMO makes no warranties or representations with regard to LEMO product & services or use of them, express, implied or statutory, including for accuracy, completeness, or security. The user is fully responsible for his products and applications using LEMO components.

Replacement contact: EGG.2B.655.ZZM

LEMO products and services are provided "as is". LEMO makes no warranties or representations with regard to LEMO product & services or use of them, express, implied or statutory, including for accuracy, completeness, or security. The user is fully responsible for his products and applications using LEMO components.