

## SUMMARY

### # Wires

Low voltage 3



*Image is for illustrative purpose only*

Series	00
Termination type	Female print PCB
IP rating	50
AWG wire size	34.00 - 28.00
Cable Ø	0.00 - 0.00 mm
Status	active
Matching parts	<a href="#">FVB.00.303.CLAD27Z</a>

### Download

[Request a quote](#)  
[PCB Eagle Pattern](#)  
[PCB Altium Pattern](#)  
[PCB KiCad Pattern](#)  
[Catalog](#)

## TECHNICAL DETAILS

### Mechanics

Shell Style/Model	XB*: Elbow receptacle fixing nut for printed circuit (back panel mounting)
Keying	1 key (alpha=0, plug: male contacts, receptacle: female contacts)
Housing Material	Brass (nickel plated [SAE AMS QQ N 290]) shell, collet nut, latch sleeve and mid pieces
Weight	4.61 g

### Performance

Configuration	00.303/XBG : 3 Low Voltage
Insulator	L: PEEK (UL 94 / V-0/1.5)
Rated Current	2 Amps

### Specifications

Contact Type: Print (straight)  
Test voltage contact-contact : 1 kV rms  
Test voltage contact-body shell : 1 kV rms

### Others

Salt Spray Corrosion: >144 hr

*LEMO products and services are provided "as is". LEMO makes no warranties or representations with regard to LEMO product & services or use of them, express, implied or statutory, including for accuracy, completeness, or security. The user is fully responsible for his products and applications using LEMO components.*

# DRAWINGS

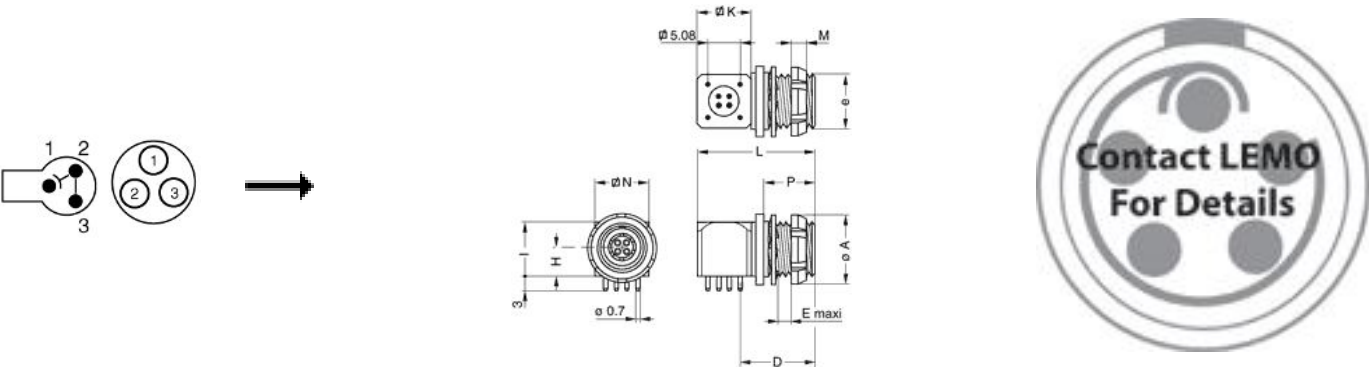

## Dimensions

	A	D	E	H	I	K	L	M	N	P	e
mm.	10	11.5	6.5	3.5	7	7	17.5	2.5	7	9	M7x0.5
in.	0,39	0,45	0,26	0,14	0,28	0,28	0,69	0,10	0,28	0,35	

# RECOMMENDED BY LEMO

## Tools

Spanner wrench: [DCB.91.455.0LN](#)

LEMO products and services are provided “as is”. LEMO makes no warranties or representations with regard to LEMO product & services or use of them, express, implied or statutory, including for accuracy, completeness, or security. The user is fully responsible for his products and applications using LEMO components.