

F

E

D

C

B

A

F

E

D

C

B

A

SLA3\_BUSS\_JAN\_GERBL\_REV\_A

8		7		6		5		4		3		2		1		
CATALOG NO.	TERMINAL TYPE	IP20 FINGER SAFE C		NO. OF POLES												
		W/O INDICATION	INDICATION													
HM60030-1SR	SCREW	CVR-RH-60030	CVRI-RH-60030	1												
HM60030-2SR	SCREW			2												
HM60030-3SR	SCREW			3												
HM60030-1PR	PRESSURE PLATE			1												
HM60030-2PR	PRESSURE PLATE			2												
HM60030-3PR	PRESSURE PLATE			3												
HM60030-1CR	BOX LUG			1												
HM60030-2CR	BOX LUG			2												
HM60030-3CR	BOX LUG			3												
HM60030-1MW14	BOX LUG - 4 PORT MULTIWIRED	NA	NA	1												
HM60030-2MW14	BOX LUG - 4 PORT MULTIWIRED			2												
HM60030-3MW14	BOX LUG - 4 PORT MULTIWIRED			3												
* -CHR ALSO AVAILABLE; SEE NOTE 11																
		HM60030-1SR			HM60030-1PR			HM60030-1MW14								
		3D VIEW FOR HM60030-1MW14 SCALE NONE			3D VIEW FOR HM60030-1CR SCALE NONE			3D VIEW FOR HM60030-1PR SCALE NONE			3D VIEW FOR HM60030-1SR SCALE NONE			3D VIEW FOR HM60030-1xR WITH COVER SCALE NONE		
<div><div></div><div>BUSSMANN SERIES</div></div> <div>TITLE 600V / 30AMP CLASS R &amp; H FUSE BLOCK</div> <div><div>SIZE A3</div><div>DWG NO. RM60030-HM60030-SERIES-CP</div><div>REV B</div></div> <div>SCALE: 1:2<div>SHEET 2 OF 3</div></div>																
8		7		6		5		4		3		2		1		

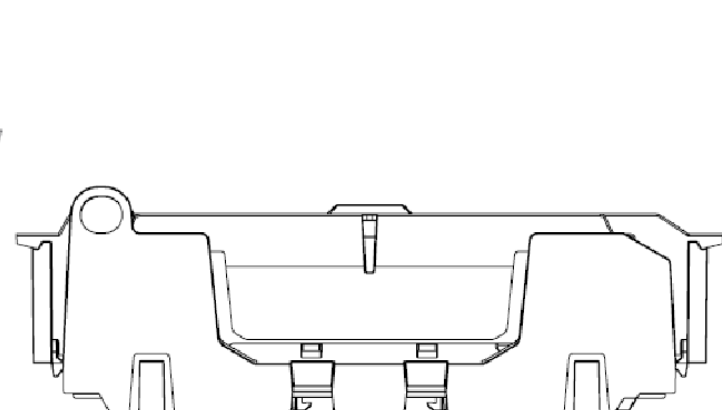
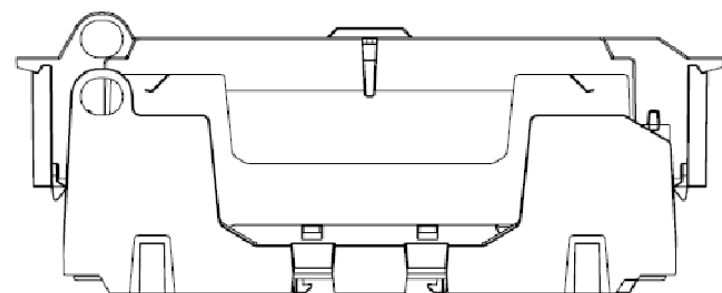

**CLOSING**  
PUSH STRAIGHT DOWN UNTIL SNAPS CLICK INTO PLACE

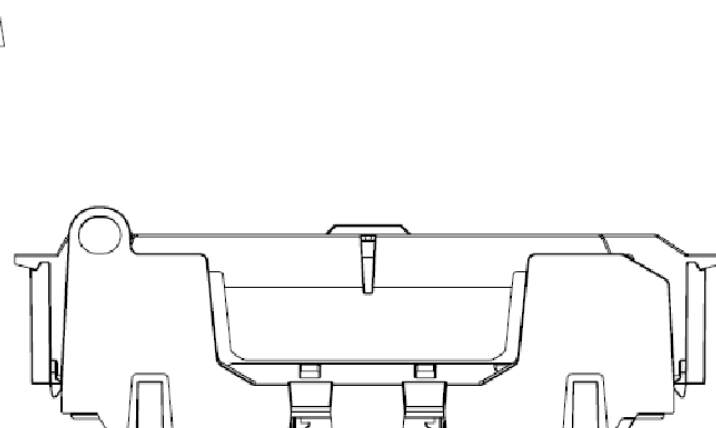
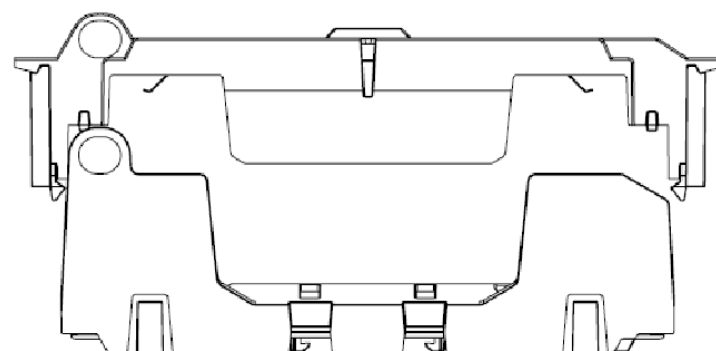

**OPENING**  
PULL STRAIGHT UP AT BOTH OUTSIDE HANDLES

CUT COVER TAB AT NOTCH FOR WIRES LARGER THAN 8 AWG

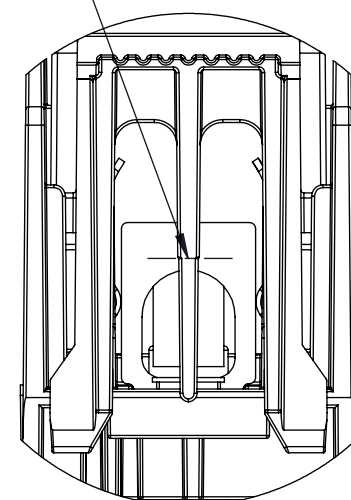

DETAIL A  
SCALE 1.5 : 1

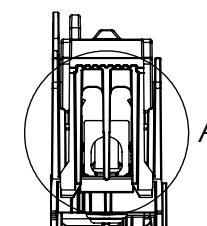

A

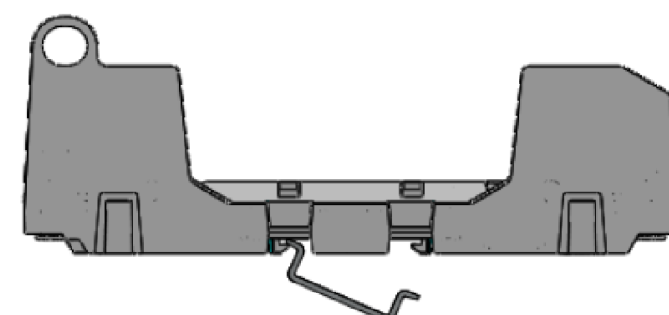

1. HOOK DIN RAIL SNAPS ON ONE SIDE OF THE DIN RAIL

2. PUSH DOWN TO DEFLECT THE SNAPS

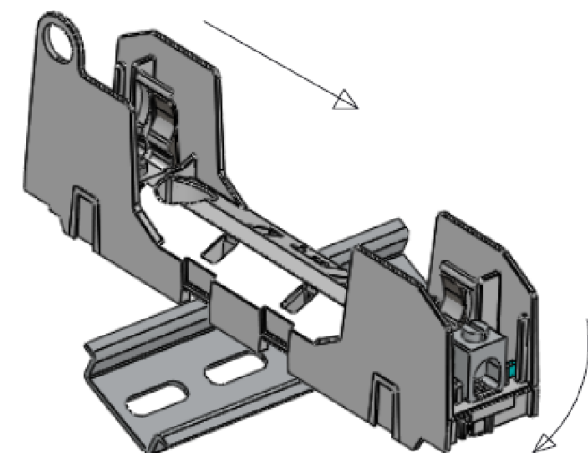

3. ROTATE UNTIL THE OPPOSITE SIDE SNAPS ONTO DIN RAIL

**INSTALLATION ON DIN RAIL**  
END STOPS MAY BE NECESSARY FOR SOME ASSEMBLY CONDITIONS - SEE NOTE 7

# Mouser Electronics

Authorized Distributor

Click to View Pricing, Inventory, Delivery & Lifecycle Information:

## Eaton:

[HM60030-2PR](#) [HM60030-1CR](#) [HM60030-3SR](#) [HM60030-2CR](#) [HM60030-2SR](#) [HM60030-1SR](#) [HM60030-3PR](#)  
[HM60030-1PR](#) [HM60030-3CR](#) [RM60030-3SR](#) [RM60030-3CR](#) [RM60030-3PR](#) [RM60030-1CHR](#) [RM60030-1SR](#)  
[RM60030-1CR](#) [RM60030-1PR](#) [RM60030-1MW14](#) [RM60030-2CHR](#) [RM60030-2MW14](#) [RM60030-3CHR](#) [RM60030-](#)  
[3MW14](#) [RM60030-2CR](#) [HM60030-1CHR](#) [HM60030-1MW14](#) [HM60030-2CHR](#) [HM60030-2MW14](#) [HM60030-3CHR](#)  
[HM60030-3MW14](#)