

## Transient Voltage Suppressors for ESD Protection

### SE05T2C02GK

#### Features

- ◆ Working voltage: 5V
- ◆ Low leakage current:  $0.1\mu\text{A} @ V_{\text{RWM}}$
- ◆ Low clamping voltage
- ◆ Response Time is  $< 1 \text{ ns}$

#### SOT-23



#### Applications

- ◆ Portable Instrumentation.
- ◆ Networking and Telecom.
- ◆ Serial and Parallel Ports.
- ◆ Peripherals.

#### Pin Configuration

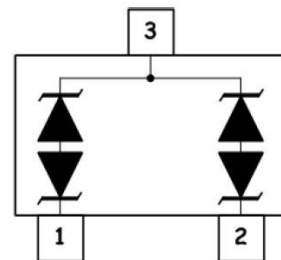

#### Mechanical Characteristics

- ◆ SOT-23 Package
- ◆ Molding Compound Flammability Rating: UL 94V-0
- ◆ Quantity Per Reel: 3,000pcs
- ◆ Reel Size: 7 inch

#### Absolute Maximum Rating

Symbol	Parameter	Value	Units
$T_{\text{LST}}$	Lead Soldering Temperature	260 (10sec)	$^{\circ}\text{C}$
$T_{\text{STG}}$	Storage Temperature Range	-55 to +150	$^{\circ}\text{C}$
$T_{\text{OPT}}$	Operating Temperature Range	-55 to +150	$^{\circ}\text{C}$
$V_{\text{ESD}}$	ESD per IEC 61000-4-2(Air)	$\pm 15$	KV
	ESD per IEC 61000-4-2 (Contact)	$\pm 8$	

## Transient Voltage Suppressors for ESD Protection

### SE05T2C02GK

#### I-V Curve Characteristics

Symbol	Parameter
$I_{PP}$	Maximum Peak Pulse Current
$V_C$	Clamping Voltage @ $I_{PP}$
$V_{RWM}$	Working Peak Reverse Voltage
$I_R$	Maximum Reverse Leakage Current @ $V_{RWM}$
$V_{BR}$	Breakdown Voltage @ $I_T$
$I_T$	Test Current

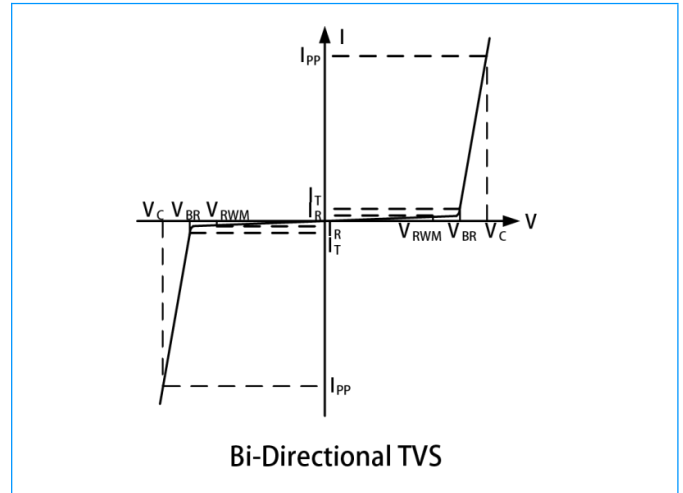

#### Electrical Characteristics (@ $T_A=25^\circ\text{C}$ Unless Otherwise Specified )

Symbol	Test Condition	Minimum	Typical	Maximum	Units
$V_{RWM}$	--	--	--	5	V
$I_R$	$V_{RWM}=5\text{V}, T=25^\circ\text{C}$	--	--	0.1	$\mu\text{A}$
$V_{BR}$	$I_T=1\text{mA}$	6	--	--	V
$V_C$	$I_{PP}=1\text{A}, t_p=8/20\mu\text{s}$	--	14	--	V
$V_C$	$I_{PP}=4\text{A}, t_p=8/20\mu\text{s}$	--	22	--	V
$C_J$	$V_R=0\text{V}, f=1\text{MHz}$	--	0.3	--	pF

#### Electrical Characteristic Curves

**Fig1. Pulse Waveform**

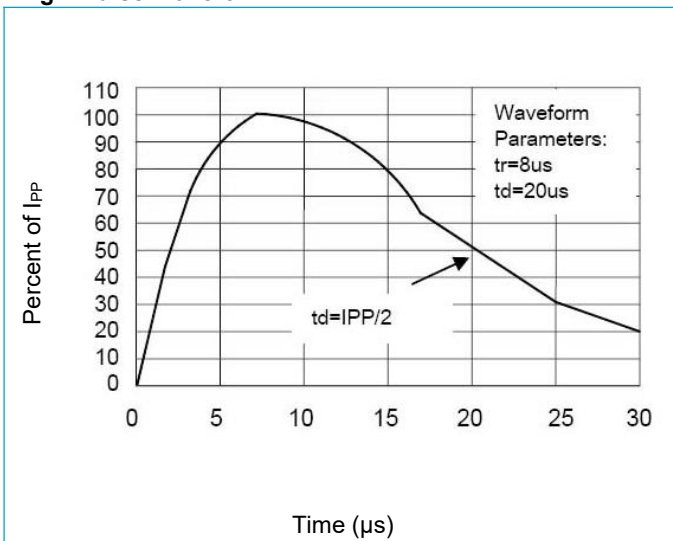

**Fig2. Power Derating Curve**

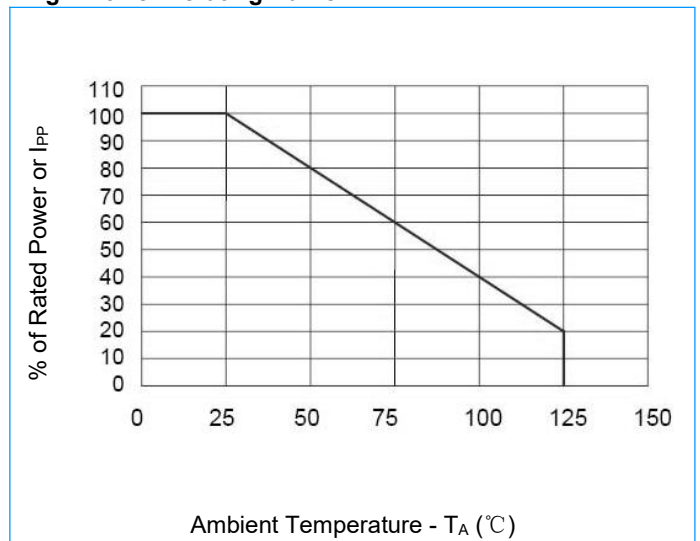

## Transient Voltage Suppressors for ESD Protection

**SE05T2C02GK**

### SOT-23 Package Outline & Dimensions

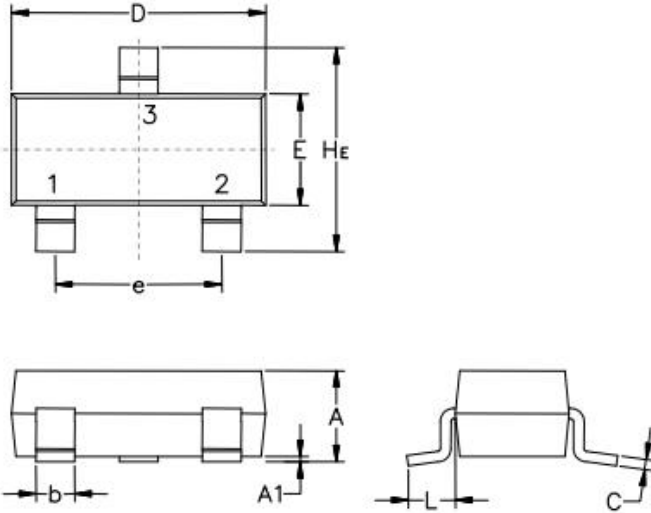

Symbol	Millimeters		
	Min.	Nom.	Max.
A	0.89	1.00	1.11
A1	0.01	0.06	0.10
b	0.37	0.44	0.50
c	0.09	0.13	0.18
D	2.80	2.90	3.04
E	1.20	1.30	1.40
e	1.78	1.90	2.04
L	0.35	0.54	0.69
H <sub>E</sub>	2.10	2.40	2.64

### Warning



- ◆ SOCAY owns the rights to a number of patents, trademarks, copyrights, trade secrets, and other intellectual property.
- ◆ SOCAY reserves the right to make changes without further notice to any products herein.
- ◆ SOCAY makes no warranties, representations or warranties as to the fitness of its products for any particular purpose, and disclaims any liability.
- ◆ The parameters provided in the SOCAY datasheet specification may vary from application to application, and the actual performance may vary over time. All operating parameters must be verified by the customer's technical expert before application.
- ◆ Any and all responsibilities and liabilities are disclaimed if any item under this notice of warning is not complied with.