

# MPB19-XXXXXX-XX

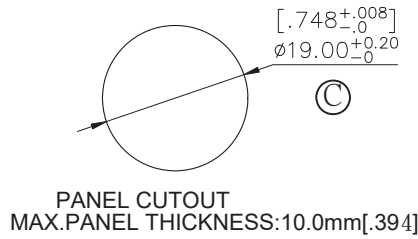
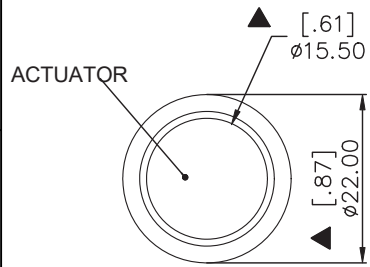

Body type

A0	Stainless (Natural)
C3	Al alloy (Black Anodized)

Button type

F	Flat
---	------

Contact Configuration

1	1NO 1NC
2	2NO 2NC

Operating type

0	Momentary
1	LOCK

Light type

0	Without LED
---	-------------

Terminal plating

Q	Silver
R	Gold

Terminal shape

J	Solder Terminal
---	-----------------

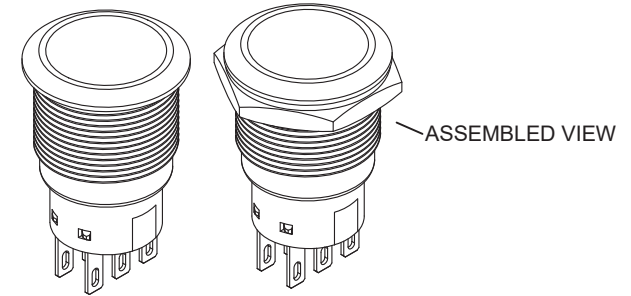
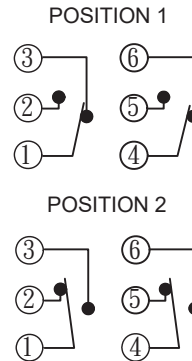
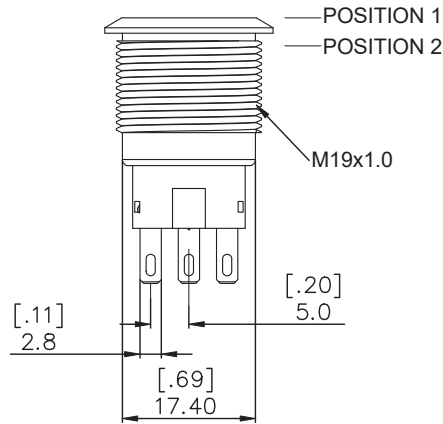
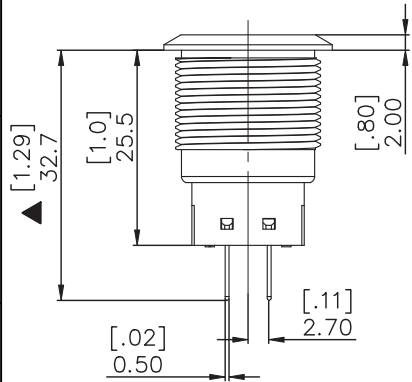

## SPECIFICATIONS

- CONTACT MATERIAL: Brass, coin silver, silver plated.
- RATING: 1th 5A/250VAC. resistive load 3A/250VAC.
- ELECTRICAL LIFE: 50,000 MAKE-AND-BREAK CYCLES AT FULL LOAD.
- MECHANICAL LIFE: Momentary 1,000,000.
- INSULATION RESISTANCE: 1,000MΩ MIN AT 500VDC .
- DIELECTRIC STRENGTH: 2,000V RMS@sea level.
- CONTACT RESISTANCE: 50mΩ MAX.@1A 12VDC(initial value).
- OPERATING TEMPERATURE: -20°C to 55°C .
- TRAVEL: ABOUT 3.2mm.
- OPERATION PRESSURE: 1Pole 2.5±1N. / 2Pole 3.5±1N.
- INGRESS PROTECTION: IP67,IK10(Stainless).
- TORQUE: 5~14Nm.

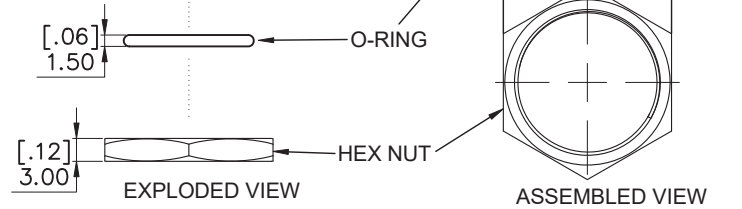
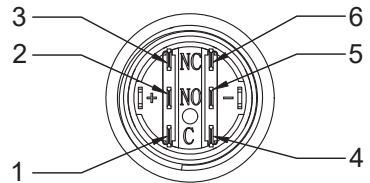

MATERIAL:  
 BUSHING: Stainless Steel.  
 BASE: PBT(UL 94-V0) , PC(UL 94-V2)  
 ACTUATOR: Stainless Steel.  
 INNER ASSEMBLY: POM/PA66.  
 SPRING: Spring steel.  
 SEALING: Silicone.  
 O-Ring: Silicone.  
 TERMINAL: Brass, Silver plated.  
 HEX NUT: Nickel plated brass.  
 RoHS



蘇州寰立電子有限公司  
 HUANLI ELECTRONICS CO., LTD.

△			
△			
△			
△			
△			
SYM	DISCIPTION	DATE	APPROVED

TOLERANCES UNLESS OTHERWISE SPECIFIED LINEAR: ±0.30 ANGULAR: ±3'		SIGNATURES		DATE	TITLE
REVISIONS		DRAWN		2016.08.18	METAL PUSHBUTTON SWITCH
A		CHK'D		2016.08.18	NO.
		APPV'D		2016.08.18	MPB19-A0F200-JQ