

RoHS

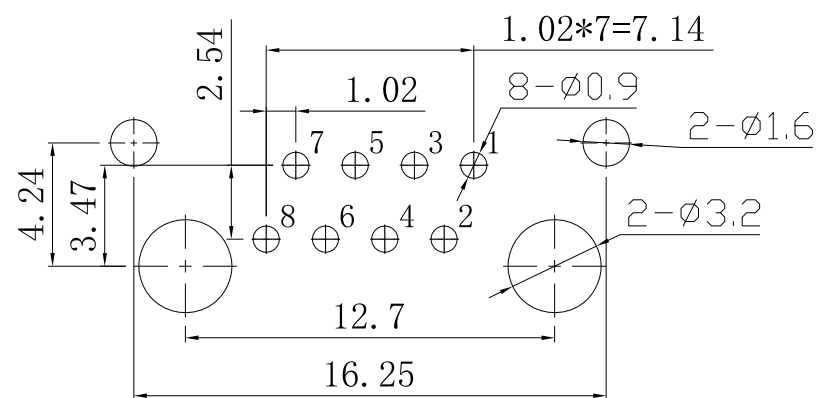

PC Board Layout

- NOTES:
ELECTRICAL:
1. VOLTAGE RATING: 125V AC.
2. CURRENT RATING: 1.5A.
3. CONTACT RESISTANCE: 30 mΩ MAX.
4. INSULATION RESISTANCE: 500 MΩ MIN @ 500V DC.
5. DIELECTRIC STRENGTH: 1000V AC 50Hz or 60Hz, 1MIN.
MECHANICAL:
1. INSERT MATERIAL: UL94V-0.
2. CONTACT MATERIAL: DIAMETER 0.46mm C51000(QSn4-0.3)PHOSPHOR BRONZE GOLD PLATING OVER NICKEL.
3. SHIELD: 0.20mm THICKNESS H65Y BRASS NICKEL PLATED.
4. MATING/UNMATING FORCE: 2.2KG.F MAX.
5. RETENTION STRENGTH: 5.0KG.F MIN BETWEEN JACK AND PLUG.
6. OPERATING LIFE: 750 CYCLES MIN.
ENVIRONMENTAL:
1. STORAGE: -40°C ~ +85°C RELATIVE HUMIDITY<70%.
2. OPERATION: -40°C ~ +85°C.

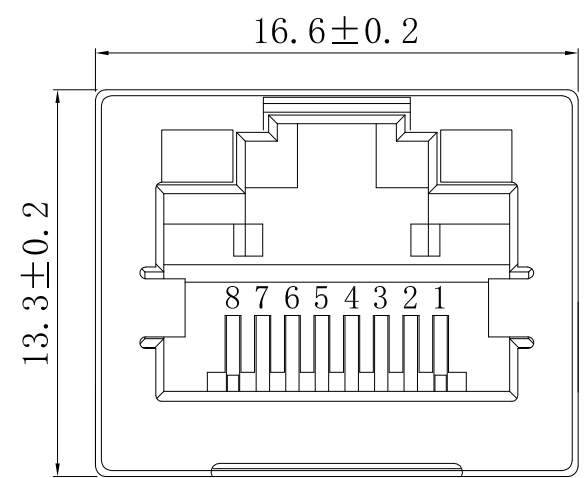
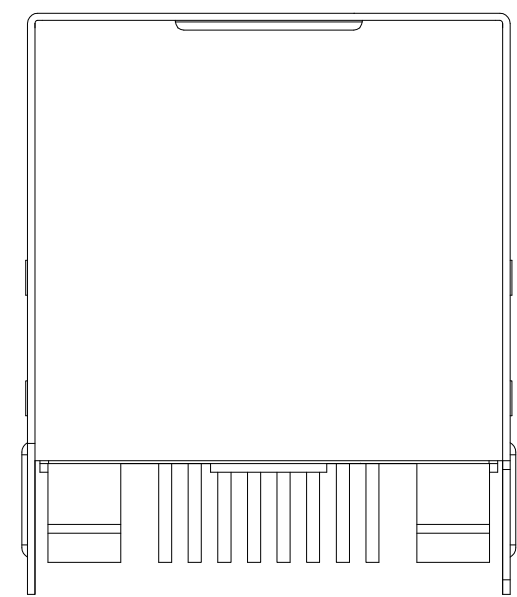
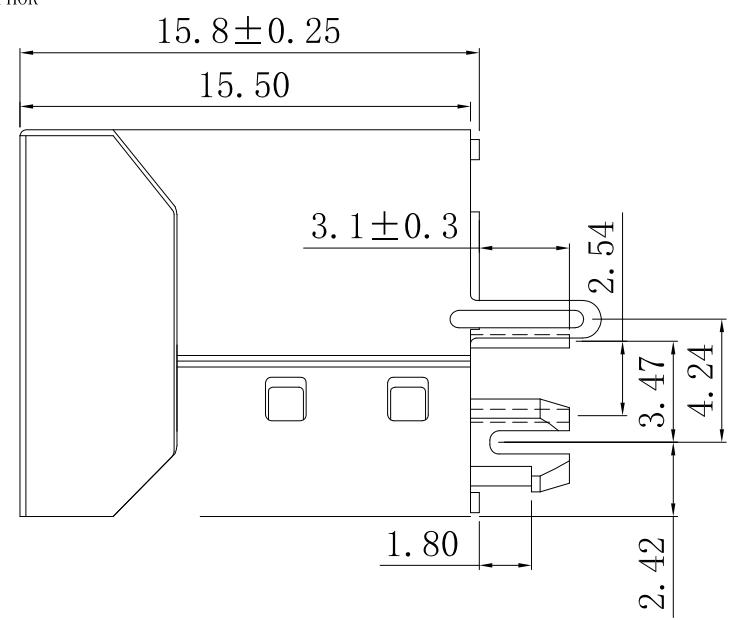

		Tolerances		Tel	021-52060235	FLY_CORE	上海飞芯电子科技有限公司		
				Fax	021-34711533				
		.X	±0.25	Draw	Hongqiwu	Name	5224S 1X1 8P8C B4.24 超薄型		
		.XX	±0.20	Ch'k		Type	Figure Number		
A0	First edition	2019.12.26	.XXX	±0.10	App'd				
REV	Change Description	Date	Angle	±3°	Units: mm	Mt'l: (Attach)	View:		Scale: 1:1