

## Full Metal Hoods

## DTZF-RG+High Density D-Sub Solder

### TECHNICAL SPECIFICATIONS

#### D-Sub Hood:

Material: Zinc, Nickel Plated  
 Operating Temperature: -45°C to + 105°C  
 Cable Entry: Top Entry  
 Thumbscrews: UNC 4-40 (Standard)

#### Cable O.D - Standard:

9-Way: Up to 6,5mm with grommet - 9,5mm without grommet  
 15-Way: Up to 6,5mm with grommet - 12,5mm without grommet  
 25-Way: Up to 8.0mm with grommet - 12,5mm without grommet  
 37-Way: Up to 9.0mm with grommet - 15,0mm without grommet

#### High Density D-Sub Solder Cup:

Insulator: Glass filled TP, UL94 V-0  
 Shell: Steel, Tin Plated  
 Contact pins: Copper Alloy  
 Stamped & Formed Pins: Class 3, 100 inserts min.  
 Contact Plating: Gold flash over Nickel  
 Operating Temperature: -55°C to +85°C  
 Withstanding voltage: >1000V Rms to 50 Hz for 1 minute  
 Current Rating: 3A  
 Insulator resistance: >5000MΩ min.

#### Features:

- Available in sizes HD15-26-44-62
- Excellent EMI Shielding
- Re-openable
- Spring-Clip mounted Jackscrews

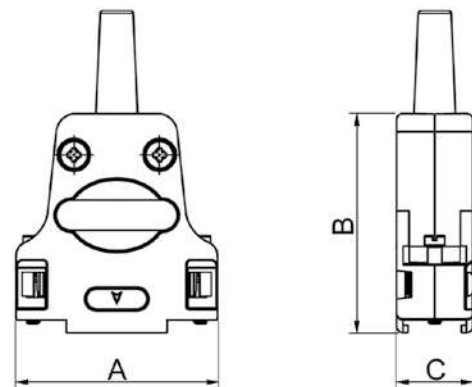

| Size DTZF | Dim A | Dim B | Dim C |
|-----------|-------|-------|-------|
| 9-way     | 31,6  | 39,5  | 15,2  |
| 15-way    | 40,0  | 41,0  | 15,2  |
| 25-way    | 53,7  | 47,5  | 15,2  |
| 37-way    | 70,2  | 48,0  | 15,2  |

### Ordering information:

### High Density D-Sub Connector Kits

| Size: | P/N - Kitted:           | Description:        |
|-------|-------------------------|---------------------|
| HD 15 | L17DTZF09-RG+L717HDE15P | Solder Cup, 15-Male |
| HD 26 | L17DTZF15-RG+L717HDA26P | Solder Cup, 26-Male |
| HD 44 | L17DTZF25-RG+L717HDB44P | Solder Cup, 44-Male |
| HD 62 | L17DTZF37-RG+L717HDC62P | Solder Cup, 62-Male |

| Size: | P/N - Kitted:          | Description:          |
|-------|------------------------|-----------------------|
| HD 15 | L17DTZF09-RG+L77HDE15S | Solder Cup, 15-Female |
| HD 26 | L17DTZF15-RG+L77HDA26S | Solder Cup, 26-Female |
| HD 44 | L17DTZF25-RG+L77HDB44S | Solder Cup, 44-Female |
| HD 62 | L17DTZF37-RG+L77HDC62S | Solder Cup, 62-Female |