



## Audio/Video Connectors, Pro-AV USB Coupler

iSTATION™ System 1.5U  
Integration.

Pro-AV Style Mounting.

USB 2.0 (480 Mbps)  
Performance.

A to B or B to A Reversible.

A to B or B to A  
reversible coupler.

Quick and easy  
installation.



Universally accepted standard  
Pro-AV panel mount housing.

Ideal for audio networking and  
integration of computer based  
equipment into audio systems.

### SPECIFICATIONS

- ◆ **Connector Type:** 2.0
- ◆ **Performance:** 480 Mbps
- ◆ **Electrical:**
  - Contact resistance: < 30 mΩ (mated pair).
  - Dielectric strength: 0,5 kVdc (1 min) Insulation resistance: > 1 GΩ.
  - Rated current per contact: 1.5 A.
  - Rated voltage: < 30 V ac.
- ◆ **Mechanical:**
  - Insertion force: < 35 N.
  - Withdrawal force: > 10 N.
  - Lifetime: > 1500 mating cycles.
- ◆ **Material:**
  - Contact plating: Gold.
  - Contacts: CuZn36.
  - Insert: Polyamide (PA 6).
  - Shell: Zinc diecast (ZnAl4Cu1).
  - Shell plating: Black chromium.
- ◆ **Environmental:**
  - Flammability: UL 94 V-0.
  - Temperature range: -25 °C to +85 °C.
- ◆ **Type:**
  - Standard A and B footprint.

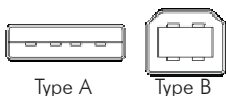

Type A

Type B

### CABLE TERMINATION

**Cable Type:** Standard USB A and B patch cord connections.

Distance: USB maximum connection length may not exceed 5 meters, non-active. With amplification follow manufacturer's specifications.

### CONNECTOR TERM

**Universal Serial Bus (USB)** is a serial bus standard to interface devices. It was originally designed for personal computers, but it has become commonplace on scanners, printers, handheld devices such as portable memory devices, video game consoles, PDAs and portable media players.

### APPLICATIONS SUPPORTED

- ▲ Connecting Peripherals to a Computer(s):
  - KVM - Keyboard and mouse devices.
  - Printers, scanners.
  - External storage, networking components.
  - PDAs, phones, MP3 players, gamepads and joysticks.
  - Digital voice recorders, digital cameras and video recorders.

### INSTALLATION TIPS

**Important:** Always allow for clearance behind connection location to ensure proper bend radius and patch cord connector depth.

## AV Connector, Pro-AV USB



Qty. \_\_\_\_\_ Catalog No. \_\_\_\_\_  
 10-pack **USB10**

## AV Modules, Pro-AV Blank

Description \_\_\_\_\_ Catalog No. \_\_\_\_\_  
 Pro-AV Blank, Unloaded, 1.5 Unit, 10-pk **IMAVB15XX**

## XX = Housing Colors

"AL" = Almond; "BK" = Black; "EI" = Electric Ivory; "GY" = Gray;  
 "LA" = Light Almond; "OW" = Office White; "W" = White.

## DIMENSIONS

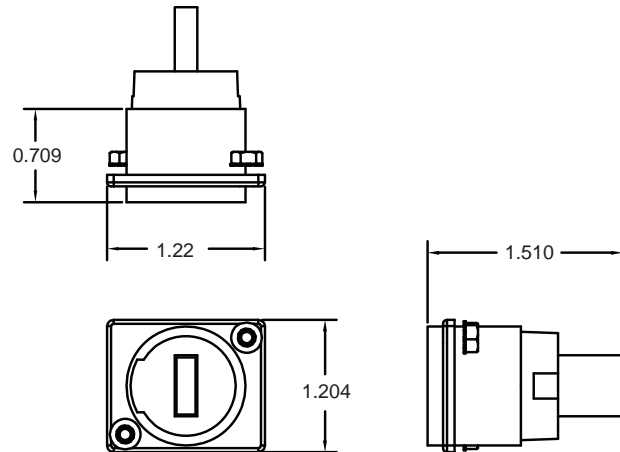

## CONNECTOR DEPTH CHART

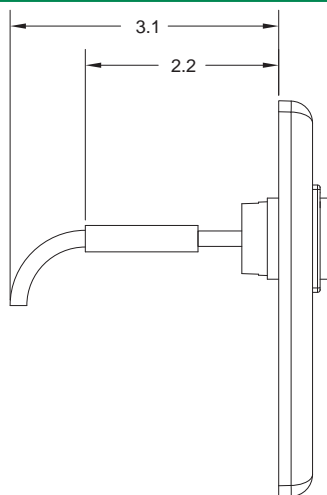

## iSTATION™ COMPATIBLE

## Work Station and Cross-Connect Solutions

- iSTATION™ Front-loading Plates
- Decorator Frames
- iSTATION™ UDX Multimedia Panels
- iFRAME® Vertical Patch Panel

## Hubbell Delivery Systems

- Hubbell SystemOne Poke-Throughs and Floor Boxes
- Hubbell Surface Raceway, Metal and Non-Metallic
- Multi-Connect™ Wall Boxes/Conference Table Boxes



## TYPICAL APPLICATIONS

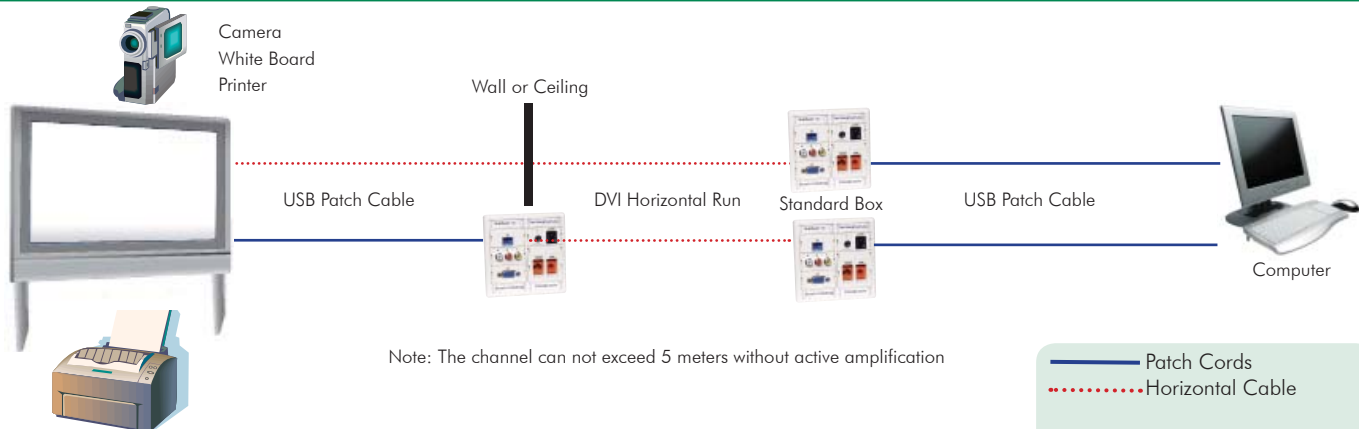

— Patch Cords  
 ..... Horizontal Cable



Pro-AV, USB Connector in Hubbell iSTATION™ face plate.



## Hubbell Premise Wiring

HUBBELL INCORPORATED (Delaware)  
 14 Lord's Hill Road • Stonington, CT 06378-0901 • (860) 535-8326 • 800-626-0005  
 Fax: (860) 535-8328 • Internet site: <http://www.hubbell-premise.com>

## Worldwide Locations

Hubbell Premise Wiring, Asia Pacific  
 Hubbell Canada Inc.  
 Hubbell Premise Wiring, Central America  
 Hubbell Premise Wiring, China  
 Hubbell Premise Wiring, Europe  
 Hubbell Premise Wiring, India  
 Hubbell Int'l. Inc., Korea Branch

852-2836-7131  
 905-839-1138  
 506-309-4158  
 86-21-6374 2660  
 44-01283 500500  
 91-80-4022-4089  
 (82 2) 2607 1363

Fax: 852-2836-7132  
 Fax: 905-839-9108  
 Fax: 506-260-1616  
 Fax: 86-21-6374 2799  
 Fax: 44-01283 500400  
 Fax: 91-80-4022-4033  
 Fax: (82 2) 2603 7386

Hubbell Premise Wiring, Latin America  
 Hubbell de Mexico, S.A. de C.V.  
 Hubbell Premise Wiring, Middle East  
 Hubbell Premise Wiring, Puerto Rico  
 Hubbell-Taian Co., Ltd., Taiwan  
 Hubbell Premise Wiring, Venezuela

305-408-4501  
 (5255) 9151-9999  
 971-4-393-4192  
 787-855-1075  
 886-2-2522-1862  
 58-212-5156482

Fax: 305-408-8201  
 Fax: (5255) 9151-9989  
 Fax: 971-4-393-4194  
 Fax: 787-855-3265  
 Fax: 886-2-2522-1872  
 Fax: 58-212-6627258