

## Electronic housing - UEGM 40/2 BK OHNE LOGO - 2792468

Please be informed that the data shown in this PDF Document is generated from our Online Catalog. Please find the complete data in the user's documentation. Our General Terms of Use for Downloads are valid (<http://phoenixcontact.com/download>)



Electronic housing, fully equipped with 6 screw connections per side for two PCBs

The illustration shows a green version



### Key Commercial Data

Packing unit	1 pc
Weight per Piece (excluding packing)	79.94 g
Custom tariff number	85369010
Country of origin	Germany

### Technical data

#### General

Housing type	Component housing
Housing material	Polyamide (PA 6.6)
Color	black

#### Ambient conditions

Ambient temperature (operation)	-40 °C ... 105 °C
---------------------------------	-------------------

#### Dimensions

Length	79 mm
Width	40 mm

#### Technical data

Connection in acc. with standard	CUL
Nominal voltage $U_N$	300 V
Nominal current $I_N$	10 A
AWG/kcmil	30-12

## Electronic housing - UEGM 40/2 BK OHNE LOGO - 2792468

### Technical data

#### Technical data

Indicator1	CUL1
Flammability rating according to UL 94	V0
Number of positions	12

#### Standards and Regulations

Connection in acc. with standard	CUL
Flammability rating according to UL 94	V0

### Classifications

#### eCl@ss

eCl@ss 4.0	27180401
eCl@ss 4.1	27180401
eCl@ss 5.0	27180506
eCl@ss 5.1	27180506
eCl@ss 6.0	27180802
eCl@ss 7.0	27182702
eCl@ss 8.0	27182702
eCl@ss 9.0	27182702

#### ETIM

ETIM 2.0	EC001031
ETIM 3.0	EC001031
ETIM 4.0	EC001031
ETIM 5.0	EC001031

#### UNSPSC

UNSPSC 6.01	31261501
UNSPSC 7.0901	31261501
UNSPSC 11	31261501
UNSPSC 12.01	31261501
UNSPSC 13.2	31261501

### Approvals

#### Approvals

---

# Electronic housing - UEGM 40/2 BK OHNE LOGO - 2792468

## Approvals

Approvals

UL Recognized / EAC / cULus Recognized

Ex Approvals

Approvals submitted

## Approval details

UL Recognized 
-------------------------------------------------------------------------------------------------

EAC
-----

cULus Recognized	
mm²/AWG/kcmil	30-12
Nominal current I <sub>N</sub>	10 A
Nominal voltage U <sub>N</sub>	300 V

## Drawings

Explosion drawing

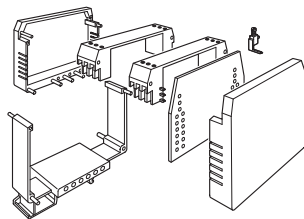

Dimensional drawing

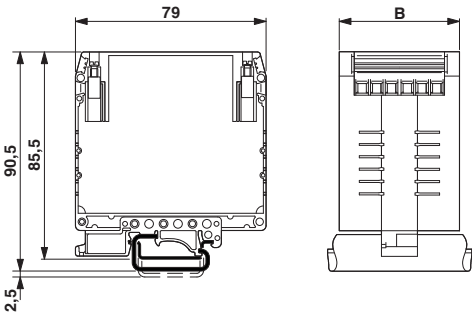

## Electronic housing - UEGM 40/2 BK OHNE LOGO - 2792468

Dimensional drawing

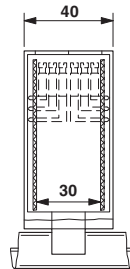

Dimensional drawing

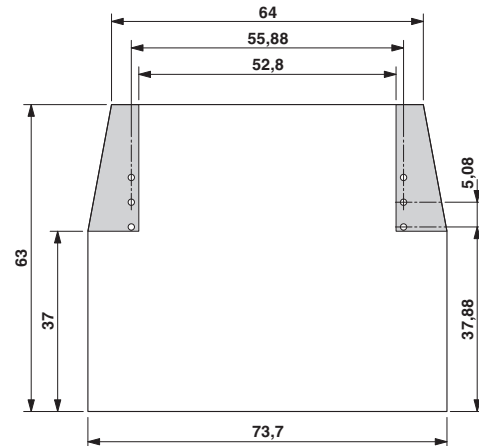

Schematic diagram

