

# Housing screw connection - SACC-FP-F-M12-THR PP - 1027678

Please be informed that the data shown in this PDF Document is generated from our Online Catalog. Please find the complete data in the user's documentation. Our General Terms of Use for Downloads are valid (<http://phoenixcontact.com/download>)



Housing screw connection, Socket, M12-Push-Pull, Front mounting, THR- und Wellenlötkontakte

## Why buy this product

- ✓ Manufacturer-independent M12 push-pull locking system for maximum availability
- ✓ Easy and quick cabling of devices and systems in hard-to-reach areas
- ✓ Easy device integration, thanks to mechanical port screw connections with threaded fastening
- ✓ Flexible PCB assembly: two-piece connectors for wave and THR soldering

## Key Commercial Data

Packing unit	10 STK
Minimum order quantity	10 STK
GTIN	
GTIN	4055626533933
Weight per Piece (excluding packing)	9.640 g
Custom tariff number	79070000
Country of origin	Germany
Note	Made to Order (non-returnable)

## Technical data

### Ambient conditions

Ambient temperature (operation)	-25 °C ... 85 °C (Plug / socket)
	-40 °C ... 85 °C (without mechanical actuation)
Degree of protection	IP67 (correctly plugged in and locked)

### General

Note	The electrical and mechanical data specified assume that the connector pair is correctly locked and mounted. If the connector is unlocked and if there is a danger of contamination, the connector must be sealed using
------	---

# Housing screw connection - SACC-FP-F-M12-THR PP - 1027678

## Technical data

### General

	a protective cap > IP54. Influences arising from litz wires, cables or PCB assembly must also be taken into consideration.
Standards/regulations	M12 connector In line with
Connection method	THR- und Wellenlötkontakte
Insertion/withdrawal cycles	> 100
Torque	1.5 Nm ... 2 Nm (Installation-side)
Mounting type	Front mounting

### Material

Material of grip body	Nickel-plated brass
Material, knurls	Nickel-plated brass
Material	Brass, nickel-plated
Sealing material	FKM

### Cable

Standards/specifications	M12 connector In line with
--------------------------	----------------------------

### Standards and Regulations

Standard designation	M12 connector
----------------------	---------------

### Environmental Product Compliance

China RoHS	Environmentally Friendly Use Period = 50
	For details about hazardous substances go to tab "Downloads", Category "Manufacturer's declaration"

## Drawings

### Dimensional drawing

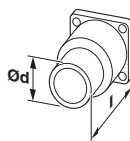

Dimensional drawings can be found under Downloads

## Classifications

### eCl@ss

eCl@ss 8.0	27440103
eCl@ss 9.0	27440103

### ETIM

ETIM 6.0	EC002061
----------	----------

