

Panel-mount Socket LB-I4R-B

Insulated, Ø 4 mm, rigid. Rolled brass sheet.

The socket can be screw-mounted in pre-drilled panels.

Solder connection.

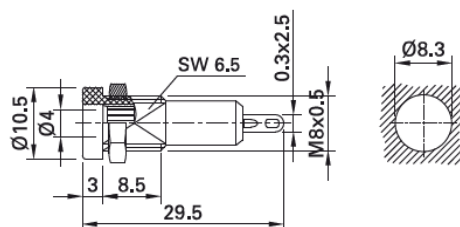

Order No.	Type	Rated voltage/current		*Colors
23.0450-*	LB-I4R-B	30 VAC / 25 A 60 VDC / 25 A	Ni	21 22 23 24 25 29

Component parts

23.8111-*	BI-LB-I4R-B	Socket without nut
Page 68	MU/M8x0,5	Hexagonal Nuts