

SERIES 04JT Joystick with Tactile Feel

FEATURES

- Dynamically sealed against contamination to IP67 when properly mounted
- Available in front panel mount
- RoHS compliant
- High life (250,000 Operational Cycles)
- Short behind panel length (0.689")

DESCRIPTION

Series 04JT is a single pole, 4-way toggle switch with a tactile feel. 4-way contact is made in the opposite direction of travel.



DIMENSIONS in inches (and millimeters)

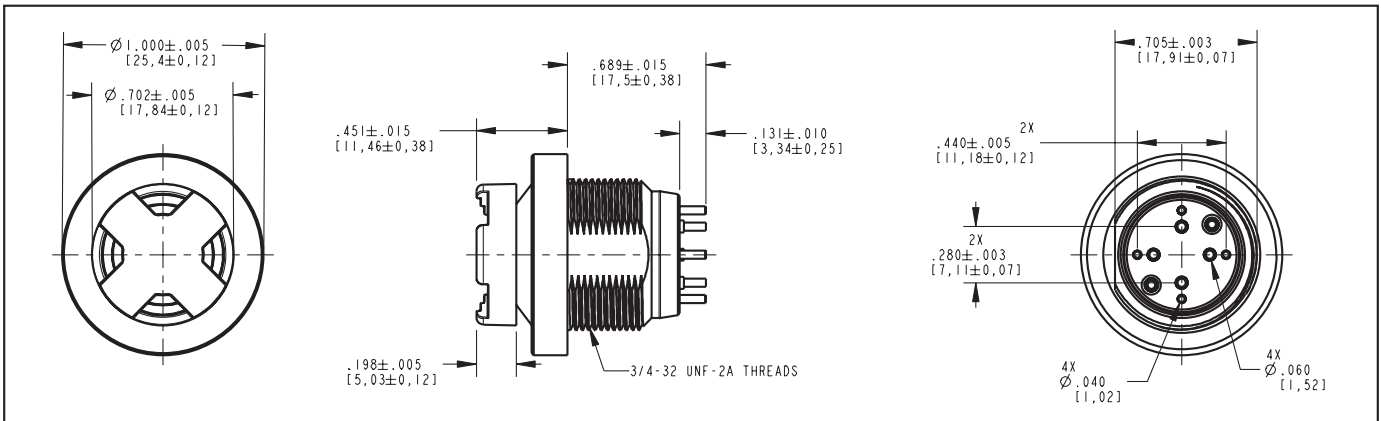

Joysticks

ELECTRIC & MECHANICAL RATINGS

- Lower Level Rating:** 10mA @ 5V resistive
- Contact Resistance:** 50m ohms (max)
- Operating Temperature:** -55°C to +85°C
- Operational Life:** 250,000 cycles
- Insulation Resistance:** 10,000M ohms
- Toggle Lever Travel:** 12° from center (max)
- Toggle Operating Force:** 16 oz ± 6 oz initial
- Toggle Pivot & Stop Strength:** 25 lbs. (max)
- Mechanical Shock:** per MIL-STD-810,

- procedure I, method 516.4
- Immersion:** per MIL-PRF-8805, sealed to IP67
- Moisture Resistance:** per MIL-DTL-9419
- Vibration:** per MIL-DTL-9419G, Method 4.7.11
- Terminal Strength:** Over 30 lbs. for 1 minute, per MIL-DTL-9419G, Paragraph 4.7.6
- Altitude:** Up to 60,000 ft per MIL-DTL-9419G, Paragraph 4.7.16
- Solderability:** per MIL-DTL-9419G, Paragraph 4.7.19

MATERIALS & FINISHES

- Cap:** Thermoplastic (black, cone-shaped cap is gray)
- Bushing:** Aluminum alloy (black chrome finish)
- Contact Terminals:** 1/2 hard brass (gold over silver over nickel plating)
- Hex Nut:** Aluminum alloy (black chrome finish)
- O-Ring:** 50 durometer fluorosilicone

ORDERING INFORMATION

Available from your local Grayhill Distributor.

For prices and discounts, contact a local sales office, an authorized local distributor or Grayhill.

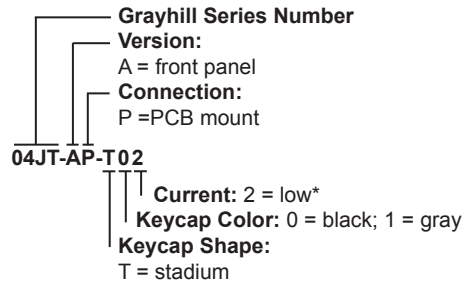

* Low Level signal is defined as a very small electrical load (i.e., 10 milliamps at 5 volts)

CIRCUITRY

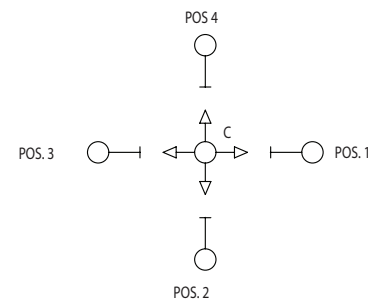

* Contact made opposite direction of travel