

REV.	ECRN NO./DESCRIPTION	DATE	DRAWN	CHECKED	APPROVE
1	SN14155	11/15/14	LXH	Vld	Barney
1A	SN15***	08/28/15	Jinjin.Tu	Vld	Barney
1B	SN18***	03/22/16	Jinjin.Tu	Vld	Barney

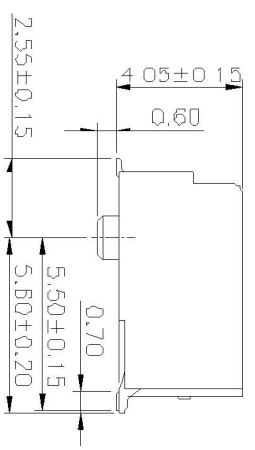

GENERAL TOLERANCES UNLESS SPECIFIED		PART NO.	
X ±	0.35	X ±	APCI0105-P00*A
XX ±	0.25	XX ±	APPROVED BY
XXX ±	0.15	XXX ±	Barney
CUSTOMER DRAWINGS		CHECKED BY	
		Vld	
SIZE	UNITS	DRAWN BY	
A4	MM [INCH]	LXH	
TITLE		DWG. NO.	
0.5 PITCH M.2 H4.2 (KEY B)		AP-APCI0105	
SHEET		SCALE	
1 / 5		4:1	
REV			
1B			

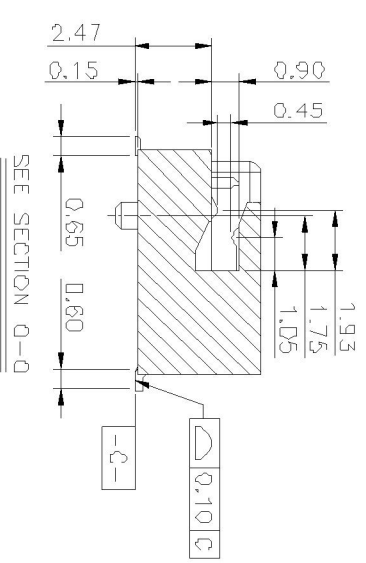
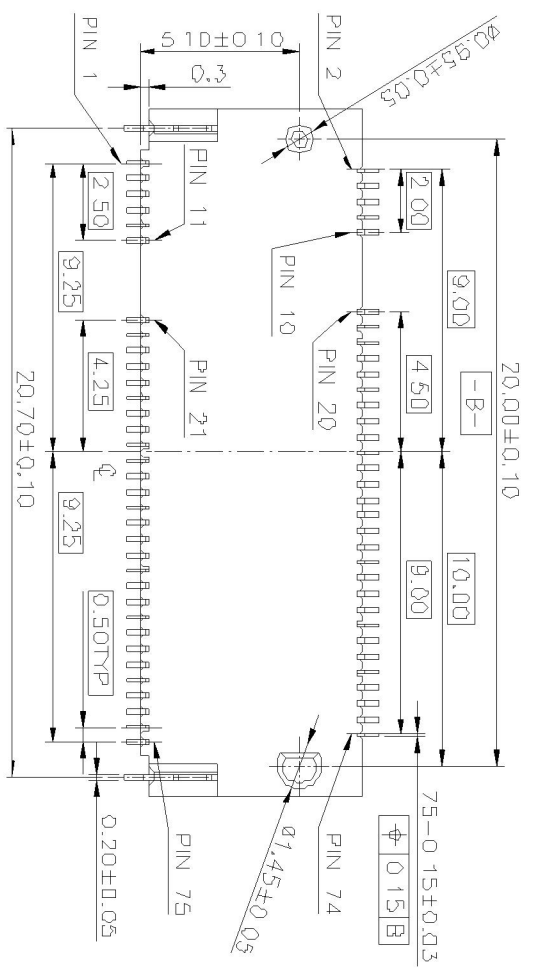
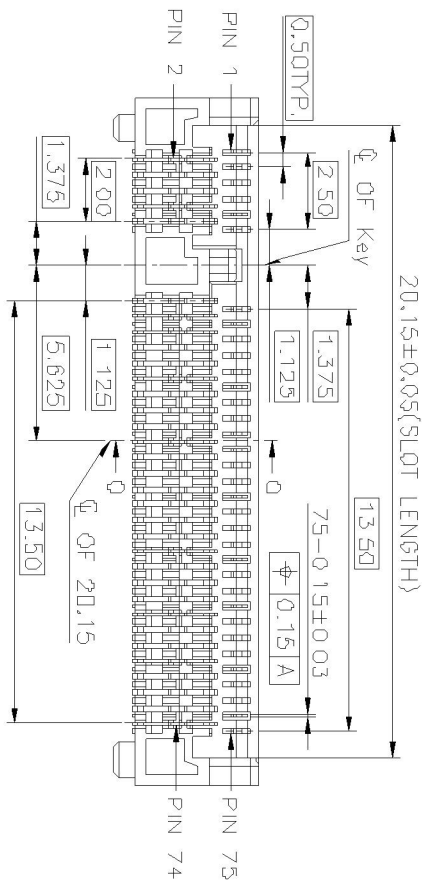
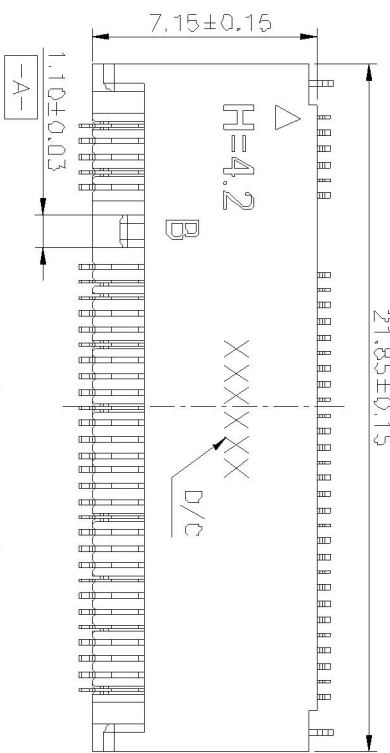

A B C D E F 1 2 3 4 5 6 7 8

NO.	PART NO.	DESCRIPTION	DURABILITY
1	APCI0105-P001A	GOLD G/F ON CONTACT AREA	25 CYCLES
		GOLD G/F ON SOLDER AREA	
2	APCI0105-P002A	GOLD 10U" ON CONTACT AREA	25 CYCLES
		GOLD G/F ON SOLDER AREA	
3	APCI0105-P003A	GOLD 15U" ON CONTACT AREA	25 CYCLES
		GOLD G/F ON SOLDER AREA	
4	APCI0105-P004A	GOLD 30U" ON CONTACT AREA	60 CYCLES
		GOLD G/F ON SOLDER AREA	

TABLE

Notes:

1. MATERIAL SPECIFICATION:
  - 1.1 HOUSING: LCP+40%GF, UL94V-0, COLOR: BLACK.
  - 1.2 CONTACT: COPPER ALLOY C1065.
  - 1.3 PEG: STEEL.

2. PLATING SPECIFICATION:

- 2.1. CONTACT: 50U" MIN. NICKEL UNDER PLATING OVER ALL PLATING ON SOLDER AREA. SEE TABLE GOLD PLATING ON CONTACT AREA. SEE TABLE
- 2.2. PEG: 50U" MIN. NICKEL UNDER PLATING OVER ALL. 80U" MIN. MATTE TIN PLATING ON SOLDER AREA.

3. HF COMPLIANT, RPHS COMPLIANT

4. DATE CODE: XX XX XX



5. MECHANICAL PERFORMANCE:  
5.1. DURABILITY: SEE TABLE

6. ELECTRICAL PERFORMANCE:

- 6.1 CURRENT: 0.5A PER PIN
- 6.2 ILCR: INITIAL 55mΩ MAX ; FINAL ΔILCR=20mΩ MAX

7. IR REFLOW:

THE TEMPERATURE SHALL BE 260±5°C MAINTAINING 10±1 SECONDS.

8. PRODUCT NUMBER NOTE:

FINISHED PRODUCT

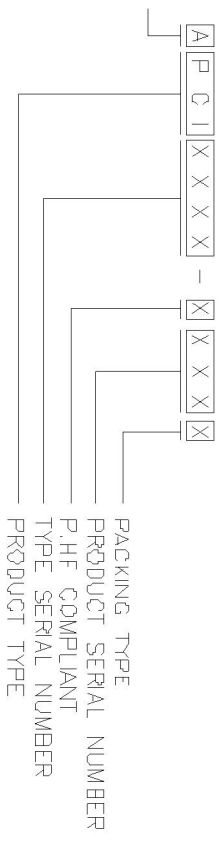

<b>GENERAL TOLERANCES UNLESS SPECIFIED</b> <del>X1</del> 0.35 <del>X2</del> 0.5 <del>X3</del> 0.75 <del>XX</del> ± 0.25 <del>XS</del> ± 0.15 <del>XX</del> ± 0.15 <del>XXX</del> ± 0.15 <del>XX</del> ± 0.15		<b>PART NO.</b> APCI0105-P00*A  <b>APPROVED BY</b> Barney  <b>TITLE</b> 0.5 PITCH M.2 H4.2 (KEY B)	
<b>CUSTOMER DRAWING</b>  <b>SIZE</b> A4 <b>UNIT\$</b> MM <b>DRAWN BY</b> Lxh	<b>CHECKED BY</b> Vico  <b>DWG NO.</b> AP-APCI0105	<b>SHEET</b> 2 / 5 <b>SCALE</b> 4:1 <b>REV</b> 1B	

Assembly stack height schematic diagram

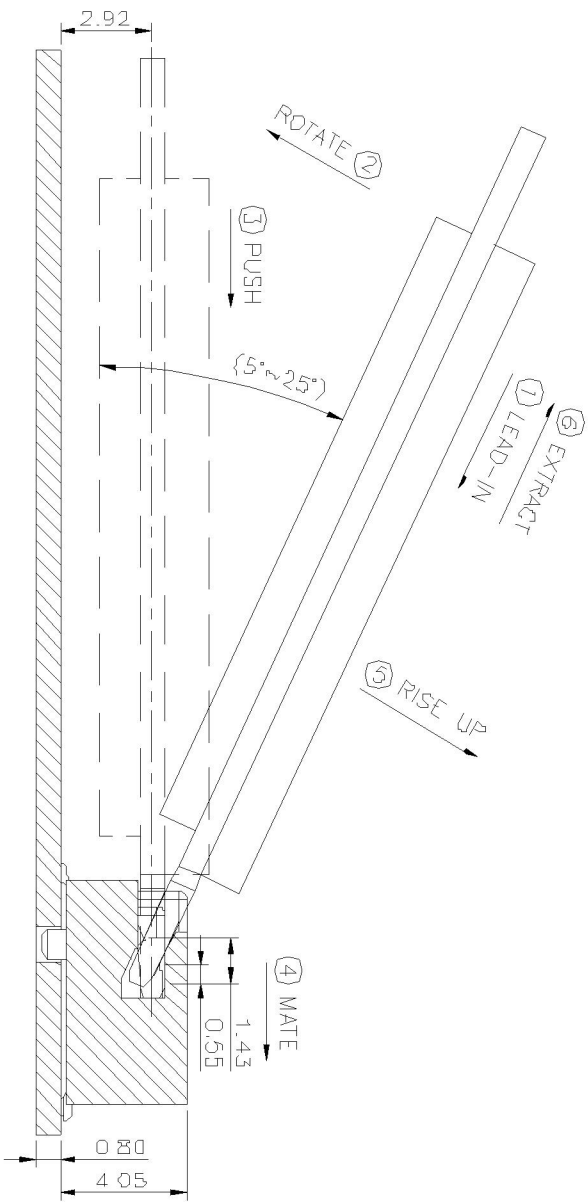
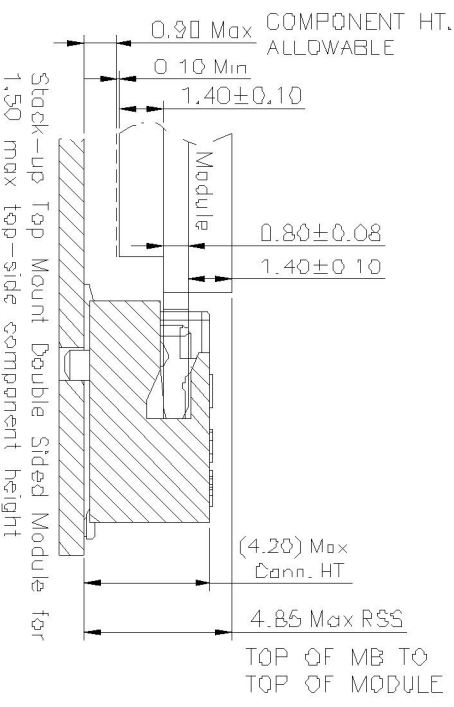
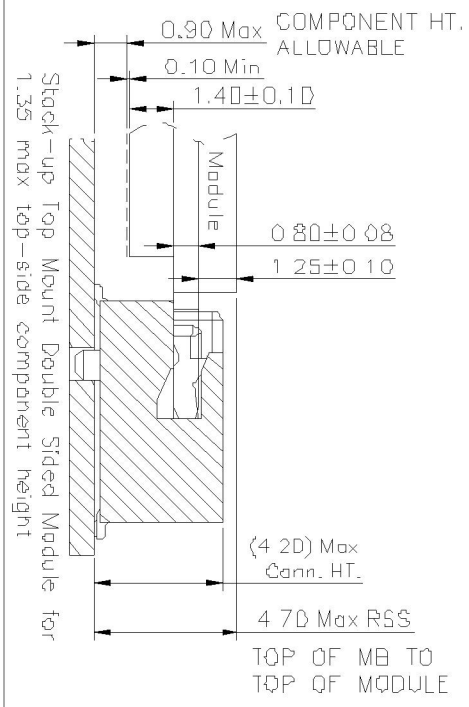
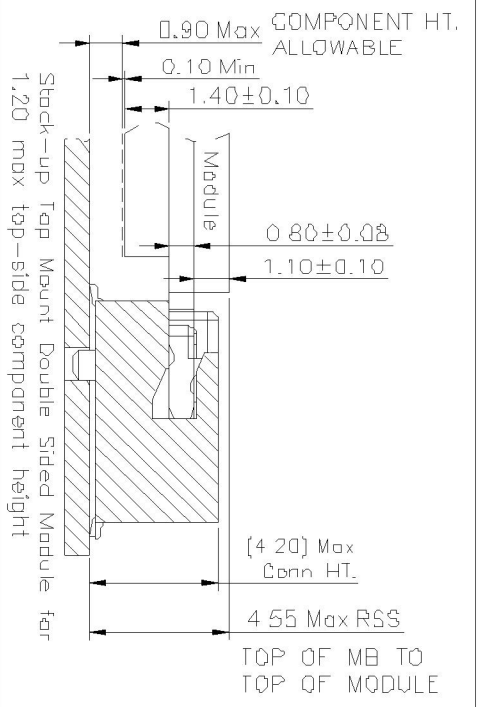

HOW TO MATE AND EXTRACT  
 MATE: ① → ④  
 EXTRACT: ⑤ → ⑥

NOTE: Mating force will generate from step 3 to step 4.

GENERAL TOLERANCES UNLESS SPECIFIED		PART NO.		TITLE
X1	0.36	X2	3"	
XX	0.25	X3	2"	APPROVED BY
XXX	0.15	XX*	1"	Barney
CUSTOMER DRAWING		CHECKED BY		DWG NO.
V16		V16		AP-APCI0105
SIZE	UNITS	DRAWN BY	SHEET SCALE REV	
A4	MM [INCH]	LXH	3 / 5	4:1 1B



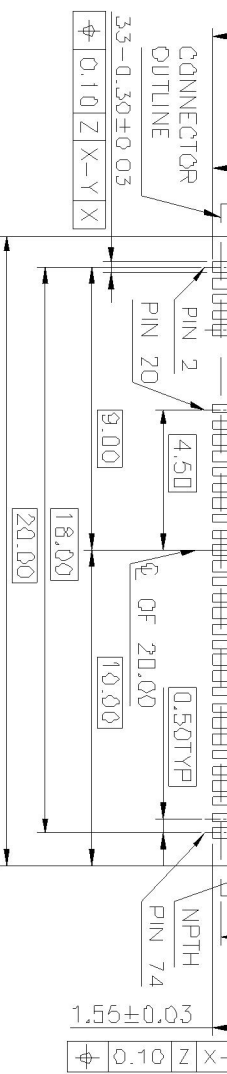
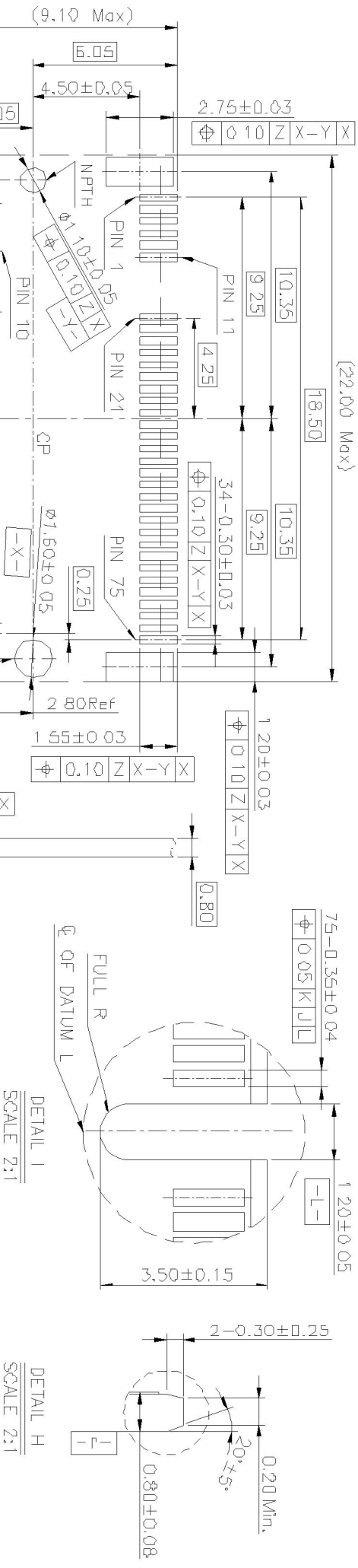
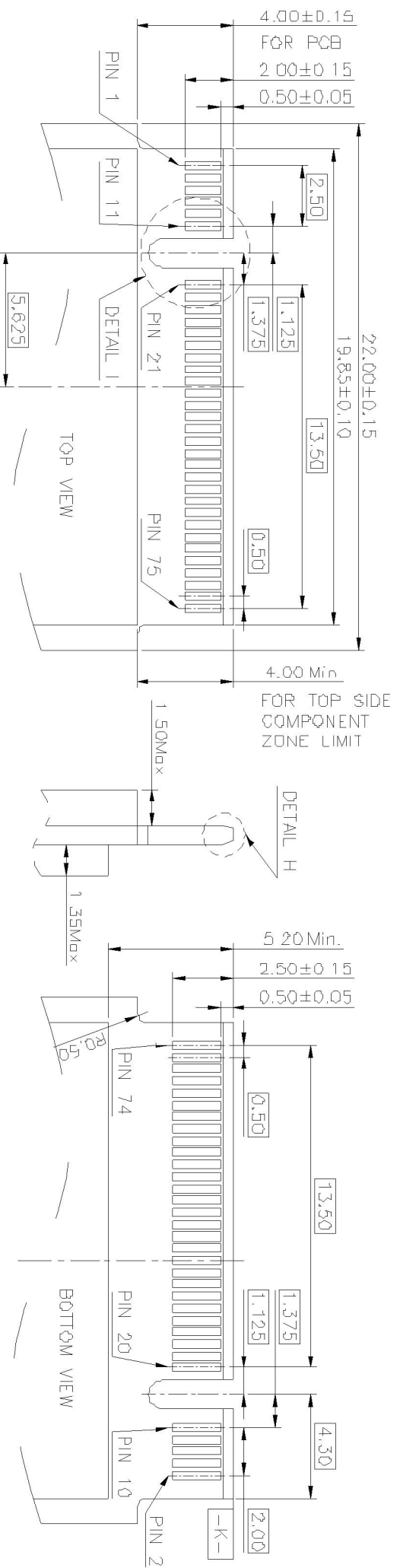

RECOMMENDED PCB LAYOUT (TOP VIEW)  
DEFAULT TOLERANCE ±0.05MM

GENERAL TOLERANCES UNLESS SPECIFIED		PART NO.		TITLE	
X1	0.35	X2	3°	APCI0105-P00*A	0.5 PITCH M 2 H 4.2 (KEY B)
XX ±	0.25	X3	2°	APPROVED BY	
XXX ±	0.15	XX ±	1°	Barney	
CUSTOMER DRAWING		CHECKED BY		DWG NO.	
Vito		Vito		AP-APCI0105	
SIZE	UNITS	DRAWN BY			
A4	MM [INCH]	Lkh			
SHEET SCALE		SHEET SCALE		REV	
4 / 5		4:1		1B	



Lian Xin Technology

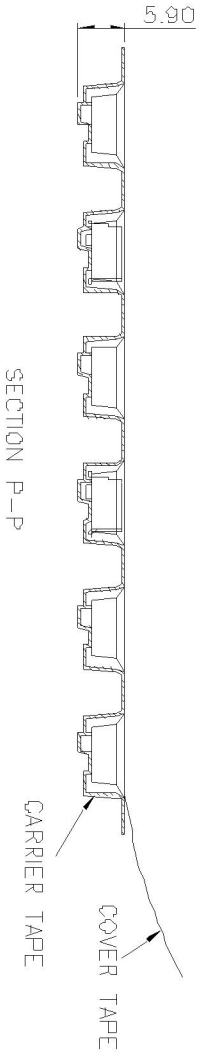
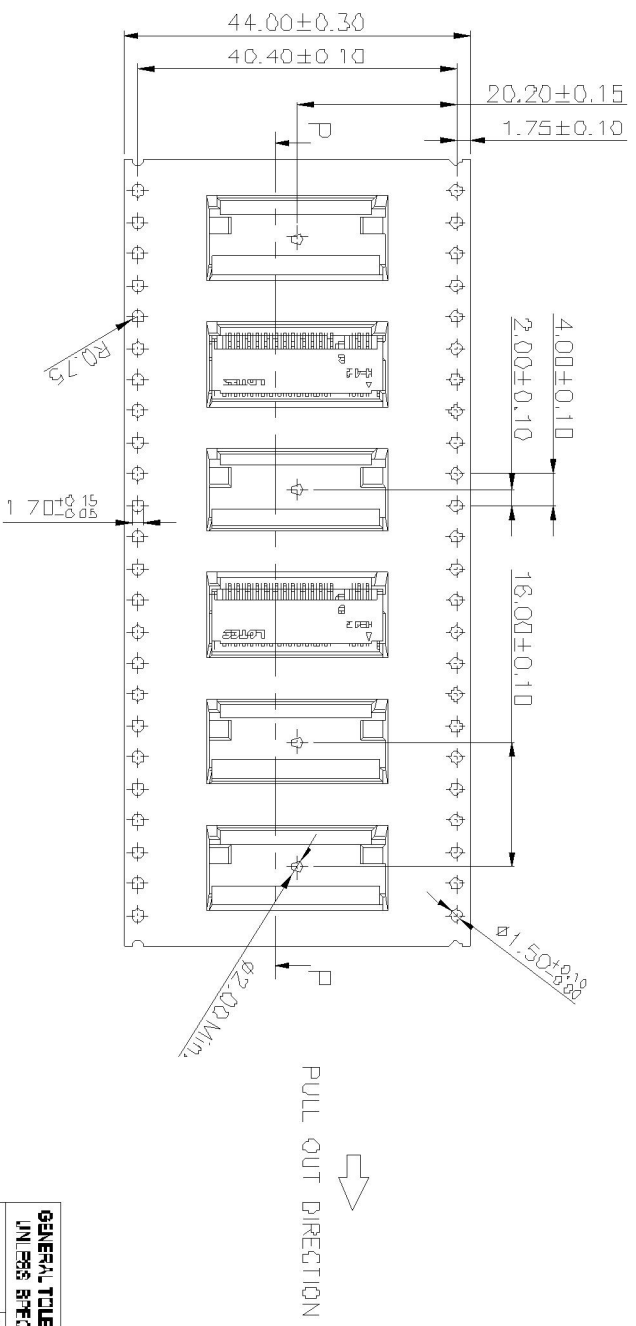
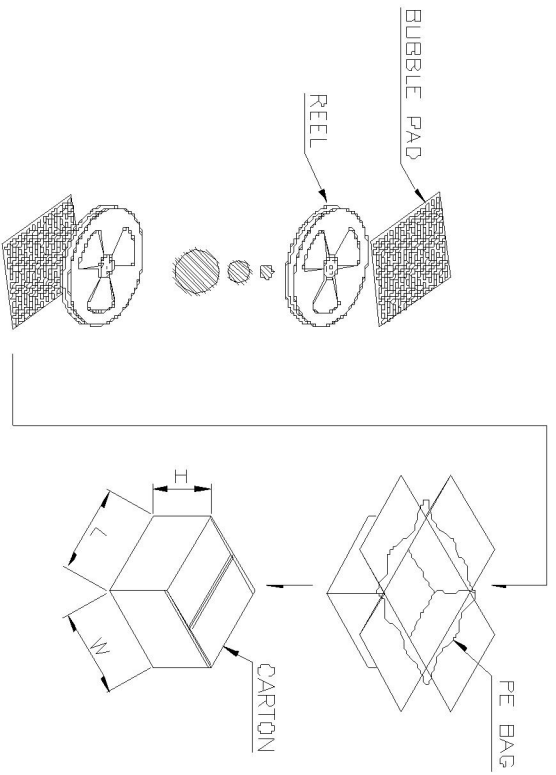
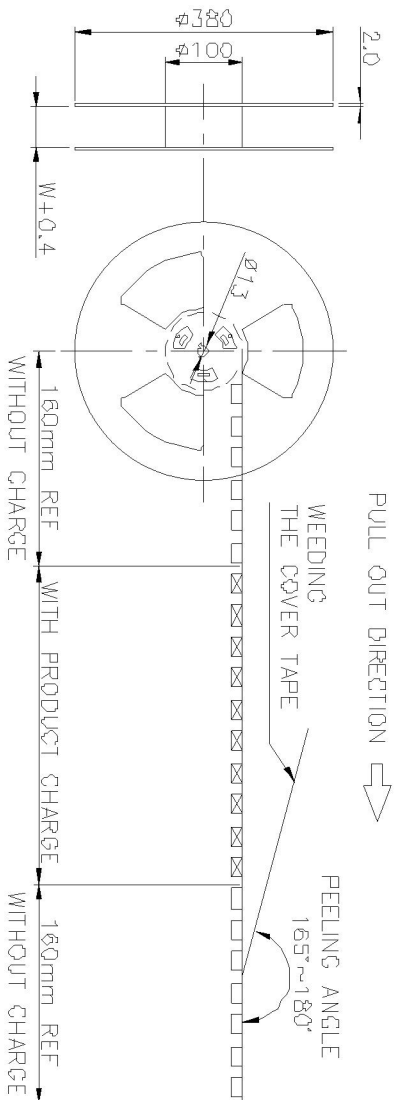

GENERAL TOLERANCES UNLESS SPECIFIED		PART NO.		TITLE	
X ±	0.30	X <sup>0+</sup>	3 <sup>+</sup>	APCI0105-P00*A	
XY ±	0.25	X <sup>0+</sup>	2 <sup>+</sup>	0.5 PITCH M2 H4.2 (KEY D)	
XXX ±	0.15	X <sup>0+</sup>	1 <sup>+</sup>	DWG NO.	
CUSTOMER DRAWING				CHECKED BY	AP-APCI0705
SIZE				DRAWN BY	SHEET SCALE REV
A4				LX1	5 / 5 1:1 1B

900 5400  
PCS/REEL PCS/CARTON

**连欣科技**  
Lian Xin Technology