

**Ordering number FP13028_LISA2-M-PIN**

Family	Lisa2	FWHM	26 degrees
Type	Assembly	Efficiency	89 %
LED	XT-E	cd/lm	3.260
Color	Black	Gerber File	Available
Diameter	9.9 mm		
Height	6.8 mm		
Style	Round		
Optic Material	PMMA		
Holder Material	PC		
Fastening	Pin, glue		
Status	On production		

Ordering number FP13030_LISA2-M-CLIP

Family	Lisa2	FWHM	26 degrees
Type	Assembly	Efficiency	89 %
LED	XT-E	cd/lm	3.260
Color	Black	Gerber File	Available
Diameter	9.9 mm		
Height	6.8 mm		
Style	Round		
Optic Material	PMMA		
Holder Material	PC		
Fastening	Clips, glue		
Status	On production		

Ordering number FP13025_LISA2-W-PIN

Family	Lisa2	FWHM	32 degrees
Type	Assembly	Efficiency	84 %
LED	XT-E	cd/lm	2.200
Color	Black	Gerber File	Available
Diameter	9.9 mm		
Height	6.8 mm		
Style	Round		
Optic Material	PMMA		
Holder Material	PC		
Fastening	Pin, glue		
Status	On production		

Ordering number FP13031_LISA2-W-CLIP

Family	Lisa2	FWHM	32 degrees
Type	Assembly	Efficiency	84 %
LED	XT-E	cd/lm	2.200
Color	Black	Gerber File	Available
Diameter	9.9 mm		
Height	6.8 mm		
Style	Round		
Optic Material	PMMA		
Holder Material	PC		
Fastening	Clips, glue		
Status	On production		

**Ordering number FP13026_LISA2-WW-PIN**

Family	Lisa2	FWHM	47 degrees
Type	Assembly	Efficiency	84 %
LED	XT-E	cd/lm	1.100
Color	Black	Gerber File	Available
Diameter	9.9 mm		
Height	6.8 mm		
Style	Round		
Optic Material	PMMA		
Holder Material	PC		
Fastening	Pin, glue		
Status	On production		

Ordering number FP13029_LISA2-WW-CLIP

Family	Lisa2	FWHM	47 degrees
Type	Assembly	Efficiency	84 %
LED	XT-E	cd/lm	1.100
Color	Black	Gerber File	Available
Diameter	9.9 mm		
Height	6.8 mm		
Style	Round		
Optic Material	PMMA		
Holder Material	PC		
Fastening	Clips, glue		
Status	On production		

NOTE: The typical divergence will be changed by different color, chip size and chip position tolerance. The typical total divergence is the full angle measured where the luminous intensity is half of the peak value.



PRODUCT DATASHEET

Lisa2 series

last update 7/9/2012

GENERAL INFORMATION

- Product series especially designed & optimized for XT-E series of LEDs.
- Special care taken to make light distribution as uniform as possible.
- Lens material optical grade PMMA with high UV and temperature resistance. Allows use of high current and temperature conditions.

Please find more information about used material from below:

http://ledil.fi/sites/default/files/Documents/Technical/Material/PMMA%20N%20UL94_Yellow%20Card.pdf

<http://ledil.fi/sites/default/files/Documents/Technical/Material/PMMA%20N%20PLEXIGLAS-Datasheet.pdf>

- Optic holder molded by high quality PC material (120 degrees of Celcius / 248 degrees of Fahrenheit).

D

C

B

A

4

4

3

3

2

2

1

1

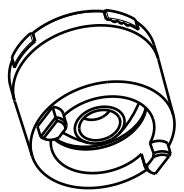
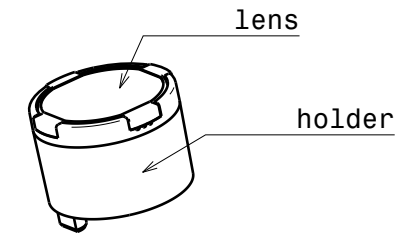

Isometric view
Scale: 2:1

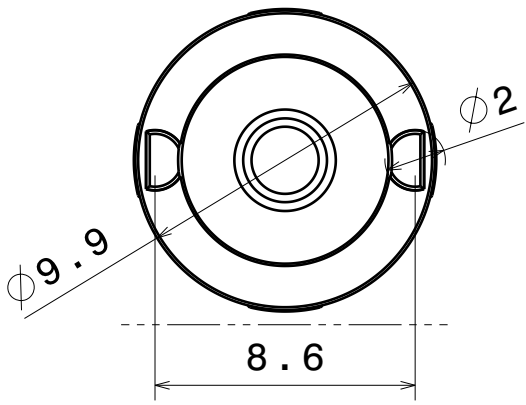

Bottom view

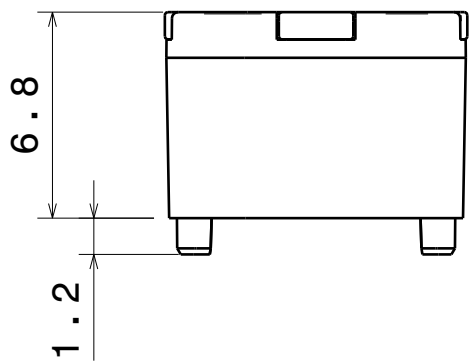

Front view

Materials:
Lens PMMA
Holder PC

This drawing is our property.
It can't be reproduced
or communicated without
our written agreement.



Ledil Oy
Salorankatu 10
FIN-24240 SALO
Finland

DRAWING TITLE
Datasheet Lisa2-Pin-XT Series Assy

DRAWN BY pl	DATE 20.06.2012	DRAWING TITLE Datasheet Lisa2-Pin-XT Series Assy		
CHECKED BY	DATE	SIZE A4	DRAWING NUMBER	REV 1
DESIGNED BY pl	DATE 20.06.2012	SCALE 4:1	WEIGHT (g)	SHEET 1/1

D

A

Luminaire: LEDiL Oy FP13030&FP13028_LISA2-M_PIN&CLIP Ef. 89%
Lamps: 1 x Cree XT-E 104lm@250mA CCT=5000K P=0.77W I=250mA

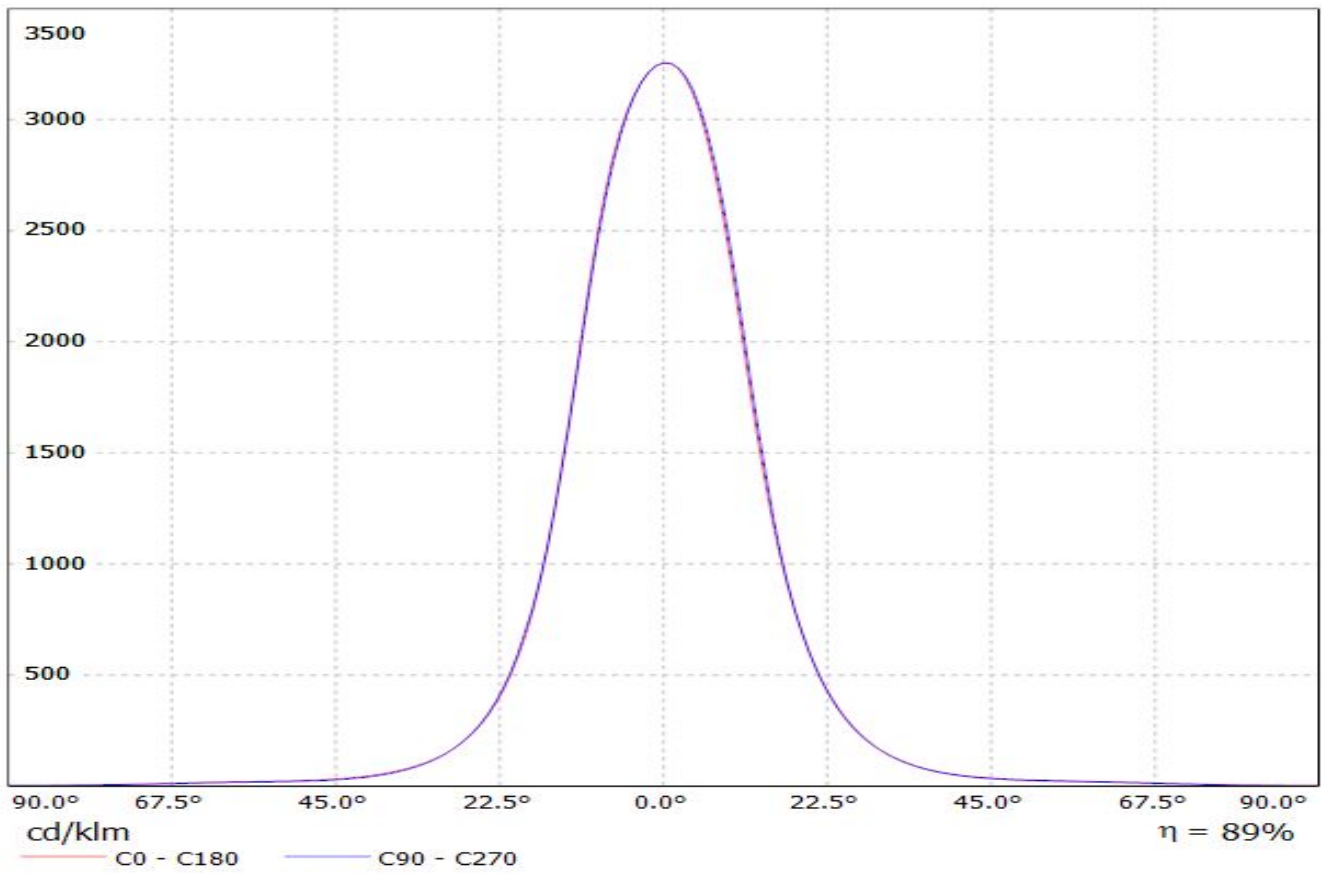

Luminaire: LEDiL Oy FP13030&FP13028_LISA2-M_PIN&CLIP Ef. 89%
Lamps: 1 x Cree XT-E 104lm@250mA CCT=5000K P=0.77W I=250mA

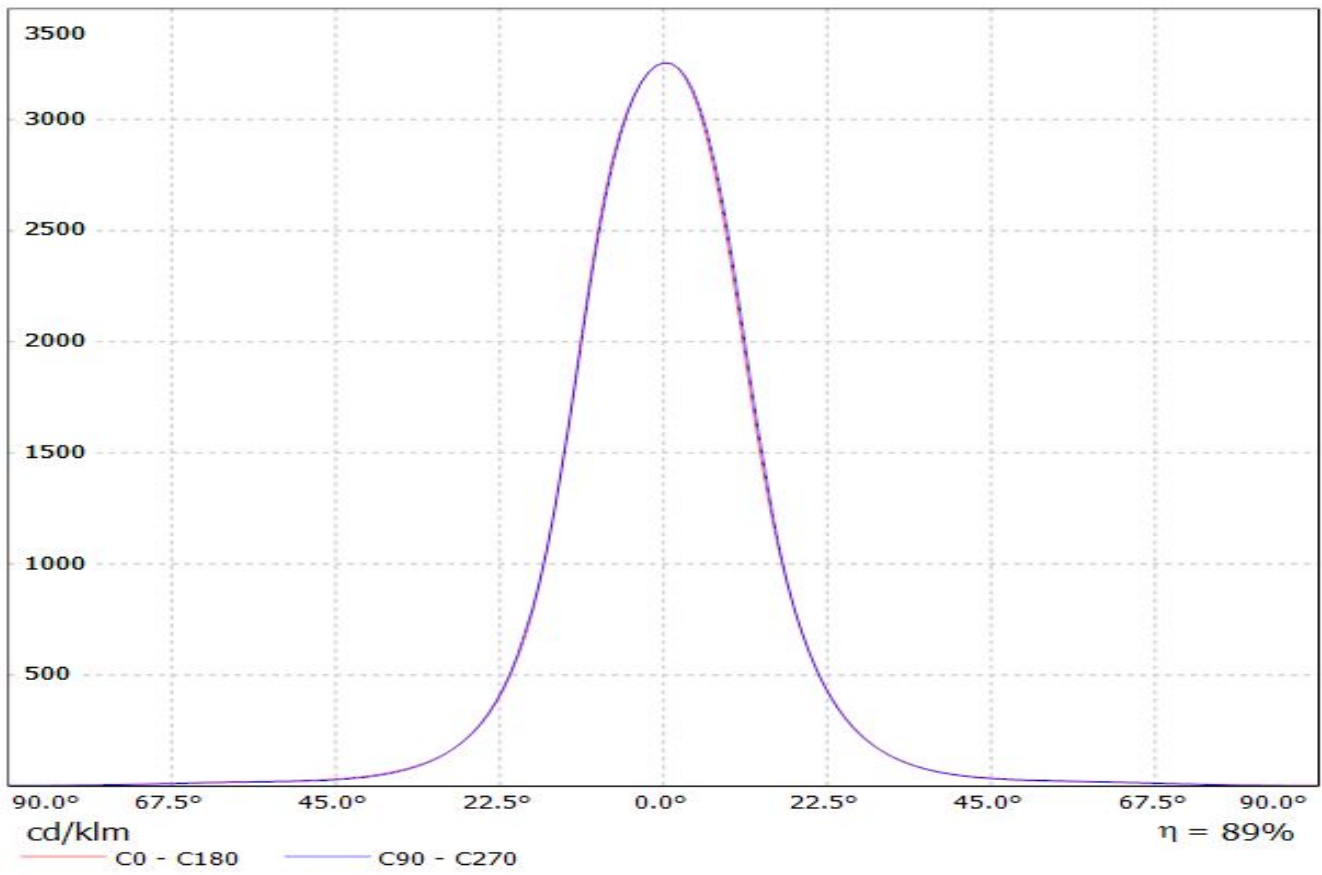

Luminaire: LEDIL OY FP13025_LISA2-W-PIN & FP13031_LISA2-W-CLIP-XTE (Cree XT-E 98lm @ 250mA) Efficiency=84%
Lamps: 1 x CREE XT-E (98.9lm)

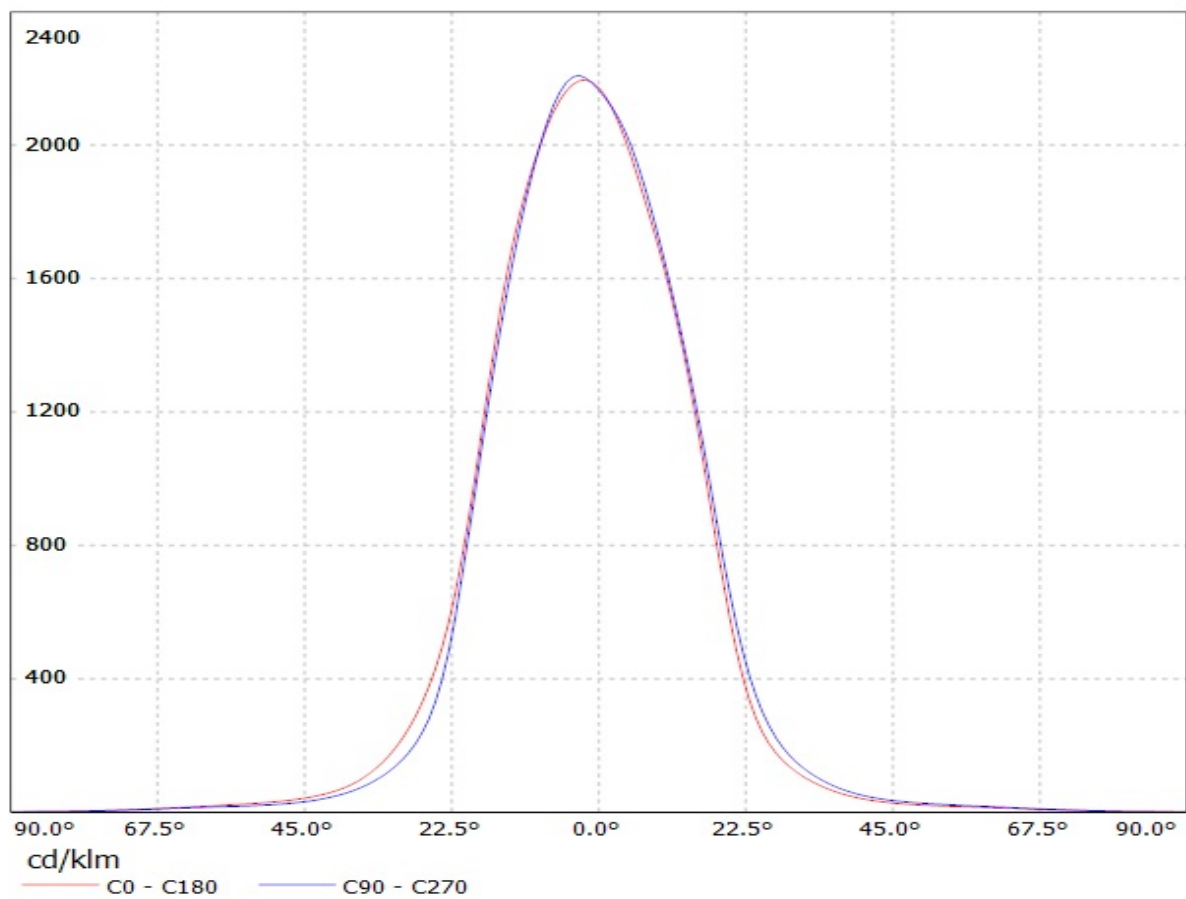

Luminaire: LEDIL OY FP13025_LISA2-W-PIN & FP13031_LISA2-W-CLIP-XTE (Cree XT-E 98lm @ 250mA) Efficiency=84%
Lamps: 1 x CREE XT-E (98.9lm)

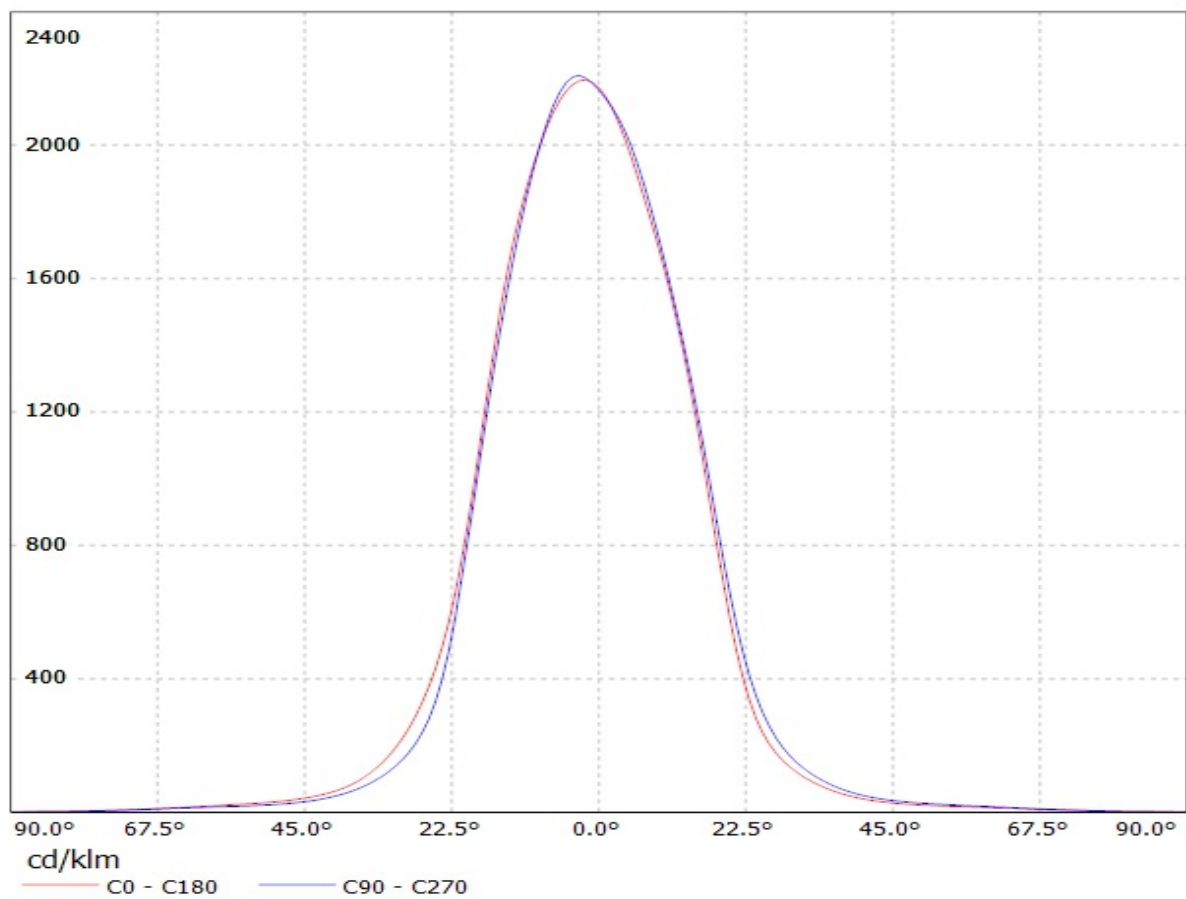

Luminaire: LEDIL OY FP13026_LISA2-WW-PIN & FP13029_LISA2-WW-CLIP-XTE (Cree XT-E 98lm @ 250mA) Efficiency=84%
Lamps: 1 x CREE XT-E (98.9lm)

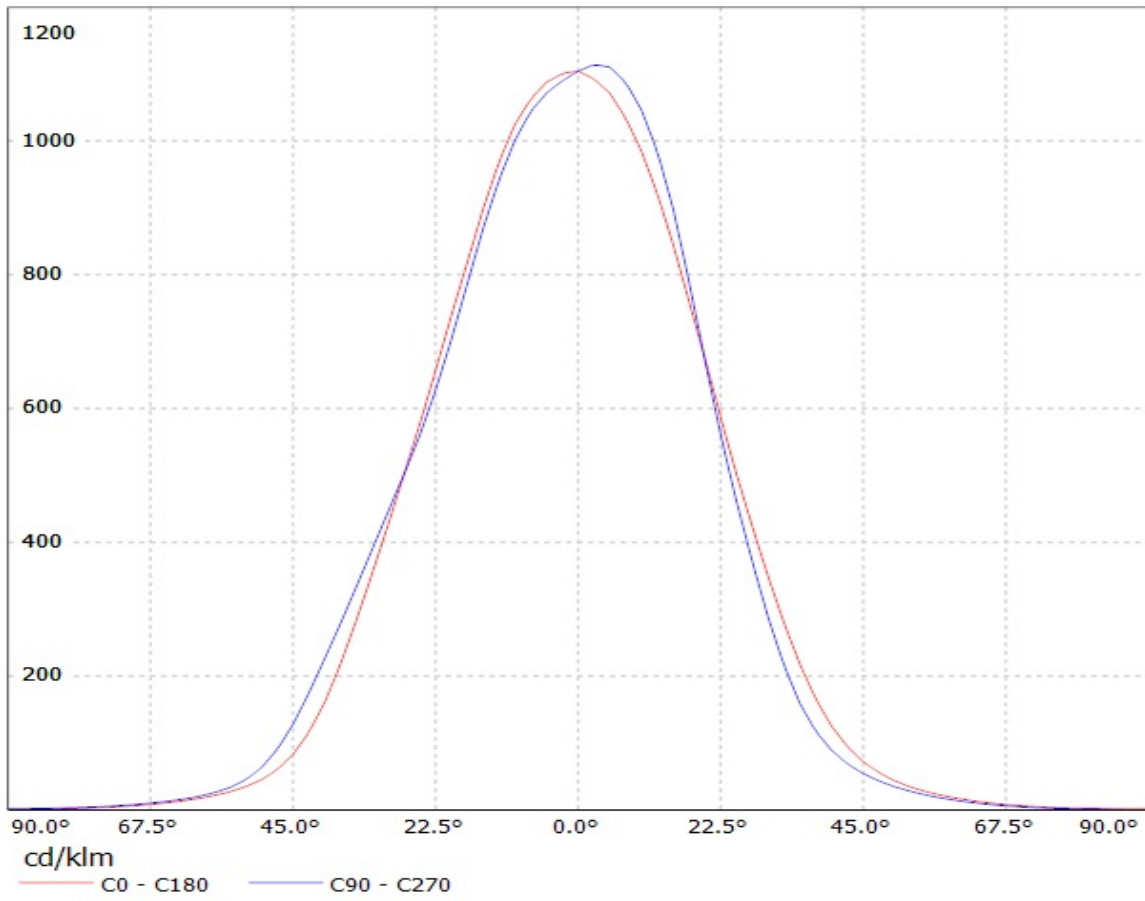

Luminaire: LEDIL OY FP13026_LISA2-WW-PIN & FP13029_LISA2-WW-CLIP-XTE (Cree XT-E 98lm @ 250mA) Efficiency=84%
Lamps: 1 x CREE XT-E (98.9lm)

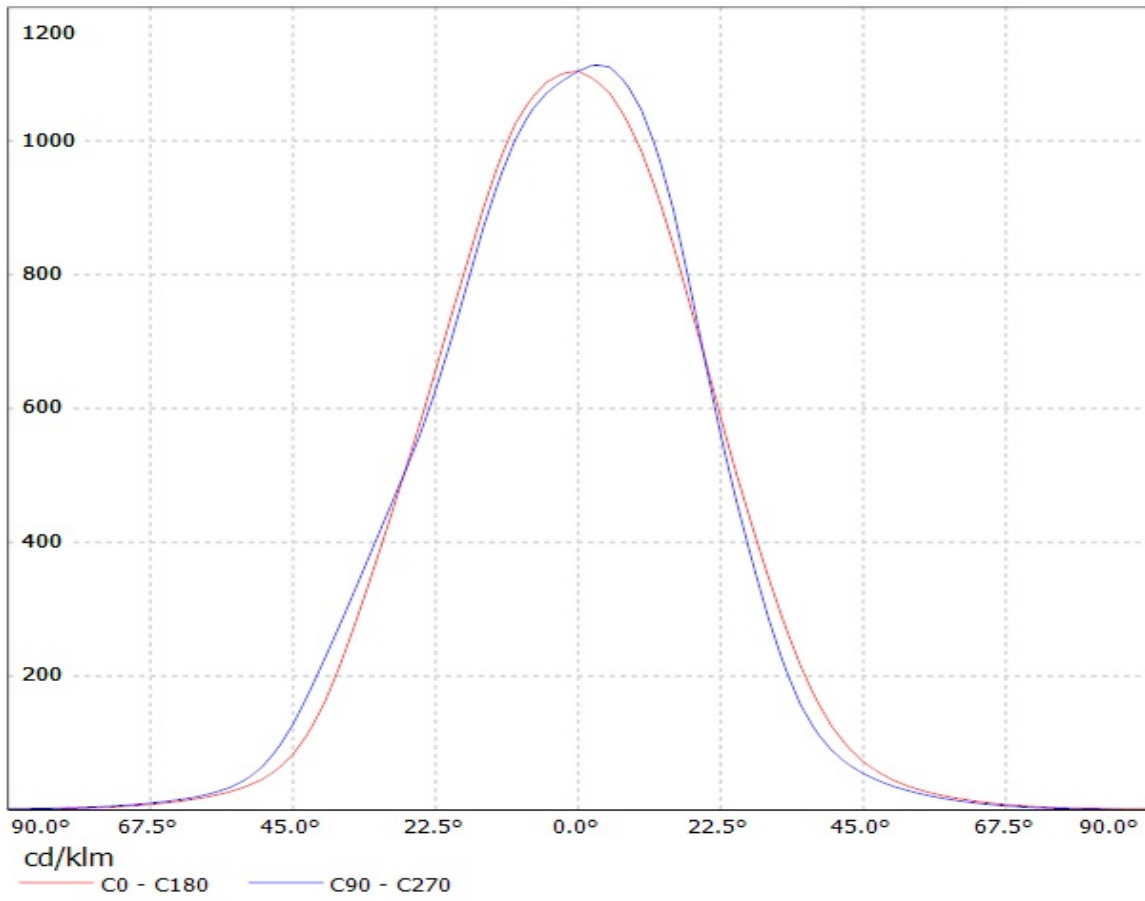

Luminaire: LEDiL Oy FP13030&FP13028_LISA2-M_PIN&CLIP Ef. 89%
Lamps: 1 x Cree XT-E 104lm@250mA CCT=5000K P=0.77W I=250mA

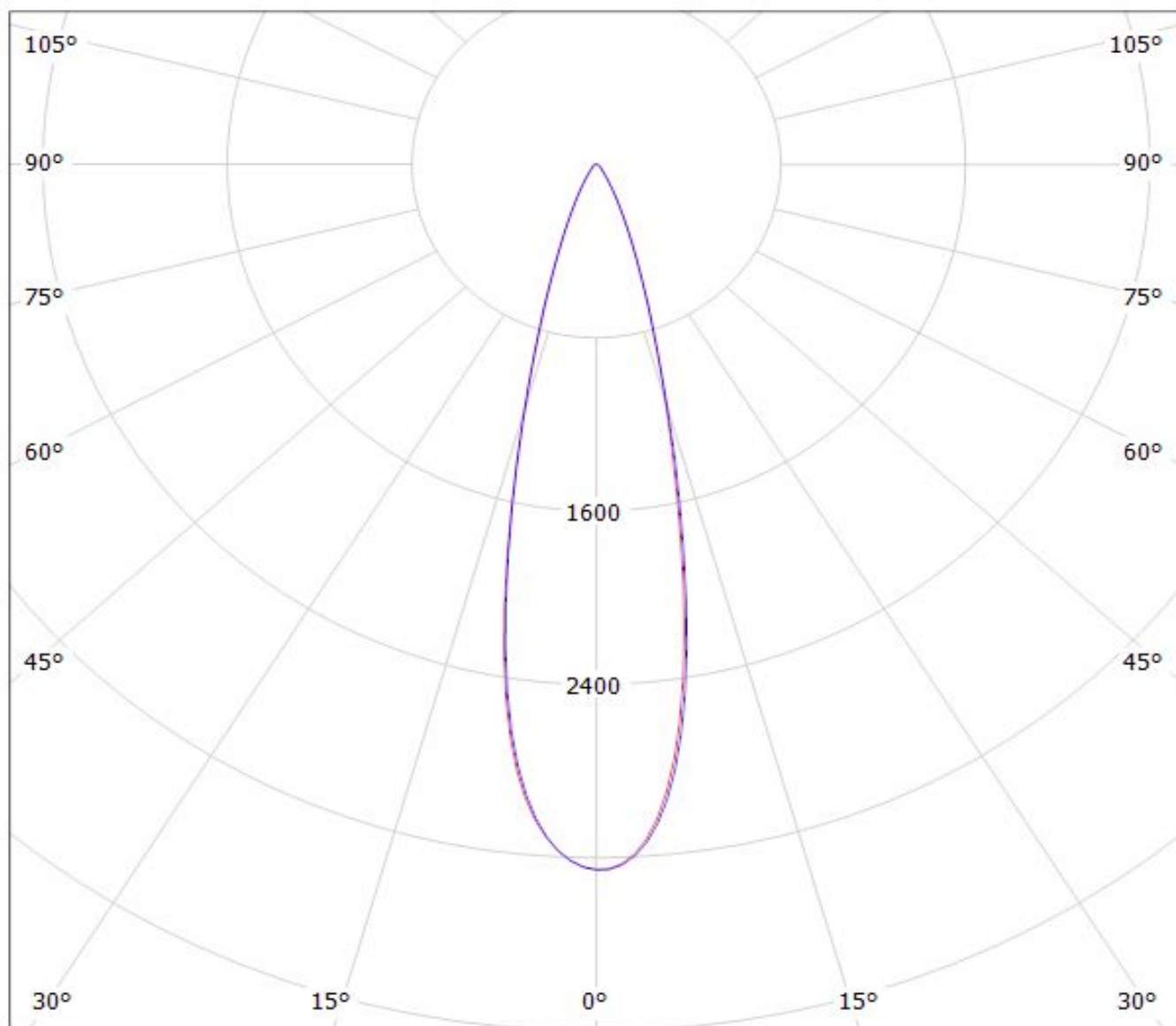

cd/klm

$\eta = 89\%$

— C0 - C180 — C90 - C270

Luminaire: LEDiL Oy FP13030&FP13028_LISA2-M_PIN&CLIP Ef. 89%
Lamps: 1 x Cree XT-E 104lm@250mA CCT=5000K P=0.77W I=250mA

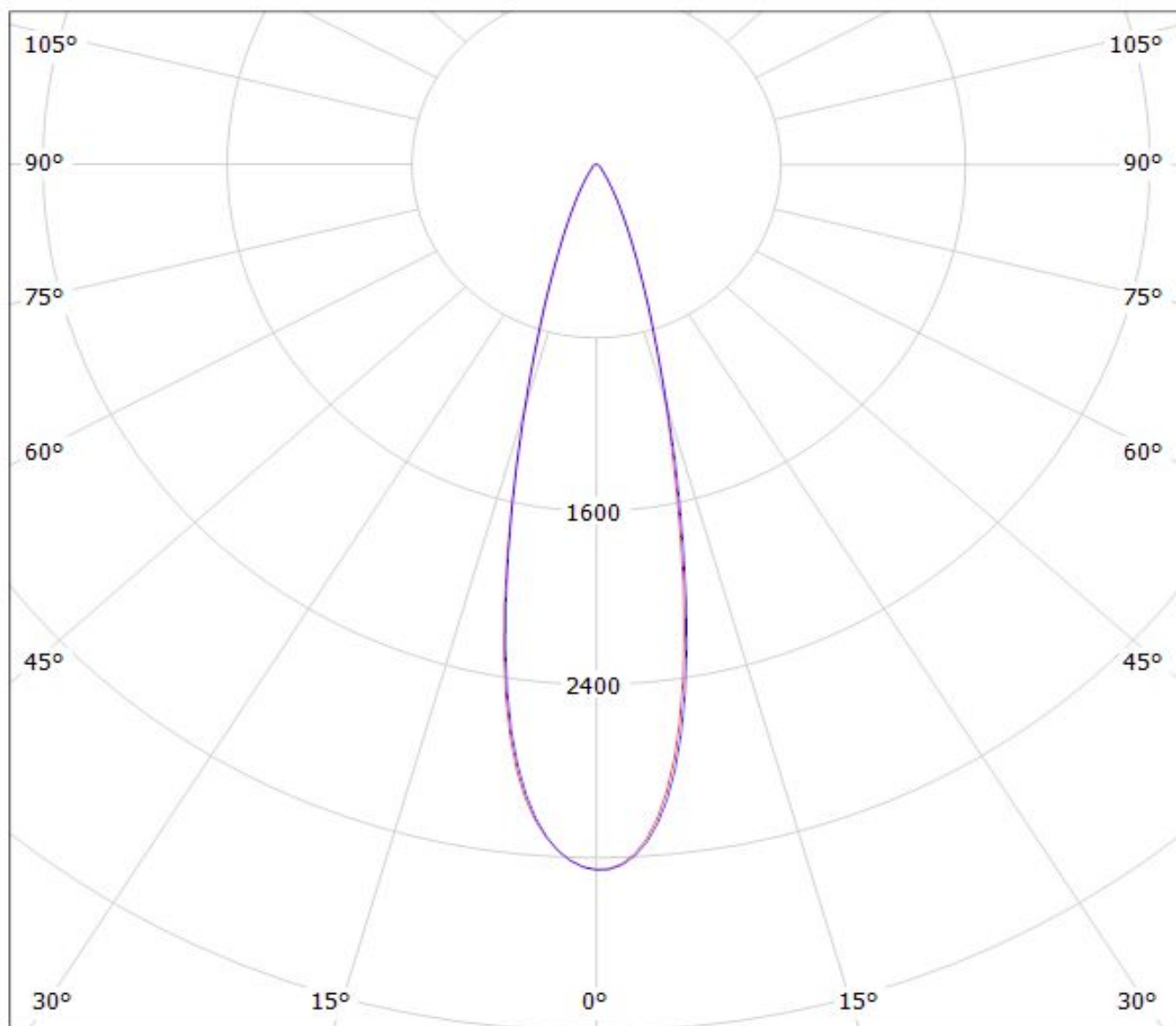

cd/klm

$\eta = 89\%$

— C0 - C180 — C90 - C270

Luminaire: LEDIL OY FP13025_LISA2-W-PIN & FP13031_LISA2-W-CLIP-XTE (Cree XT-E 98lm @ 250mA) Efficiency=84%
Lamps: 1 x CREE XT-E (98.9lm)

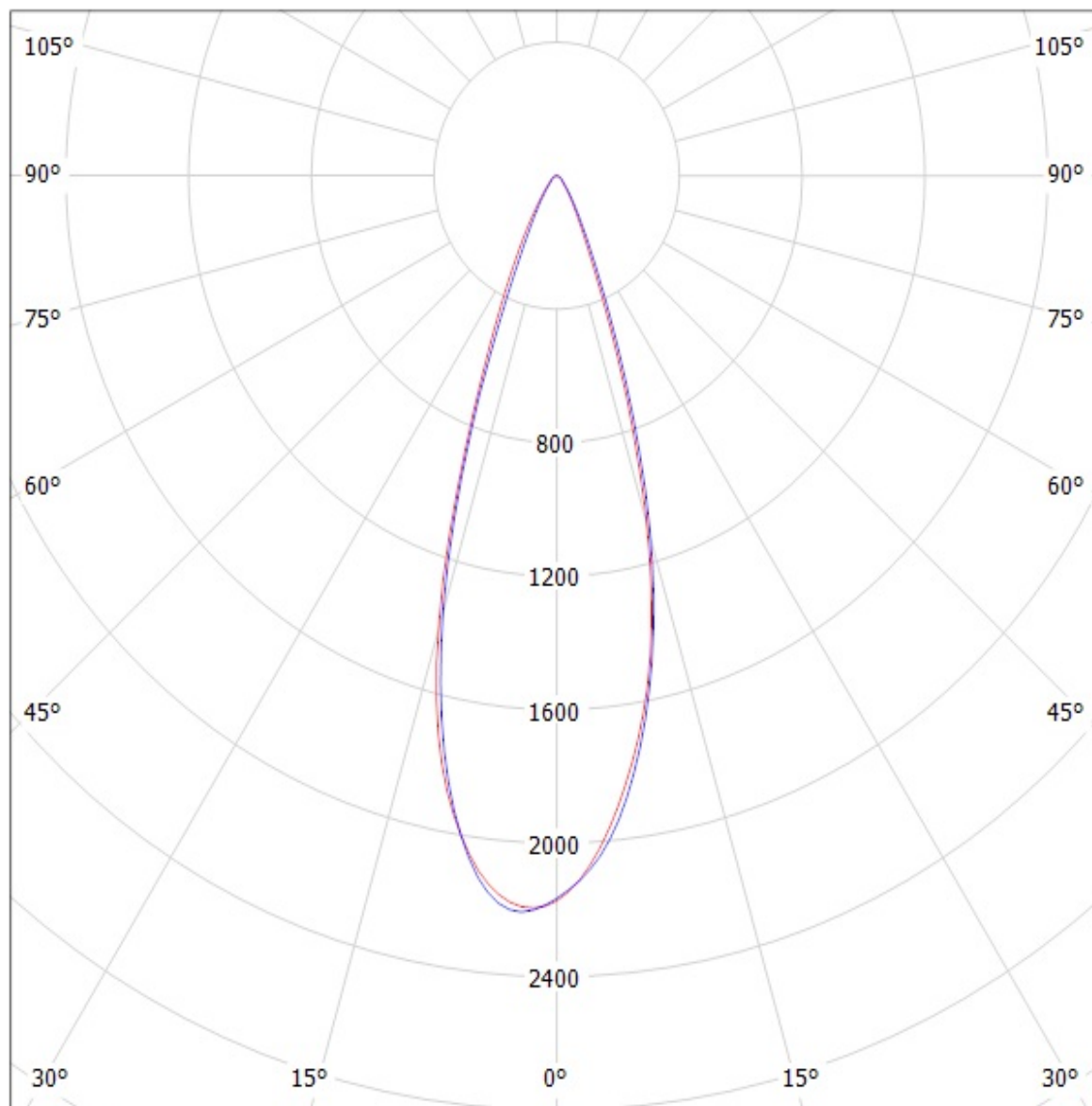

cd/klm

— C0 - C180 — C90 - C270

Luminaire: LEDIL OY FP13025_LISA2-W-PIN & FP13031_LISA2-W-CLIP-XTE (Cree XT-E 98lm @ 250mA) Efficiency=84%
Lamps: 1 x CREE XT-E (98.9lm)

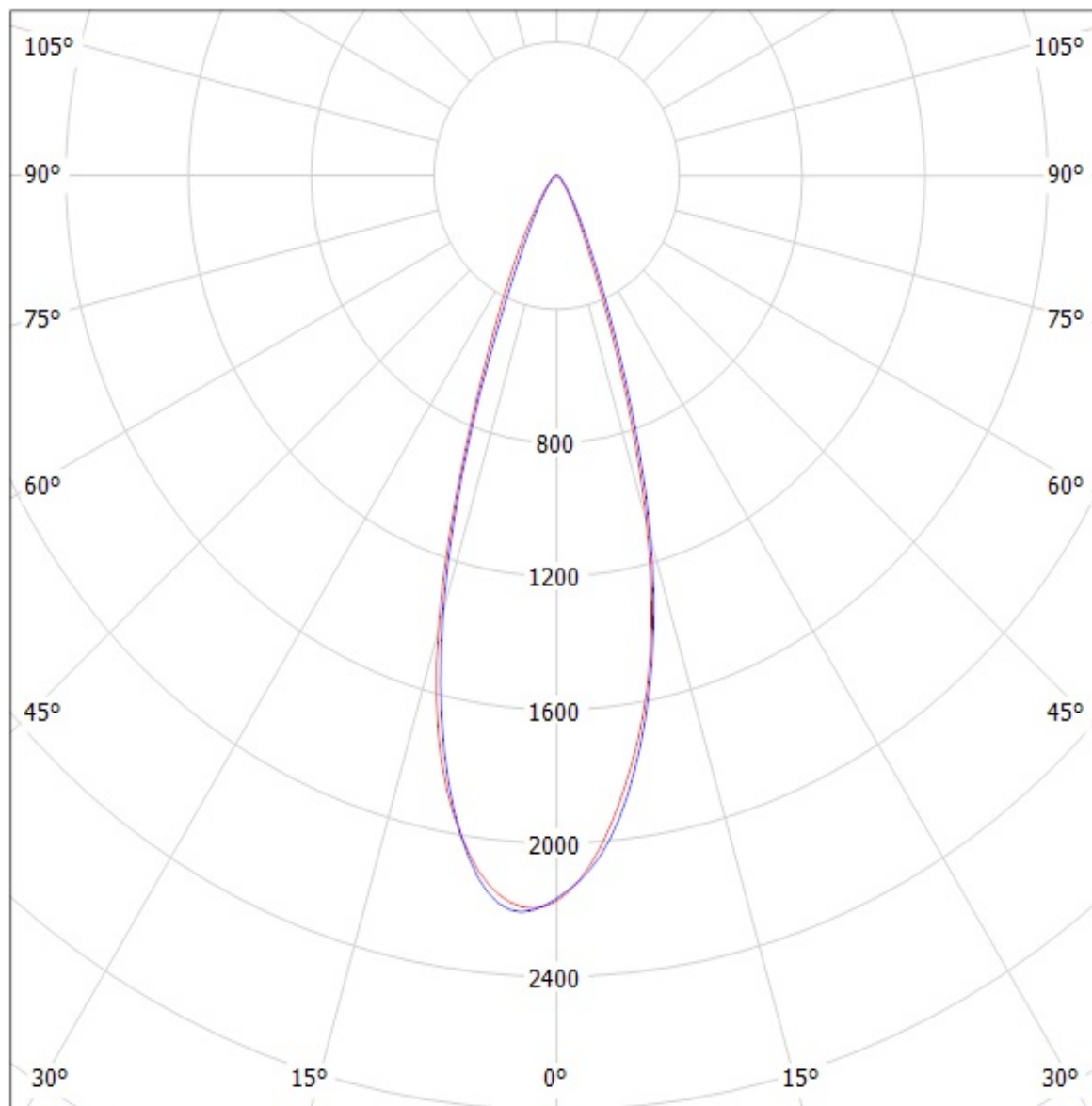

cd/klm

— C0 - C180 — C90 - C270

Luminaire: LEDIL OY FP13026_LISA2-WW-PIN & FP13029_LISA2-WW-CLIP-XTE (Cree XT-E 98lm @ 250mA) Efficiency=84%
Lamps: 1 x CREE XT-E (98.9lm)

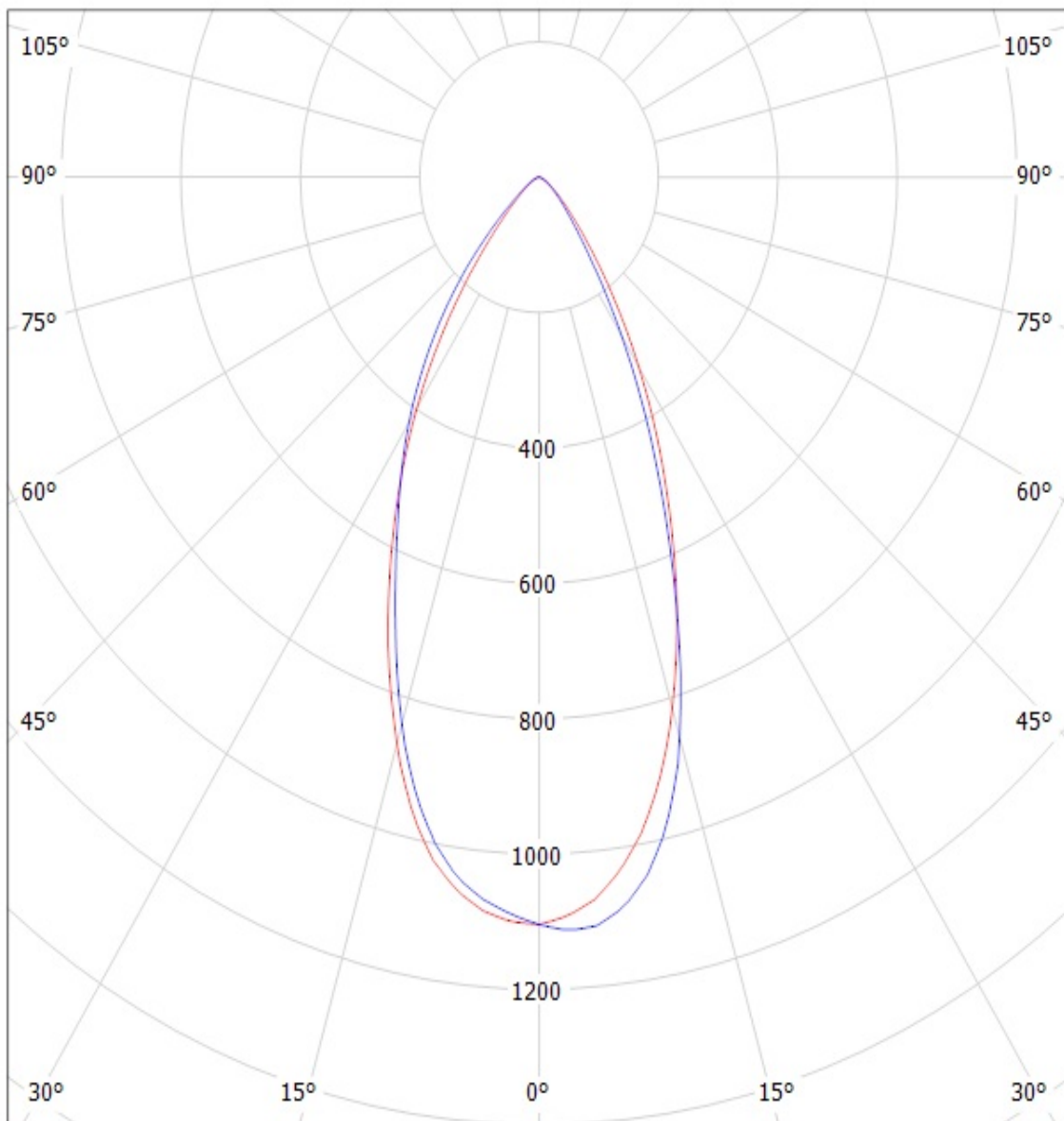

cd/klm

— C0 - C180 — C90 - C270

Luminaire: LEDIL OY FP13026_LISA2-WW-PIN & FP13029_LISA2-WW-CLIP-XTE (Cree XT-E 98lm @ 250mA) Efficiency=84%
Lamps: 1 x CREE XT-E (98.9lm)

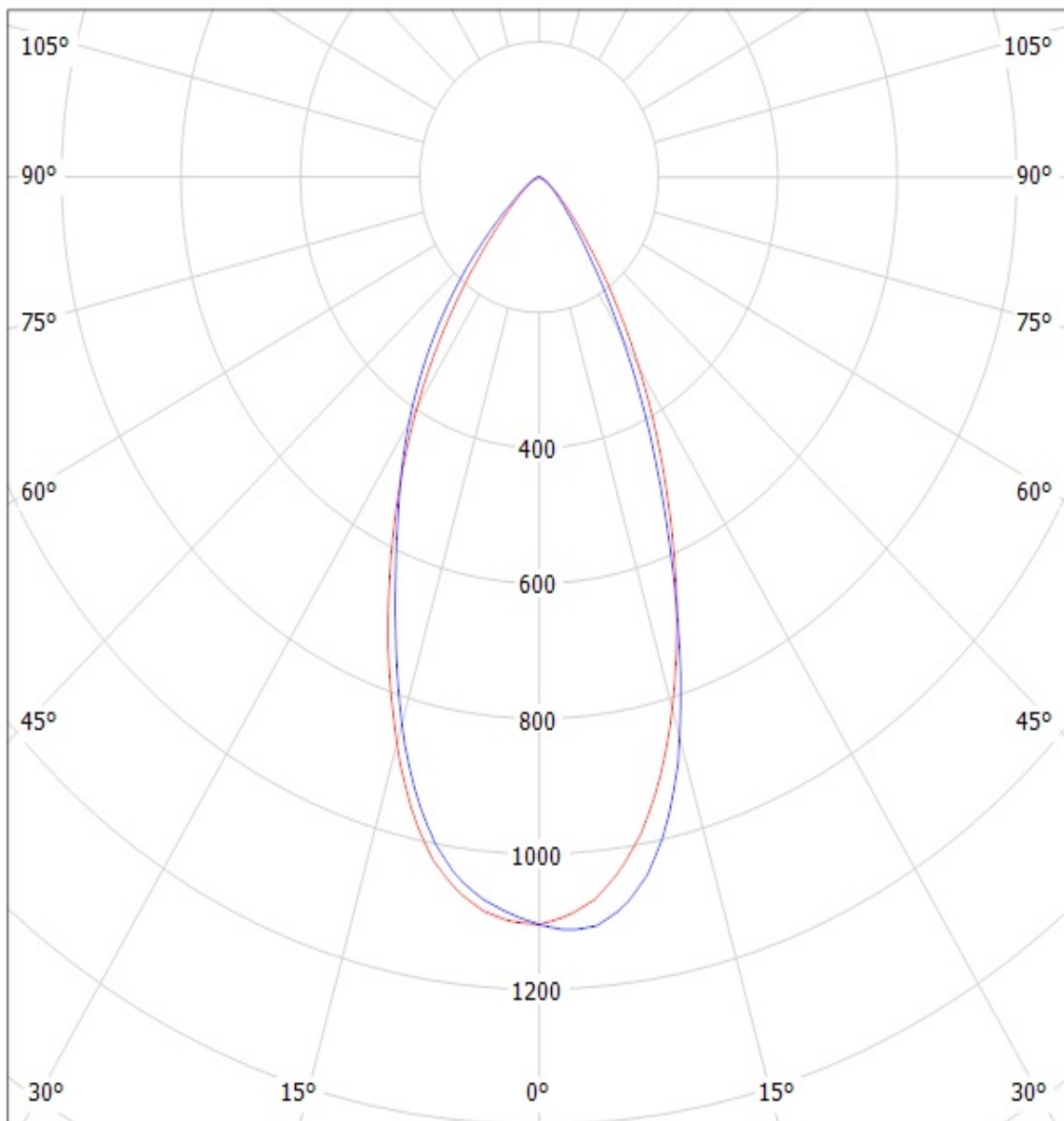

cd/klm

— C0 - C180 — C90 - C270