



Category 5e Component  
DTE Power Compliant  
Keystone Design  
Quicklace™ Combination  
Exclusive 1-Punch Termination Tool

### FEATURES

- Center balanced to Category 5e plug specifications
- Positive PSACR beyond 190 MHz (channel)
- Exceeds component requirements by a minimum of 3dB
- 3+Gbs of Bandwidth (channel)
- Exceeds IEEE 802.3af DTE Power Specification to 4X the standard
- Exceeds IEEE 802.3ab Gigabit Specification to  $< 1 * 10^{-13}$
- Backwards compatible to Category 5 and 3
- IDC pair splitting tower allows for minimum disruption to cable twist
- Exclusive 1-Punch termination tool reduces termination time by 75%
- Compatible with standard 110 termination tools
- Standard HPW keystone mounting
- HPW Icon compatible
- 13 different colors

### SPECIFICATIONS

#### Mechanical

- ◆ Construction Materials:
  - Housing: High impact thermoplastic (UL 94 V-0)
  - Stuffer cap: Lexan (UL 94 V-0)
  - Dust cover: Polypropylene
- ◆ Nose Contacts
  - Material: Beryllium copper with a minimum of 50 micro-inch gold plating over nickel under plating
  - 2,000+ mating cycles with FCC compliant 8-position plug
  - Confirmed contact performance over full range of (FCC Spec) deflection limits
  - Min. contact force 100 grams with FCC compliant 8-position plug
  - Accepts FCC compliant 6-position plugs
- ◆ IDC 110 Contacts
  - Material: Phosphor bronze with 100 micro-inch tin lead 60/40 plating over nickel under plating
  - 20+ IDC terminations for same size AWG
  - Accommodates 22 to 26 AWG/Solid

### STANDARDS/LISTINGS/VERIFICATIONS

- ANSI/TIA/EIA-568-B.2 Category 5e component specifications
- IEEE 802.3af DTE Power and MDI verified
- IEEE 802.3ab Gigabit Ethernet verified
- ETL Verified for Category 5e component
- ETL Total Solutions
- UL Listed 1863
- CSA Certified
- FCC part 68.5, subpart F compliant
- IEC-60603-7-2 compliant
- ISO 11801 2nd Edition Class D compliant



## Xcelerator Category 5e Jacks

#### Termination Towers

- Easy pair splitting
- Simple lacing
- Fast punch-down

#### Universal Wiring

Two distinct labels eliminates wiring confusion, T568B or T568A



#### Stuffer Cap

- Secure strain relief
- Positive "snap" latching

Xcelerator™ Category 5e modular jacks (XJ5e) deliver industry unmatched component performance. The XJ5e is the first modular jack to undergo extreme DTE Power testing to 4x the standard handling continuous DTE Power, exceeding the IEEE 802.3af standard without failure or any substantial increase in temperature.

The XJ5e supports network convergence protocols by delivering maximum bandwidth and extended reliability for all LAN, multimedia and PoE (Power over Ethernet) applications such as VoIP and IP-Video.

The QuickLace™ termination process combined with the exclusive 1-Punch tool delivers the fastest termination in the structured cabling industry. The innovative combination reduces termination time by 75% and provides a consistent termination every time.

The XJ5e easily installs into all HPW Infin-e-Station™ products, including rear-loading plates and front-loading modules and frames. Xcelerator jacks can be used in multimedia configurations with our SF (Snap Fit) connectors customizing all workstations, consolidation points and telecommunication closets.

### APPLICATIONS

- ▲ IEEE 802.3:
  - 1000BASE-T Gigabit Ethernet
  - 100BASE-T
  - 10BASE-T
- ▲ 155Mbps ATM
- ▲ DTE Power Applications
- ▲ VoIP
- ▲ Analog Video
- ▲ Digital video
- ▲ Company intranets
- ▲ On-line document publishing
- ▲ Real-time video to the desktop

**ORDERING INFORMATION**

**Xcelerator™ Category 5e Jacks**

Unit Package	1 per Bag	25 per Bag
Order Qty.	Carton of 25	Bag of 25
Color	Catalog No.	Catalog No.
Black	<b>HXJ5EBK</b>	<b>HXJ5EBK25</b>
Blue	<b>HXJ5EB</b>	<b>HXJ5EB25</b>
Electric Ivory	<b>HXJ5EEI</b>	<b>HXJ5EEI25</b>
Gold	-	<b>HXJ5EGL25</b>
Gray	<b>HXJ5EGY</b>	<b>HXJ5EGY25</b>
Green	<b>HXJ5EGN</b>	<b>HXJ5EGN25</b>
Office White	<b>HXJ5EOW</b>	<b>HXJ5EOW25</b>
Orange	<b>HXJ5EOR</b>	<b>HXJ5EOR25</b>
Purple	-	<b>HXJ5EP25</b>
Red	<b>HXJ5ER</b>	<b>HXJ5ER25</b>
Telco Ivory	<b>HXJ5ETI</b>	<b>HXJ5ETI25</b>
White	<b>HXJ5EW</b>	<b>HXJ5EW25</b>
Yellow	<b>HXJ5EY</b>	<b>HXJ5EY25</b>

**ACCESSORIES**

**Icon System**

Identify the work area or the cross connect with Hubbell's new icon system. The new icons are offered in packs of 100 blank or with a computer or telephone molded in. Customize each blank icon with our preprinted icon booklet. Each booklet has 11 pages with numerous labels ranging from A to G, FAX to Data, providing a multitude of options, which adheres to ANSI/TIA/EIA-606-A.

			
Color	Blank	Computer	Telephone
Black	<b>IBK100</b>	<b>IBK100C</b>	<b>IBK100T</b>
Blue	<b>IB100</b>	<b>IB100C</b>	<b>IB100T</b>
Brown	<b>IBN100</b>	<b>IBN100C</b>	<b>IBN100T</b>
Electric Ivory	<b>IEI100</b>	<b>IEI100C</b>	<b>IEI100T</b>
Gray	<b>IGY100</b>	<b>IGY100C</b>	<b>IGY100T</b>
Green	<b>IGN100</b>	<b>IGN100C</b>	<b>IGN100T</b>
Orange	<b>IOR100</b>	<b>IOR100C</b>	<b>IOR100T</b>
Purple	<b>IP100</b>	<b>IP100C</b>	<b>IP100T</b>
Red	<b>IR100</b>	<b>IR100C</b>	<b>IR100T</b>
White	<b>IW100</b>	<b>IW100C</b>	<b>IW100T</b>
Yellow	<b>IY100</b>	<b>IY100C</b>	<b>IY100T</b>

**DIMENSIONS**

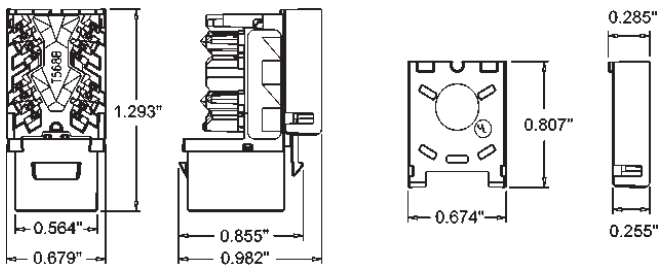

**1-PUNCH INSTRUCTIONS**

The "1-Punch" Tool and Xcelerator™ Jacks are made for each other. Designed to punch-down all 4-pairs consistently and cut off all conductors in "1-Punch". This tool saves valuable installation time over traditional single-blade tools that require multiple cycles.

This tool should be used exclusively with Xcelerator™ jacks and with the Hubbell Premise Wiring "Jack Knuckles" termination aid.

**Five easy steps get the job done:**

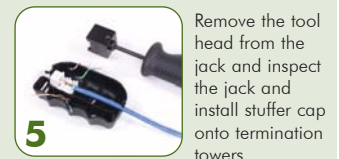
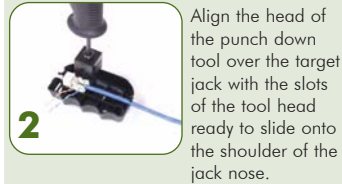
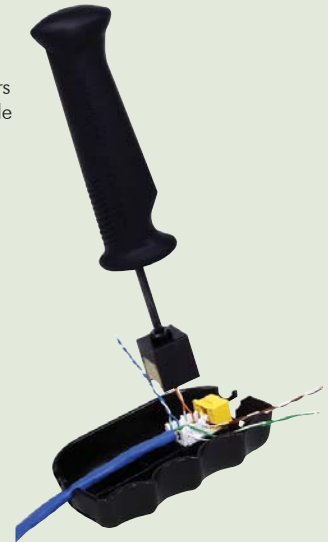

**ORDER INFORMATION - 1-PUNCH TOOL**

**Delivery**

- 1 Impact handle
- 1 Punch-down head for Xcelerator™ jacks
- 1 "Jack Knuckles" termination aid

Description	Catalog No.
1-Punch Tool with head, blades and termination aid	<b>TX4P</b>

**ACCESSORIES**

Replacement 4-pair XJ head	<b>TX4PH</b>
Replacement 4-pair XJ blades	<b>TX4PHBL</b>
Jack Knuckles termination aid	<b>HXTA</b>
Snap-X termination puck (25-pack)	<b>HXTP25</b>
Xcelerator Hinged Dust Cover (25-pack)	<b>HXJDC25</b>



**Hubbell Premise Wiring**

HUBBELL INCORPORATED (Delaware)  
 14 Lord's Hill Road • Stonington, CT 06378-0901 • (860) 535-8326 • 800-626-0005  
 Fax: (860) 535-8328 • Internet site: <http://www.hubbell-premise.com>

**Worldwide Locations**

Hubbell Premise Wiring, Asia Pacific  
 Hubbell Canada Inc.  
 Hubbell Premise Wiring, China  
 Hubbell Premise Wiring, Europe  
 Hubbell Int'l. Inc., Korea Branch  
 Hubbell Premise Wiring, Latin America

852-2836-7131 Fax: 852-2836-7132  
 905-839-1138 Fax: 905-839-9108  
 86-21-63090119 Fax: 86-21-63090122  
 44-(0)1234-848550 Fax: 44-(0)1234-856190  
 82-2-(0)2607-1363 Fax: 82-2-(0)2603-7386  
 305-251-4236 Fax: 305-251-4087

Hubbell de Mexico, S.A. de C.V.  
 Hubbell Premise Wiring, Middle East  
 Hubbell Premise Wiring, Puerto Rico  
 Hubbell-Taian Co., Ltd., Taiwan  
 Hubbell Incorporated, Turkey  
 Hubbell Premise Wiring, Venezuela

52-5-559-5304 Fax: 52-5-559-5885  
 971-4-393-4192 Fax: 971-4-393-4194  
 787-720-7185 Fax: 787-789-2796  
 886-2-(0)2515-0855 Fax: 886-2-(0)2515-0899  
 90-216-414-8147 Fax: 90-216-414-8148  
 58-16-6807453 Fax: 58-281-2820323