

PITCH 1.25mm BAR CONNECTORS

性能:

- 额定电流: 1A
- 额定电压: 100V
- 耐电压: 500V
- 接触电阻: $\leq 20m\Omega$
- 绝缘电阻: 500M Ω
- 工作温度: $-20^{\circ}C \sim +85^{\circ}C$
- 塑件 (材质): LCP, UL94V-0
- 插簧 (材质): 磷青铜, 镀锡/镀金
- 焊片 (材质): 磷青铜, 镀锡/镀金

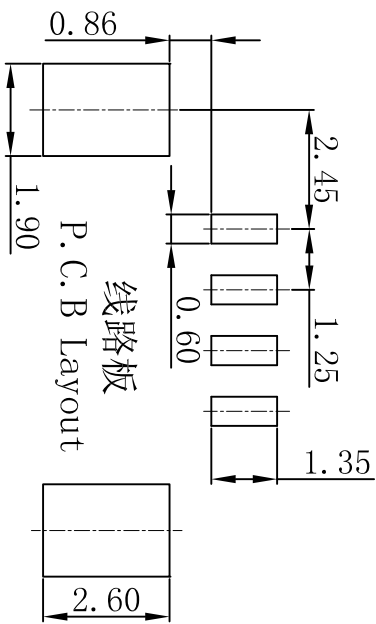
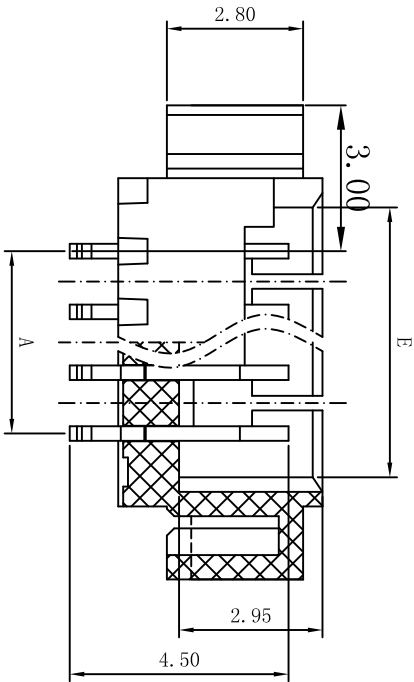
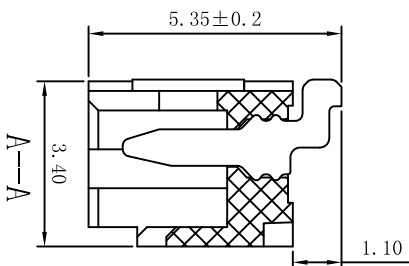
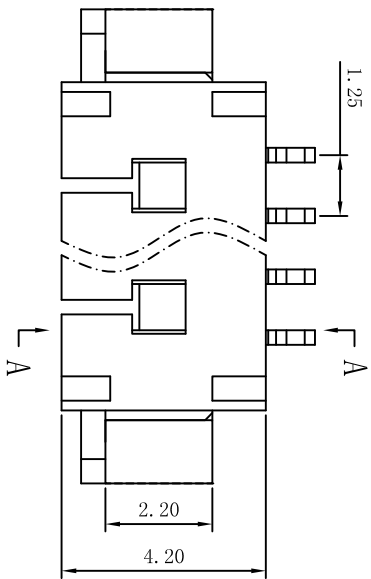
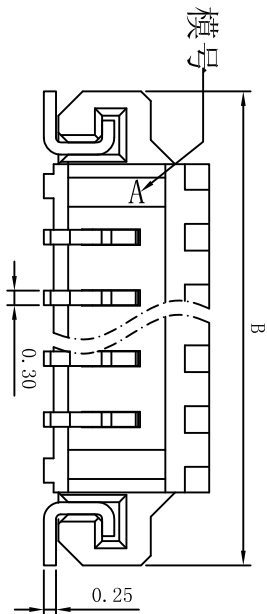

孔位	A	B	E
2	1.25	7.25	3.05
3	2.50	8.50	4.30
4	3.75	9.75	5.55
5	5.00	11.00	6.80
6	6.25	12.25	8.05
7	7.50	13.50	9.30
8	8.75	14.75	10.55
9	10.00	16.00	11.80
10	11.25	17.25	13.05
11	12.50	18.50	14.30
12	13.75	19.75	15.55
13	15.00	21.00	16.80
14	16.25	22.25	18.05
15	17.50	23.50	19.30
16	18.75	24.75	20.55

线路板
P.C.B Layout

UNITS	mm
MAT'L	
FINISH	
Q'TY	

NAME (REFERRED USED)	1.25mm (0型) 条形连接器插贴式
PART NO. (REFERRED USED)	1.25-D-1P16B
CHKD:	
DR:	

深圳市鸿锐盛电子有限公司

TITLE: 1.25mm (0型) 条形连接器插贴式

DWG NO.:



SCALE	SHEET	REV.
1/1	1/1	A