

ESL107M035AE3AA

ESL, Aluminum Electrolytic, 100 uF, 20%, 35 VDC, -40/+105°C, Lead Spacing = 2.5mm

SIDE VIEW

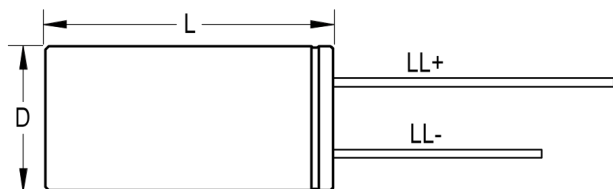

TERMINAL END VIEW

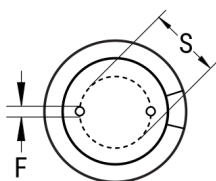

Click [here](#) for the 3D model.

Dimensions

D	6.3mm +/-0.5mm
L	11mm +1.5mm
S	2.5mm +/-0.5mm
LL Negative	15mm MIN
LL Positive	20mm MIN
F	0.5mm NOM

Packaging Specifications

Packaging	Bulk, Bag
Packaging Quantity	10000

General Information

Series	ESL
Dielectric	Aluminum Electrolytic
Description	Single Ended Aluminum Electrolytic
RoHS	Yes
Lead	Wire Leads
AEC-Q200	No

Specifications

Capacitance	100 uF
Capacitance Tolerance	20%
Voltage DC	35 VDC, 44 VDC (Surge)
Temperature Range	-40/+105°C
Rated Temperature	105°C
Life	8000 Hrs
Dissipation Factor	12%
Resistance	0.085 Ohms (100kHz 20C)
Ripple Current	545 mAmps (100kHz 105C)
Leakage Current	35 uA (2min 20°C)
Impedance Ratio at -40C	6