

A

B

C

D

E

F

| 修 订 | 标 记 | 修 改 描 述 | 签 名 | 日 期 |
|-----------|--------|------------------|-----------|------------|
| REV NO | | NEW DWG | SIGNATURE | DATE |
| | | | | 2016-03-12 |

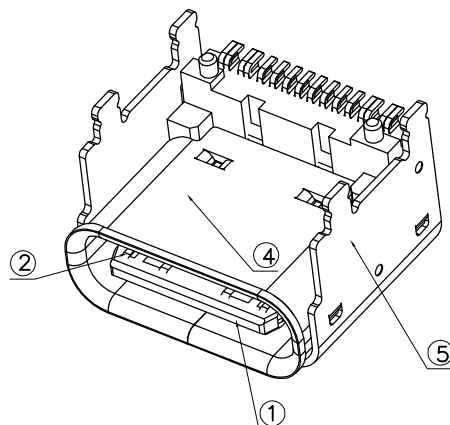
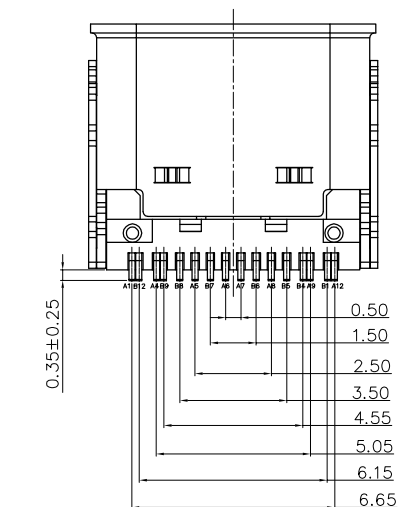
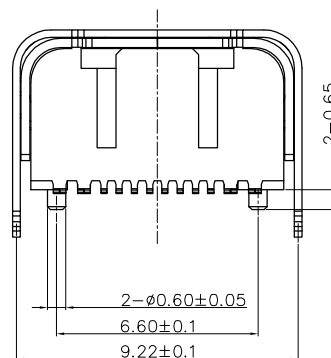
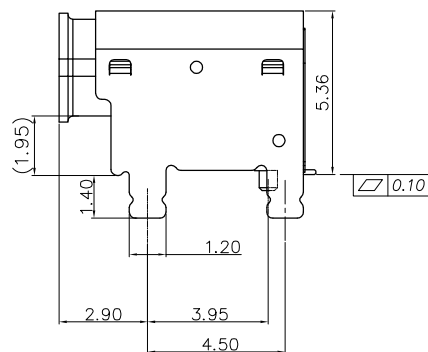
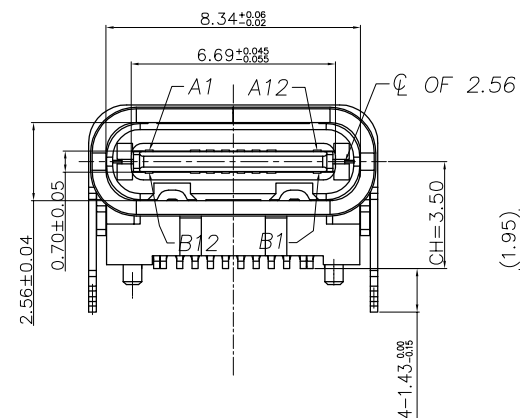
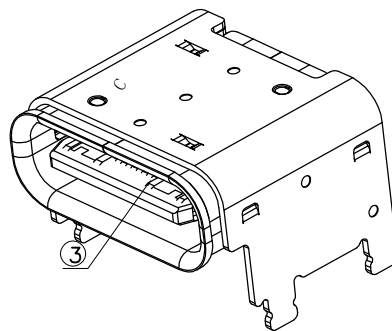
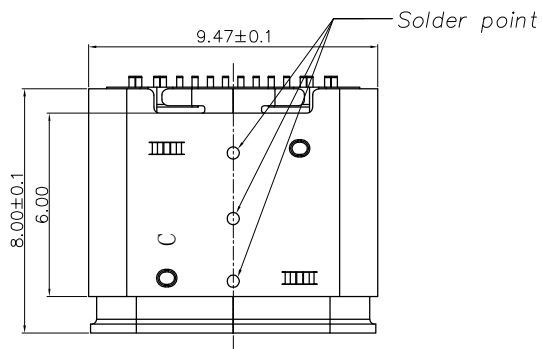

NOTE:

1.MATERIAL SPECIFICATION:

- 1.HOUSING:HIGH TEMPERATURE RESISTANT PLASTIC,UL94 V-0.
- 2.CONTACTS: COPPER ALLOY
- 3.MID PLATE: STAINLESS STEEL
- 4.INSIDE SHELL: STAINLESS STEEL
- 5.OUTSIDE SHELL: STAINLESS STEEL

2.PLATING SPECIFICATION:

2-1.CONTACTS:

- Ni 50u" MIN. UNDER PLATED OVER ALL.
Au PLATED ON THE FUNCTIONAL AREA OF CONTACT.
(GOLD PLATING THICKNESS FOLLOW THE P/N)
GOLD FLASH PLATING ON SOLDER AREA

2-2.INSIDE SHELL OR OUTSIDE SHELL:

- Ni 30u" MIN. UNDER PLATED OVER ALL.

3.MECHANICAL PERFORMANCE,

- 3-1.INSERTION FORCE: 0.5~2.0kgf.
3-2.REMOVAL FORCE: 0.8kgf~2.0kgf.
3-3.DURABILITY: 10000 CYCLES.

4.ELECTRICAL PERFORMANCE,

- 4-1. CURRENT RATING: 5A
VOLTAGE RATING: 20V
4-2.INSULATION RESISTANCE: 100MΩ MIN
4-3.DIELECTRIC WITHSTAND VOLTAGE,AC 100V FOR 1 MINUTE.
4-4.LOW CONTACT RESISTANCE: INITIAL 40MΩ
AFTER 50MΩ

5. ENVIRONMENTAL PERFORMANCE:

- OPERATING TEMPERATURE: -30℃~+80℃.

6.IR REFLOW:

- THE PEAK TEMPERATURE ON THE BOARD SHALL
BE MAINTAINED FOR 10 SECONDS AT 260℃.

| 5 | OUTER SHELL | SUS304 T=0.25MM | NI 40u"MIN | 1PCS |
|-----|-----------------|-----------------|--------------------------------------------------------------------------|------|
| 4 | INNER SHELL | SUS304 T=0.30MM | NI 40u"MIN | 1PCS |
| 3 | SHIELDING PLATE | SUS301 T=0.15MM | N/A | 1PCS |
| 2 | CONTACT | C2680 T=0.15MM | Mating area 1u"Au Solder Tails: G/F Underplate: 80u"Min Ni overall | 2SET |
| 1 | INSERT MOLDING | LCP UL94V-0 | BLACK | 1PCS |
| NO. | DESCRIPTION | MATERIAL | REMARKS | |



深圳市华德共创科技有限公司

Shenzhen Huade co-create Technology Co.,LTD

电话: 0755-23304126 传真: 0755-29940187

-TOLERANCES-
UNLESS OTHERWISE SPECIFIED
公差参数表

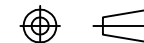

TITLE: TYPE C 16PIN 板上型垫高1.9
产品名称: 双壳 L=8.0

| | | | | | | | | | |
|-------|-------|--------|-----|-------------------|------------------------------------|-------|------|-------------|--|
| X.X | ±0.30 | X.X* | ±3° | APPD: 核准: | PART NO: 产品编号: TYPE C-DB-118PWB | | | | |
| X.XX | ±0.20 | X.XX* | ±2° | CHECK: 校对: 王建业 | DATE | SCALE | UNIT | CODE NUMBER | |
| X.XXX | ±0.10 | X.XXX* | ±1° | DRAW: 绘图: 黄艳兰 | 2016-03-12 | 1:1 | mm | A001 | |

| 修 订 | 标 记 | 修 改 描 要 | 签 名 | 日 期 |
|-----------|--------|----------------------|-----------|------------|
| REV NO | MARK | REVISION DESCRIPTION | SIGNATURE | DATE |
| | | NEW DWG | | 2016-03-12 |
| | | | | |

USB TYPE-C PIN ASSIGNMENTS

| PIN NUMBER | SIGNAL NAME | PIN NUMBER | SIGNAL NAME |
|------------|-------------|------------|-------------|
| A1 | GND | B12 | GND |
| A4 | VBUS | B9 | VBUS |
| A5 | CC1 | B8 | SBU2 |
| A6 | Dp1 | B7 | Dn2 |
| A7 | Dn1 | B6 | Dp2 |
| A8 | SBU1 | B5 | CC2 |
| A9 | VBUS | B4 | VBUS |
| A12 | GND | B1 | GND |

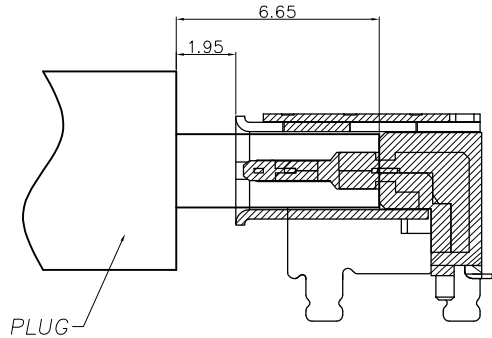

AFTER MATING
SCALE 1:1

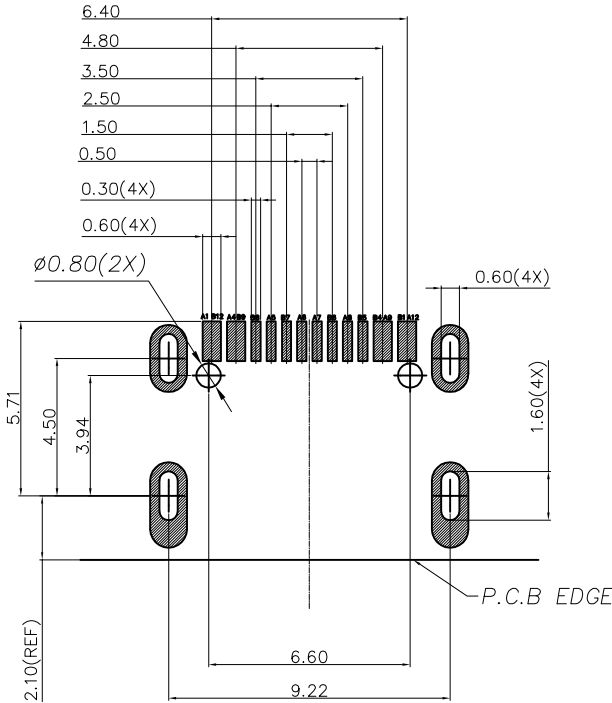

RECOMMEND P.C.B LAYOUT(COMPONENT SIDE)
TOLERANCE FOR PCB LAYOUT IS ± 0.05



深圳市华德共创科技有限公司
Shenzhen Huade co-create Technology Co.,LTD
电话: 0755-23304126 传真: 0755-29940187

| -TOLERANCES- UNLESS OTHERWISE SPECIFIED 公差参数表 | | | | TITLE: TYPE C 16PIN 板上型垫高1.9 产品名称: 双壳 L=8.0 | | | |
|-----------------------------------------------------|------------|--------|---------------|------------------------------------------------|------------------------------------|-------|------|
| X.X | ± 0.30 | X.X* | $\pm 3^\circ$ | APPD: 核准: | PART NO: 产品编号: TYPE C-DB-118PWB | | |
| X.XX | ± 0.20 | X.XX* | $\pm 2^\circ$ | CHECK: 校对: 王建业 | DATE | SCALE | UNIT |
| X.XXX | ± 0.10 | X.XXX* | $\pm 1^\circ$ | DRAW: 绘图: 黄艳兰 | 2016-03-12 | 1:1 | mm |
| | | | | CODE NUMBER A001 | | | |

A B C D E F

| 修订 | 标记 | 修改摘要 | 签名 | 日期 |
|-----|------|----------------------|-----------|------------|
| REV | MARK | REVISION DESCRIPTION | SIGNATURE | DATE |
| AO | | NEW DRG | | 2016-03-12 |

出料方向
PULL OUT DIRECTEON

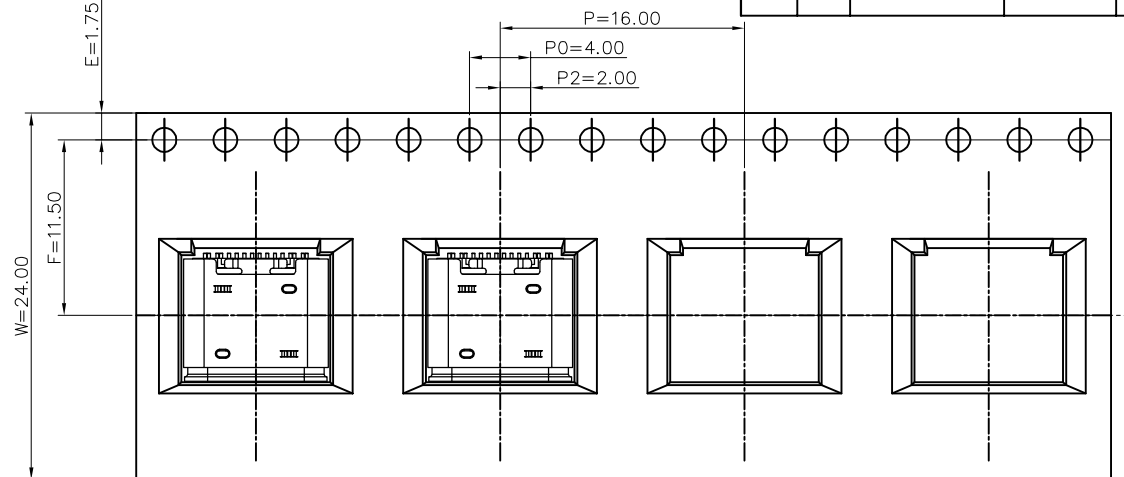
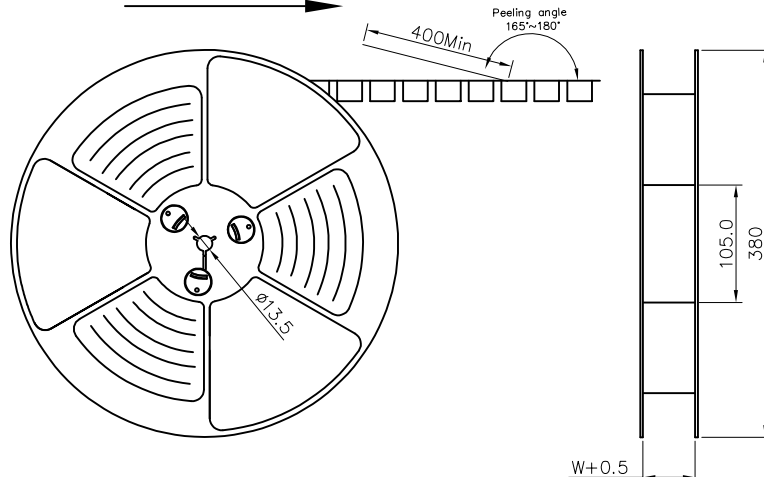

NOTES

1. 帶子引導長度
LEAD TAPE LENGTH
出料方向
PULL OUT DIRECTEON

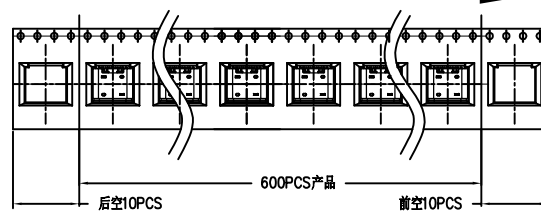

2. 上帶 剝離力為: 0.1~1.3N(10.2gf~130gf)
PEELING OFF FORCE OF TOP TAPE: 0.1~1.3N(10.2gf~130gf)
出貨運輸過程中一定注意:
THIS REQUIREMENT SHOULD BE APPLIED AT SHIPMENT:
卷帶在運輸過程中不能散開
PEELING OFF SHOULD NOT BE ALLOWED DURING TRANSPORTATION

TAPE & REEL 7 PCS

1 REEL
= 600 PCS

BOX

DIMENSIONS:
39.5X39.5X20

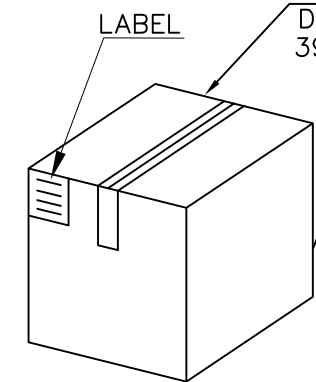
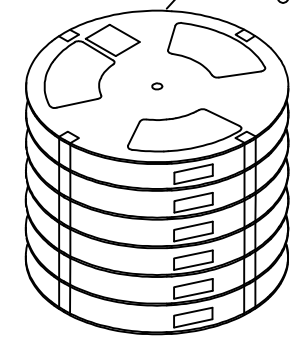

1 CARTON
= 6 REELS
= 3600 PCS

| 包裝明細表 (The detail of the packing) Carton | | | | | | |
|------------------------------------------|-------------------------|-------------|---------|----------------|----------|----------|
| 產品料號 (Product No.) | 包裝容量 (Packing Capacity) | | | 重量 Weight (Kg) | | |
| | pcs/box | boxs/Carton | Pcs/Box | N.W./Pcs | N.W./Box | G.W./Box |
| UCR04-0161X-00XR | 600 | 6 | 3600 | ---- | ---- | ---- |

| | | | | | |
|-----------------------------------------------------|-------|-----------------------------------------------------------------------------------------------------|-----|------------------------------------------------|------|
| | | 深圳市华德共创科技有限公司 Shenzhen Huade co-create Technology Co.,LTD 电话: 0755-23304126 传真: 0755-29940187 | | | |
| -TOLERANCES- UNLESS OTHERWISE SPECIFIED 公差参数表 | | | | TITLE: TYPE C 16PIN 板上型垫高1.9 产品名称: 双壳 L=8.0 | |
| X.X | ±0.30 | X.X* | ±3° | APPD: 核准: | |
| X.XX | ±0.20 | X.XX* | ±2° | CHECK: 校对: 王建业 | |
| X.XXX | ±0.10 | X.XXX* | ±1° | DRAW: 绘图: 黄艳兰 | |
| | | 2016-03-12 | 1:1 | mm | A001 |