

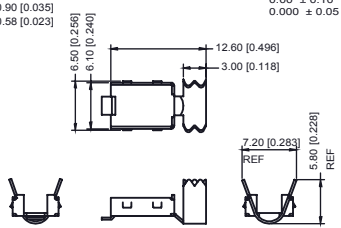

UNLESS OTHERWISE SPECIFIED IN MM:  
0.0 ± 0.20 ANGLE x°  
0.00 ± 0.10  
0.000 ± 0.05

THIS IS A C.A.D. GENERATED DRAWING  
DO NOT MAKE MANUAL REVISIONS TO MASTER.

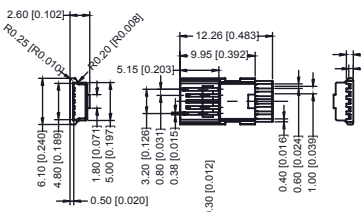

**TOP METAL SHELL**

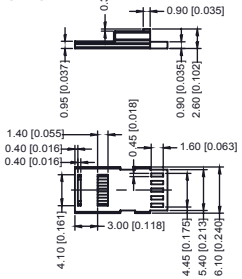

**INSULATOR**

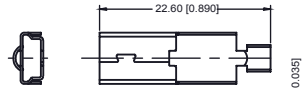

**BOTTOM METAL SHELL**

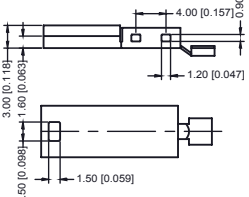

**NUT**

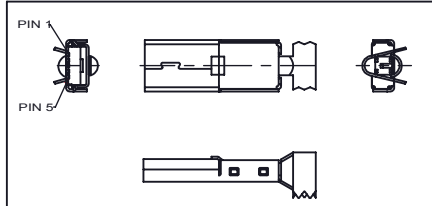

**RECOMMENDED ASSEMBLY**

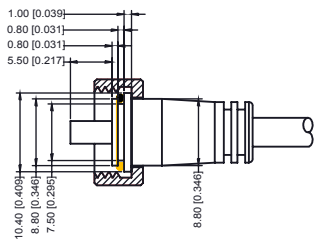

1. MATERIAL :
- 1-1. HOUSING : PBT UL 94V-0  
COLOR : BLACK
  - 1-2. CONTACT : BRASS
  - 1-3. NUT : PBT UL94V-0
  - 1-4. O-RING : NBR (1\*8) ; COLOR : BLACK.

2. FINISH :
- 2-1. CONTACT AREA : GOLD PLATED  
OTHER AREA : GOLD FLASH  
SOLDER AREA : BRIGHT TIN
3. SPECIFICATION :
- 3-1. WATER PROOF : IPX7

**WATERPROOF MINI USB TYPE B, 5P  
(MALE)**



THIS SERIES FULLY CONFORMS TO THE EUROPEAN UNION DIRECTIVES 2011/65/EU FOR RoHS COMPLIANCY.



EDAC INC  
TORONTO, ONTARIO  
CANADA

YOUR CONNECTION TO QUALITY & SERVICE

THESE DRAWINGS AND SPECIFICATIONS ARE THE PROPERTY OF EDAC INC, AND SHALL NOT BE REPRODUCED OR COPIED OR USED AS THE BASIS FOR THE MANUFACTURE OR SALE OF APPARATUS WITHOUT WRITTEN PERMISSION.

ACAD REFERENCE NO. : 690-W05-260-043	
DRAWN:R.STA.MONICA	DATE: MAY.01/2014
CHECKED:	DATE:
PART NUMBER <b>690-W05-260-043</b>	
SHEET 1 OF 1	
DRAWING NUMBER <b>690-W05-260-043</b>	ISSUE 2