

PCB TERMINAL BLOCKS

7.5mm Pitch High Power Rising Clamp Terminal

- 2 & 3 pole double interlocking mechanism for increased strength
- 4-12 pole pre-assembled
- Moulded in green UL94-V0 flame retardant PA
- Professional rising clamp terminals
- 0.2-4.0mm² (30-12AWG) solid cable
- 0.2-2.5mm² (30-12AWG) stranded cable
- Guided pin alignment
- Captive screw
-  approved

CTB07VK



TYPE NO.	POLES	LENGTH
CTB07VK/2	2	15mm
CTB07VK/3	3	22.5mm
CTB07VK/4	4	30mm
CTB07VK/5	5	37.5mm
CTB07VK/6	6	45mm
CTB07VK/7	7	52.5mm
CTB07VK/8	8	60mm
CTB07VK/9	9	67.5mm
CTB07VK/10	10	75mm
CTB07VK/11	11	82.5mm
CTB07VK/12	12	90mm

SPECIFICATION

Rating	24A/500V UL=16A/300V, VDE&IMQ=24A/750V
Dielectric strength	≥2.5kV
Impulse strength	4kV
Working temperature	110°C
Moulding	UL94-V0 flame retardant PA
Pin/terminal	Tinned, nickel plated brass
Wire clamp	Nickel plated brass
Screw/torque	M3 steel zinc plated, 0.5Nm
Recommended PCB hole size	ø1.3mm

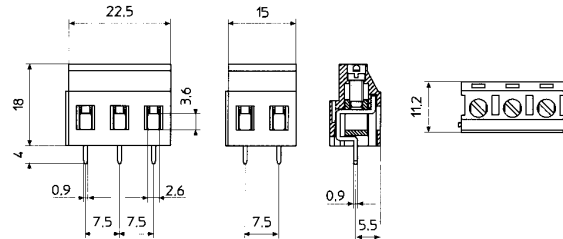

PCB
TERMINAL
BLOCKS

INTER-
CONNECTION

FUSES &
FUSE-
HOLDERS

LEDs &
INDICATORS

MINIATURE
SWITCHES

LIMIT &
SAFETY
SWITCHES

CONTROL
PRODUCTS

INTERFACE
MODULES &
SUPPORTS

7.5mm Pitch High Power 90° Rising Clamp Terminal

- 2 & 3 pole double interlocking mechanism for increased strength
- 4-12 pole pre-assembled
- Moulded in green UL94-V0 flame retardant PA
- Professional rising clamp terminals
- 0.2-4.0mm² (30-12AWG) solid cable
- 0.2-2.5mm² (30-12AWG) stranded cable
- Guided pin alignment
- Captive screw
-  approved

CTB07HK



TYPE NO.	POLES	LENGTH
CTB07HK/2	2	15mm
CTB07HK/3	3	22.5mm
CTB07HK/4	4	30mm
CTB07HK/5	5	37.5mm
CTB07HK/6	6	45mm
CTB07HK/7	7	52.5mm
CTB07HK/8	8	60mm
CTB07HK/9	9	67.5mm
CTB07HK/10	10	75mm
CTB07HK/11	11	82.5mm
CTB07HK/12	12	90mm

SPECIFICATION

Rating	24A/500V UL=16A/300V, VDE&IMQ=24A/750V
Dielectric strength	≥2.5kV
Impulse withstand voltage	4kV
Working temperature	110°C
Moulding	UL94-V0 flame retardant PA
Pin/terminal	Tinned, nickel plated brass
Wire clamp	Nickel plated brass
Screw/torque	M3 steel zinc plated, 0.5Nm
Recommended PCB hole size	ø1.3mm

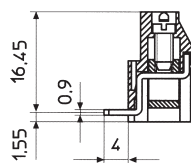

For other dimensions see CTB07VK

RELAY
BASES

ENCLOSURES

BATTERIES

TRANS-
FORMERS