

MAPX	MODIFICATION	DRW	DATE

NOTES:
 1. MATERIAL: SEE "TABLE 1";
 2. FINISH: SEE "TABLE 1";

3. ELECTRICAL :

- 3-1. CONTACT CURRENT RATING :
 3A (VBUS PIN 1.5A/PIN MAX),
 3A (GND PIN 1.25A/PIN MAX), 0.25A/PIN
 (OTHER PIN).
- 3-2. INSULATION RESISTANCE :
 100 MEGAOHMS MIN. AT 250VDC.
- 3-3. DIELECTRIC WITHSTANDING VOLTAGE :
 100VAC MIN.
- 3-4. LOW LEVEL CONTACT RESISTANCE :
 INITIAL 40mΩ MAX.
 AFTER 50mΩ MAX.

4. MECHANICAL CHARACTERISTICS :

- 4-1. MATING FORCE: 5*20N.;
- 4-2. UNMATING FORCE: 6*20N(INITIAL),
- 4-3. OPERATING TEMPERATURE : -40° C TO +80° C

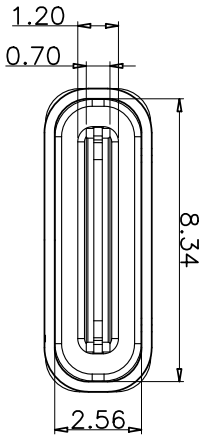
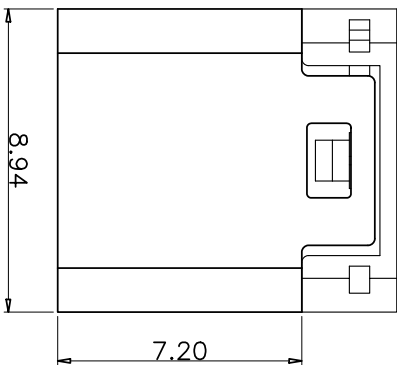
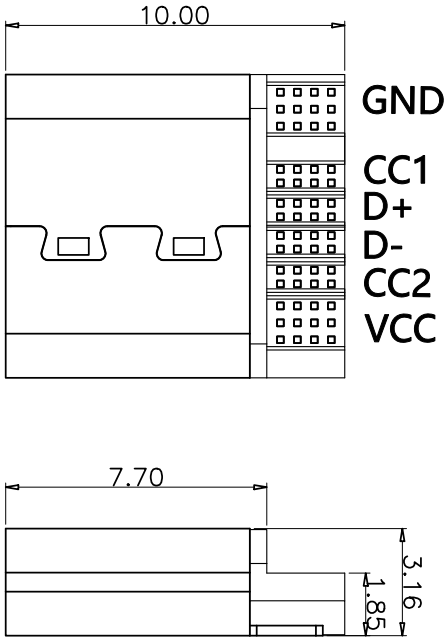

NO.	PART NAME	QTY	MATERIAL	DESCRIPTION	REMARK
④	Shell	1	SUS 304	NI PLATING	T=0.30mm
③	MID PLATE	SUS 304		Au1u"	T=0.15mm
②	Terminal	15	Q2680	PLATING	T=0.15mm
①	Housing	3	LCP 1301		

TABLE 1:

Signal Name	Signal Name
A1 GND	B12 GND
A2 SSTXp1	B11 SSRXp1
A3 SSTXn1	B10 SSRXn1
A4 VBUS	B9 VBUS
A5 CC1	B8 SBU2
A6 DP1	B7 Dn2
A7 Dn1	B6 Dp2
A8 SBU1	B5 CC2
A9 VBUS	B4 VBUS
A10 SSRXn2	B3 SSTXn2
A11 SSRXp2	B2 SSTXp2
A12 GND	B1 GND

NOTES:

- 1. 产品外观不得有压伤, 缩水, 缺胶等不良, 毛边不大於0.05
- 2. 产品组装后无不导通现象
- 3. 产品材质, 端子: C2680, T=0.25±0.01
 外壳: SUS201, T=0.30±0.01
 胶芯: .
- 4. 电镀规格: 端子镀半金锡0.5u", 外壳镀镍

产品图
 PRODUCT CHART DWG
 公差一览表
 TOLERANCE UNLESS OTHERWISE

X	±0.25	X	±5.°
X	±0.20	X	±2.°
XX	±0.15	XX	±1.°
XXX	±0.10	XXX	±0.5°

深圳市精拓金电子有限公司
 Shenzhen Jing Tuo Jin Electronics Co., Ltd.

单位	MM	制图	林属升	制图料号	918-468R2028W50000
比例	1:1	审核	郭治富	产品名称	TYPE-C9P IN简易型数据线Z. 7/10. 0
日期	2020-05-22	核准	黄国荣	角法	LCP 覆胶
DATE		APPD		版本	A0