

REV	LOCATIONS	DESCRIPTION	DATE	REVISER	APPD
1		Electrical Change	06/Nov/20	CHERRY	KATE
2		Tolerance change	31/JUL/23	MATT	LEO

SPECIFICATIONS

Electrical

Current Rating: 1A Max AC(rms)/DC

Voltage Rating: 30V AC(rms)/DC

Contact Resistance: 50 mΩ Max

Withstanding Voltage: 100V AC r.m.s

Insulation Resistance: 100 MΩ Min

Temperature Range—Operating: -30°C~+80°C

Material And Plating

Housing: Thermoplastic (UL94V-0), Black

Contact: Copper Alloy /Gold Plated

Shell: Copper Alloy /Nickel Plated

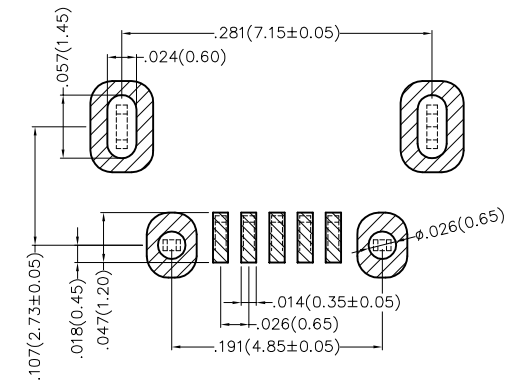
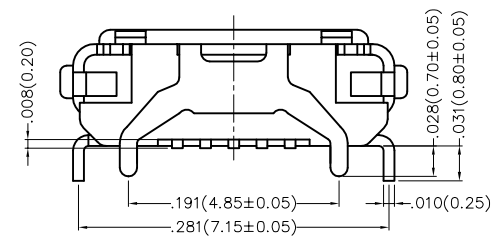
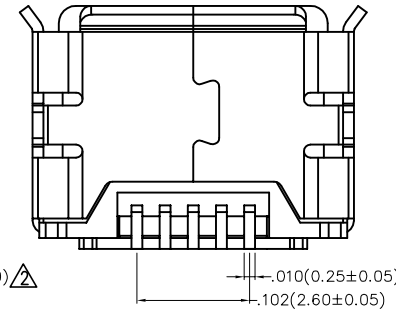
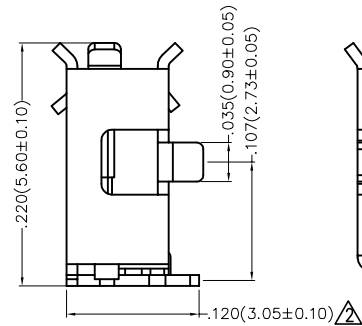
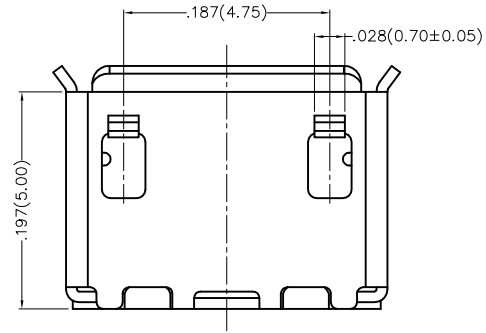
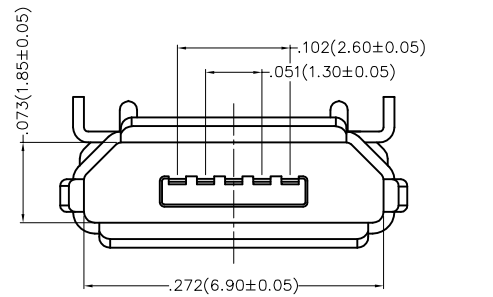

Recommended P.C.Board Layout

General Tolerances: ±0.05mm

	GENERAL TOLERANCES (UNLESS SPECIFIED)		APPROVE BY	DATE	PART NO.	ITEM NO.	
	X.±.012(0.30)	X.±5'	FRANK	13/FEB/17	FUS447-FSBK6M	FUS447	
DESIGN UNITS	X.X±.008(0.20)	.X'±2'	CHECKED BY	DATE	TITLE		REV 2
Inch (metric)	X.XX±.006(0.15)	.XX'±1'	CHERRY	13/FEB/17	Micro USB 5Circuits 90°Angle Female(SMT)		
SCALE	X.XXX±.004(0.10)	.XXX'±0.5'	DRAWN BY	DATE	THIS DRAWING CONTAINS INFORMATION THAT IS PROPRIETARY TO TXGA INDUSTRIAL ELECTRONICS(S.Z)CO.,LTD AND SHOULD NOT BE USED WITHOUT WRITTEN PERMISSION		
5:1			KATE	13/FEB/17			

REV	LOCATIONS	DESCRIPTION	DATE	REVISER	APPD

A
B
C
D
E
F

A
B
C
D
E
F

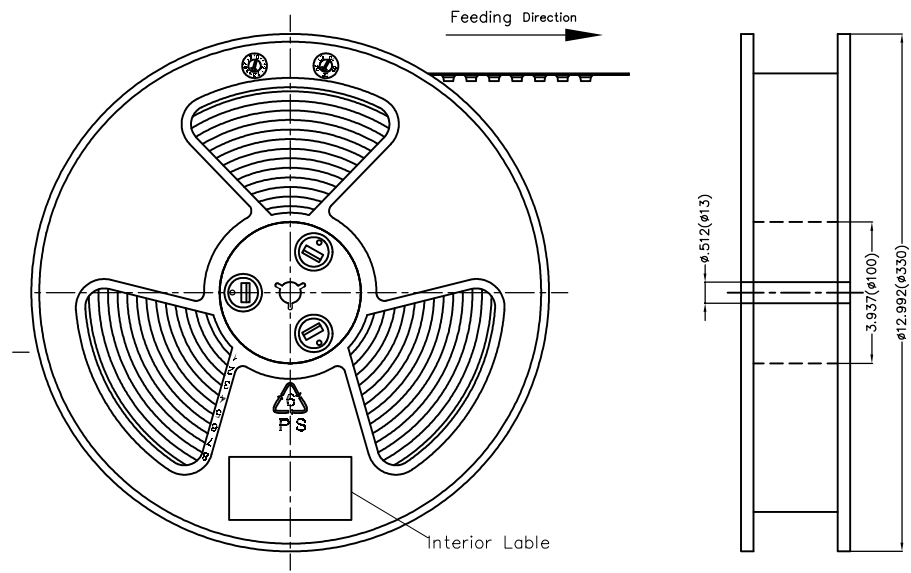

- Note:
1. 10 sprocket hole cumulative tolerance ± 0.2
 2. Carrier camber is within 1.0mm in 250mm
 3. Material: White Conductive polystyrene Alloy 100% recyclable
 4. All dimensions meet EIA-481-3 requirements
 5. Peel off force of cover tape & carrier tape: 20g~130g(0.2N~1.3N)
 6. Component load per 13" reel: 1,500 pcs

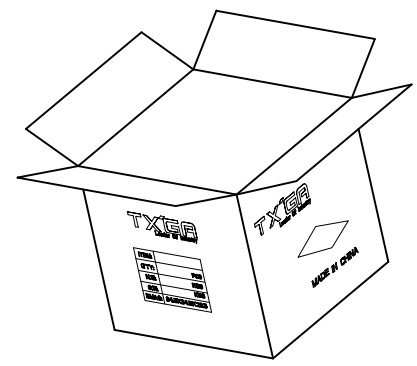
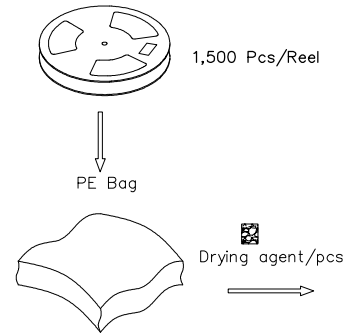
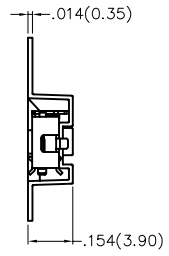
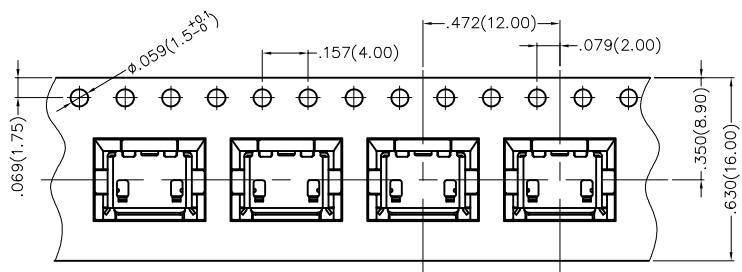
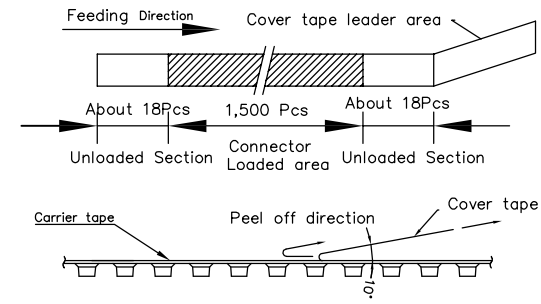

<p>THIRD ANGLE PROJECTION</p>	GENERAL TOLERANCES (UNLESS SPECIFIED)		APPROVE BY	DATE	PART NO.	ITEM NO.	<p>Leader Of Industry</p>
	X. \pm .012(0.30)	X. \pm 5'	FRANK	13/FEB/17	FUS447-FSBK6M	FUS447	
	X.X \pm .008(0.20)	.X \pm 2'	CHECKED BY	DATE	TITLE		
	X.XX \pm .006(0.15)	.XX \pm 1'	CHERRY	13/FEB/17	Micro USB 5Circuits 90°Angle Female(SMT)		
SCALE	SIZE	X.XXX \pm .004(0.10)	.XXX \pm 0.5'	DRAWN BY	DATE	THIS DRAWING CONTAINS INFORMATION THAT IS PROPRIETARY TO TXGA INDUSTRIAL ELECTRONICS(S.Z)CO.,LTD AND SHOULD NOT BE USED WITHOUT WRITTEN PERMISSION	
5:1	A4			KATE	13/FEB/17	REV 2	SHEET NO. 2/2