

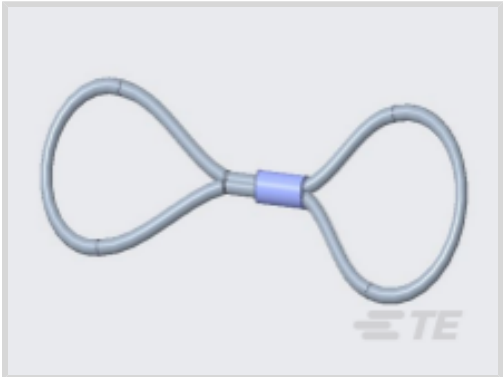

Connectors > Automotive Connectors > Automotive Connector Accessories > Other Automotive Connector Accessories



Automotive Connector Accessory Type: **Cap**

Primary Product Material: **Rubber**

Primary Product Color: **Black**

Operating Temperature Range: **55 – 125 °C [-67 – 257 °F]**

Features

Product Type Features

| | |
|-------------------------------------|-----|
| Automotive Connector Accessory Type | Cap |
|-------------------------------------|-----|

Body Features

| | |
|--------------------------|--------|
| Primary Product Material | Rubber |
| Primary Product Color | Black |

Usage Conditions

| | |
|-----------------------------|---------------------------|
| Operating Temperature Range | 55 – 125 °C[-67 – 257 °F] |
|-----------------------------|---------------------------|

Product Compliance

For compliance documentation, visit the product page on TE.com>

| | |
|---|--|
| EU RoHS Directive 2011/65/EU | Compliant |
| EU ELV Directive 2000/53/EC | Compliant |
| China RoHS 2 Directive MIIT Order No 32, 2016 | No Restricted Materials Above Threshold |
| EU REACH Regulation (EC) No. 1907/2006 | Current ECHA Candidate List: JUNE 2023 (235) Candidate List Declared Against: JAN 2023 (233) Does not contain REACH SVHC |
| Halogen Content | Low Halogen - Br, Cl, F, I < 900 ppm per homogenous material. Also BFR/CFR/PVC Free |
| Solder Process Capability | Not applicable for solder process capability |



Product Compliance Disclaimer

This information is provided based on reasonable inquiry of our suppliers and represents our current actual knowledge based on the information they provided. This information is subject to change. The part numbers that TE has identified as EU RoHS compliant have a maximum concentration of 0.1% by weight in homogenous materials for lead, hexavalent chromium, mercury, PBB, PBDE, DBP, BBP, DEHP, DIBP, and 0.01% for cadmium, or qualify for an exemption to these limits as defined in the Annexes of Directive 2011/65/EU (RoHS2). Finished electrical and electronic equipment products will be CE marked as required by Directive 2011/65/EU. Components may not be CE marked. Additionally, the part numbers that TE has identified as EU ELV compliant have a maximum concentration of 0.1% by weight in homogenous materials for lead, hexavalent chromium, and mercury, and 0.01% for cadmium, or qualify for an exemption to these limits as defined in the Annexes of Directive 2000/53/EC (ELV). Regarding the REACH Regulation, the information TE provides on SVHC in articles for this part number is based on the latest European Chemicals Agency (ECHA) 'Guidance on requirements for substances in articles' posted at this URL: <https://echa.europa.eu/guidance-documents/guidance-on-reach>

Compatible Parts



TE Part # CAT-H3910-RC1748
Receptacle Dust Caps — DEUTSCH HD10



TE Part # CAT-H3910-PC1748
DEUTSCH HD10 PLUG DUST CAPS



TE Part # CAT-H396-RC8382
Receptacle Protective Caps — DEUTSCH HDP20

Customers Also Bought



TE Part #HDC16-9-E004
DUST CAP ASM



TE Part #3-2112162-1
21POS,TAB2.8X0.8,TABHSG,CODE C, ASSY,SLD



TE Part #HD10-9-96PE-B025
RECP ASM



TE Part #HDP26-24-7SN-CL18
PLG, 7P, BLK, N, 4AWG, RNG, 4/16, S



TE Part #HD10-9-GKT
GASKET, 9SZ, BLK, HD10



TE Part #1011-258-0205
BKSHL, 2P, BLK, REC,RA,SR,NW6/7.5 /8.5/10



TE Part #1-1718485-5
AMP MCP Backshells



TE Part #HC5734
LEAD CONNECTOR 50mm +VE

Documents

Product Drawings
RUBBER LANYARD

English

CAD Files



3D PDF

3D

Customer View Model

ENG_CVM_CVM_JDL082397_99.2d_dxf.zip

English

Customer View Model

ENG_CVM_CVM_JDL082397_99.3d_igs.zip

English

Customer View Model

ENG_CVM_CVM_JDL082397_99.3d_stp.zip

English

By downloading the CAD file I accept and agree to the [Terms and Conditions](#) of use.

Datasheets & Catalog Pages

CONNECTOR SELECTOR

English

Product Specifications

Application Specification

English