

FRONT VIEW

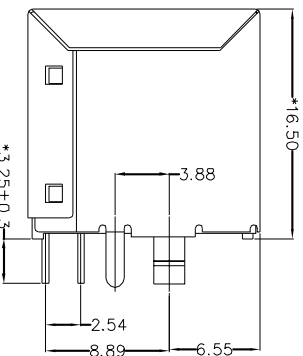

RIGHT SIDE VIEW

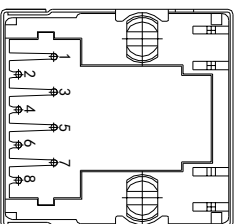

BACK VIEW

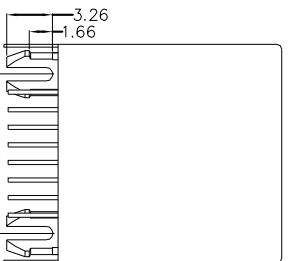

BOTTOM VIEW

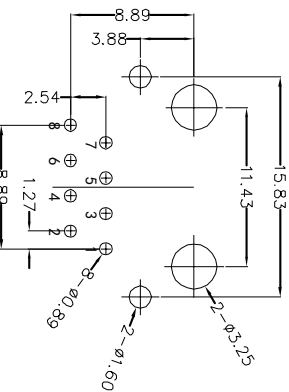
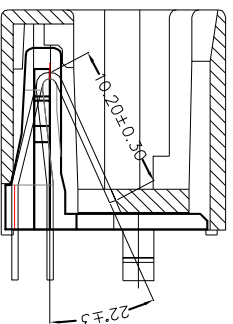
RECOMMENDED PCB LAYOUT
VIEWED FROM COMPONENT SIDE

内部金针示意图

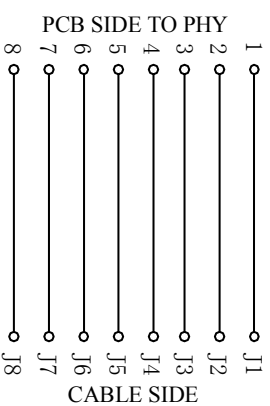

MATERIAL:
HOUSING: PBT, UL94V-0, BLACK.
TERMINAL: PHOSPHOR BRONZE Ø=0.46MM,
G/FU" GOLD PLATING ON CONTACT AREA.
SHIELD: C2680, T=0.20MM, 20 MIN NICKEL PLATING
ON ALL AREA.

MACHANICAL:
DURABILITY: 750 CYCLES MIN, 12.5MM/MINUTE.
INSERTION FORCE: 2.2KG.F MAX.
RETENTION STRENGTH: 7.7KG.F BETWEEN JACK AND PLUG.
OPERATING TEMPERATURE: -40°C ~ +85°C.
STORAGE TEMPERATURE: -40°C ~ +85°C.
ALL CRITICAL DIMENSIONS WITH "±0.1"

ELECTRICAL:
VOLTAGE: 125 VOLTS AC.
CURRENT RATING: 1.5AMP.
DIELECTRIC STRENGTH: 1000 VAC RMS 50HZ OR 60HZ, 1MIN.
INSULATION RESISTANCE: 500 MEGA OHMS MIN. INITIAL
AFTER 500V DC FOR 1 MINUTE.
CONTACT RESISTANCE: SINGLE TERMINAL 30 MILLIOHMS MAX.
INITIAL 50 MILLIOHMS MAX. AFTER
DURABILITY TEST.

MODEL: RJ45-8P8C-B1WPW-224GC	DRAWN BY : <i>Leiqin</i>	DATE:
TITLE : 单口无灯屏蔽无弹插件	CHECKED BY : <i>Liwei</i>	DATE:
DRAWING NO:	REV. : A	APPROVED BY: <i>Wuxin</i>
SHEET: 1 OF 1	SCALE: 3:1	SIZE: A4 UNIT : mm

GENERAL TOLERANCE: (UNLESS SPECIFIED)	
X, ±0.30mm	X, ± 3'
X.X, ±0.25mm	X.X, ± 2'
X.XX, ±0.20mm	X.XX, ± 1'
X.XXX±0.10mm	X.XXX± 0.5'

MEASURE POINT:
QUADRANT POINT (QP)
TANGENCY POINT (TP)
INTERSECTION POINT (IP)



深圳市吉威电子有限公司
深圳市元吉威电子有限公司