

SIGN	DESCRIPTION	DATE	APPROVER

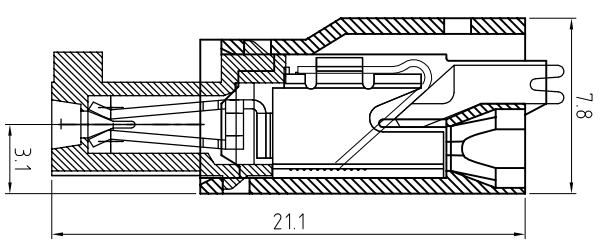
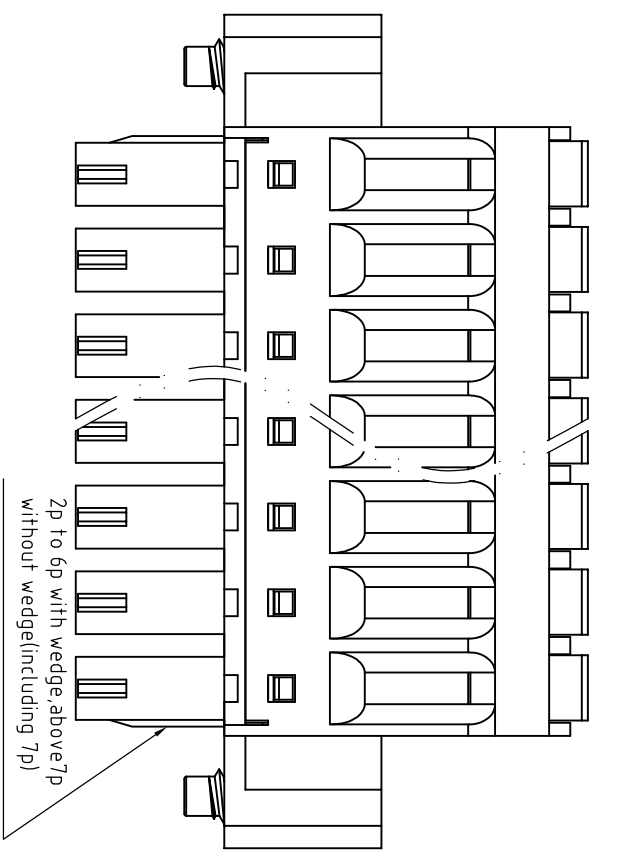
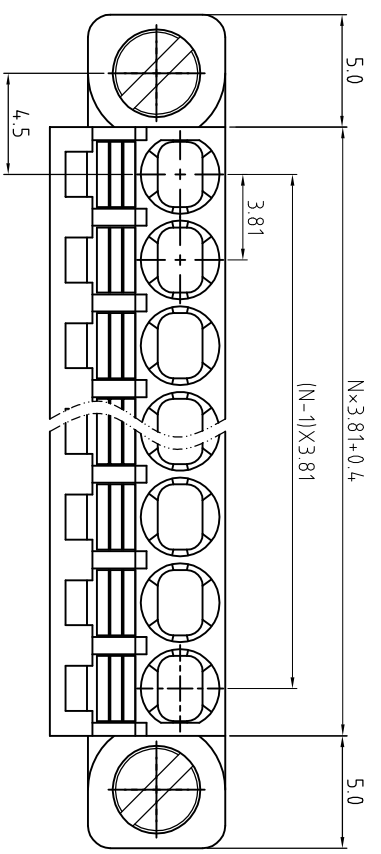

Technical Data:

Material:

- terminal: Copper Alloy with Tin plated
- Spring Clamp: Stainless steel
- Insulator body(housing): Polyamide(Ul 94V-0)

Electrical

- Voltage rating: 300VAC
- Current rating: 12 Amps/way max
- Contact resistance: 20mΩ(max)
- Withstanding Voltage: 2500VAC(1min) Test time=60sec/1pcs
- Wire range: 16-24AWG

Mechanical:

- Operating temperature: -40°C to +105°C
- Soldering reliability: Test temperature= 250°C±10°C
- 5 seconds max

Ordering Information:

- F73 - K - C XX - 0 0 0 X 0
- 2 02
- 24 24
- 5 Green
- 6 Blue
- 8 Grey
- A Black

N=Number of contacts

WELINK 恒翊电子科技有限公司
 Welink International Co., LTD.

TOLERANCE	APPROVED:	NAME:
X. ±0.50	CHECKED:	F73 - K - pitch3.81mm
XX ±0.30	DRAWN: Ling Yu	- series
XXX ±0.20	UNITS: mm	
X° ±1°	REV: A	
	SCALE: 4 / 1	
	PAGE: 1 / 1	
	DWG NO: 9F73KC001A	