

REV	ECN NO.	DATE

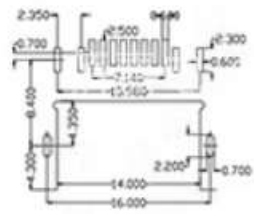
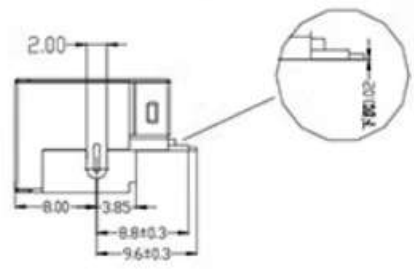
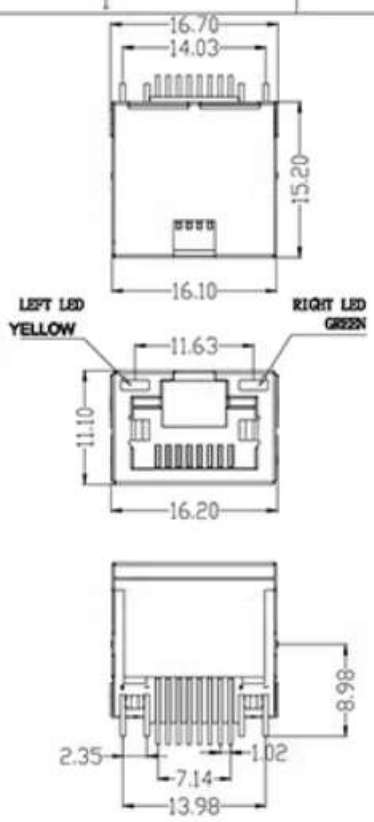

PCB参考图

**主要参数:**

1. 额定电压, 电流: 125V/1.5A max
2. 接触电阻: 40m Ω Max 初始态 100 Ω Max 最终态
3. 绝缘电阻: 500M Ω Min
4. 试验条件: DC500V/5.0mA for 1 minute
5. 盐雾测试: 8±0.5H

**其他要求:**

1. 产品应无错装, 漏装零件等现象;
2. 零件表面应无裂纹, 缺料, 飞边等现象, 表面镀层应光亮美观
3. 未注尺寸公差为±0.15mm

