

# ZB5AVBG1

Light block with body/fixing collar, plastic,  
white, integral LED, 24...120 V AC/DC



## Main

|                               |  |
|-------------------------------|--|
| Range of product              | Harmony XB5  |
| Product or component type     | Complete body/light block assembly   |
| Device short name             | ZB5  |
| Fixing collar material        | Plastic  |
| Sale per indivisible quantity | 1  |
| Connections - terminals       | Screw clamp terminals, $\leq 2 \times 1.5 \text{ mm}^2$ with cable end EN 60947-1<br>Screw clamp terminals, $\geq 1 \times 0.22 \text{ mm}^2$ without cable end EN 60947-1 |
| Light source                  | Protected LED  |
| Bulb base                     | Integral LED   |
| Light source colour           | White  |

## Complementary

|  |   |
|--|---|
| CAD overall width                      | 1.18 in (30 mm)   |
| CAD overall height                     | 1.65 in (42 mm)   |
| CAD overall depth                      | 1.26 in (32 mm)   |
| Terminals description ISO n°1          | (X1-X2)PL   |
| Net Weight                             | 0.05 lb(US) (0.022 kg)  |
| Tightening torque                      | 0.8...1.2 N.m conforming to EN 60947-1  |
| Shape of screw head                    | Cross compatible with Philips no 1 screwdriver<br>Cross compatible with pozidriv No 1 screwdriver<br>Slotted compatible with flat Ø 4 mm screwdriver<br>Slotted compatible with flat Ø 5.5 mm screwdriver |
| [Ui] rated insulation voltage          | 600 V 3)EN 60947-1  |
| [Uimp] rated impulse withstand voltage | 6 kV EN 60947-1   |
| Signalling type                        | Steady  |
| [Us] rated supply voltage              | 24...120 V AC/DC 50/60 Hz   |
| Supply voltage limits                  | 19.2...132 V DC<br>21.6...132 V AC  |
| Service life                           | 100000 h at rated voltage and 25 °C   |
| Surge withstand                        | 1 kV IEC 61000-4-5  |
| Device presentation                    | Basic sub-assemblies  |

## Environment

|                                       |   |
|---------------------------------------|---|
| Protective treatment                  | TH  |
| Ambient air temperature for storage   | -40...158 °F (-40...70 °C)  |
| Ambient air temperature for operation | -40...158 °F (-40...70 °C)  |
| Electrical shock protection class     | Class II IEC 60536  |
| Standards                             | UL 508<br>EN/IEC 60947-5-4<br>CSA C22.2 No 14<br>EN/IEC 60947-5-1<br>EN/IEC 60947-1<br>JIS C8201-5-1<br>JIS C8201-1 |

|                                       |  |
|---------------------------------------|--|
| Product certifications                | RINA<br>DNV<br>BV<br>CSA<br>UL Listed<br>LROS (Lloyds register of shipping)<br>GL  |
| Vibration resistance                  | 5 gn (f= 2...500 Hz) conforming to IEC 60068-2-6   |
| Shock resistance                      | 30 gn (duration = 18 ms) for half sine wave acceleration conforming to IEC 60068-2-27<br>50 gn (duration = 11 ms) for half sine wave acceleration conforming to IEC 60068-2-27 |
| Resistance to fast transients         | 2 kV IEC 61000-4-4   |
| Resistance to electromagnetic fields  | 9.14 V/m (10 V/m) IEC 61000-4-3  |
| Resistance to electrostatic discharge | 6 KV on contact (on metal parts) IEC 61000-2-6<br>8 kV in free air (in insulating parts) IEC 61000-2-6   |
| Electromagnetic emission              | Class B IEC 55011  |





## Ordering and shipping details



|                       |   |
|-----------------------|---|
| Category              | 22469 - PUSHBUTTON,22MM ACCESSORIES-NEW |
| Discount Schedule     | CS2                                     |
| GTIN                  | 00785901613374                          |
| Nbr. of units in pkg. | 1                                       |
| Package weight(Lbs)   | 0.05 lb(US) (0.02 kg)                   |
| Returnability         | Yes                                     |
| Country of origin     | FR                                      |

## Packing Units

|                              |                         |
|------------------------------|-------------------------|
| Unit Type of Package 1       | PCE                     |
| Package 1 Height             | 2.13 in (5.4 cm)        |
| Package 1 width              | 1.34 in (3.4 cm)        |
| Package 1 Length             | 2.20 in (5.6 cm)        |
| Unit Type of Package 2       | BB1                     |
| Number of Units in Package 2 | 5                       |
| Package 2 Weight             | 3.88 oz (110 g)         |
| Package 2 Height             | 2.20 in (5.6 cm)        |
| Package 2 width              | 1.34 in (3.4 cm)        |
| Package 2 Length             | 10.63 in (27 cm)        |
| Unit Type of Package 3       | S03                     |
| Number of Units in Package 3 | 200                     |
| Package 3 Weight             | 11.05 lb(US) (5.013 kg) |
| Package 3 Height             | 11.81 in (30 cm)        |
| Package 3 width              | 11.81 in (30 cm)        |
| Package 3 Length             | 15.75 in (40 cm)        |

## Offer Sustainability

|                            |   |
|----------------------------|---|
| Sustainable offer status   | Green Premium product   |
| California proposition 65  | WARNING: This product can expose you to chemicals including: Lead and lead compounds, which is known to the State of California to cause cancer and birth defects or other reproductive harm. For more information go to <a href="http://www.P65Warnings.ca.gov">www.P65Warnings.ca.gov</a> |
| REACH Regulation           |  <a href="#">REACH Declaration</a>   |
| REACH free of SVHC         | Yes   |
| EU RoHS Directive          | Pro-active compliance (Product out of EU RoHS legal scope)  <a href="#">EU RoHS Declaration</a>  |
| Mercury free               | Yes   |
| RoHS exemption information |  <a href="#">Yes</a>   |
| China RoHS Regulation      |  <a href="#">China RoHS Declaration</a>  |

|                             |  |
|-----------------------------|--|
| Environmental Disclosure    | <a href="#"> Product Environmental Profile</a> |
| Circularity Profile         | <a href="#"> End Of Life Information</a>      |
| WEEE                        | The product must be disposed on European Union markets following specific waste collection and never end up in rubbish bins.   |
| <b>Contractual warranty</b> |  |
| Warranty                    | 18 months  |

---

Dimensions

---

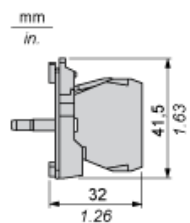

## Panel Cut-out for Pushbuttons, Switches and Pilot Lights (Finished Holes, Ready for Installation)

### Connection by Screw Clamp Terminals or Plug-in Connectors or on Printed Circuit Board



- (1) Diameter on finished panel or support
- (2) For selector switches and Emergency stop buttons, use of an anti-rotation plate type ZB5AZ902 is recommended.
- (3)  $\varnothing 22.5$  mm recommended ( $\varnothing 22.3 \text{ }_0^{+0.4}$ ) /  $\varnothing 0.89$  in. recommended ( $\varnothing 0.88 \text{ in. }_0^{+0.016}$ )

| Connections                                   | a in mm | a in in. | b in mm | b in in. |
|---|---------|----------|---------|----------|
| By screw clamp terminals or plug-in connector | 40      | 1.57     | 30      | 1.18     |
| By Faston connectors                          | 45      | 1.77     | 32      | 1.26     |
| On printed circuit board                      | 30      | 1.18     | 30      | 1.18     |

### Detail of Lug Recess



- (1) Diameter on finished panel or support
- (2) For selector switches and Emergency stop buttons, use of an anti-rotation plate type ZB5AZ902 is recommended.
- (3)  $\varnothing 22.5$  mm recommended ( $\varnothing 22.3 \text{ }_0^{+0.4}$ ) /  $\varnothing 0.89$  in. recommended ( $\varnothing 0.88 \text{ in. }_0^{+0.016}$ )