

PCB Layout

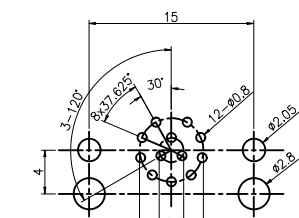

Pin Layout (Front view)

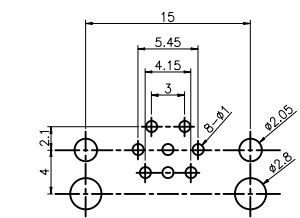
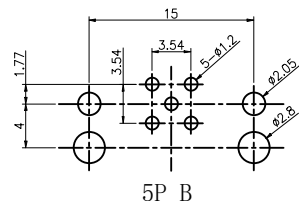
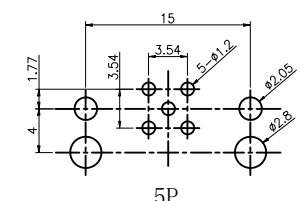
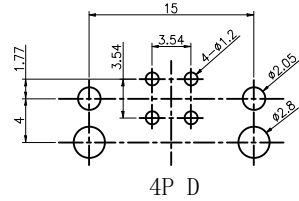
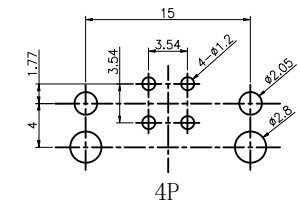
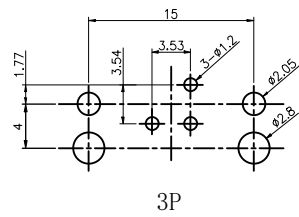
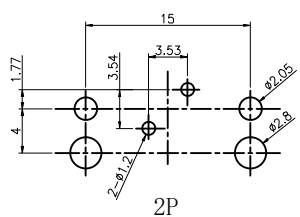
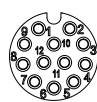
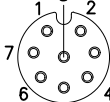
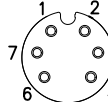
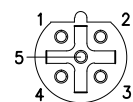
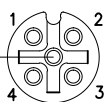
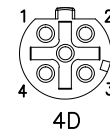
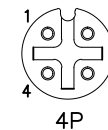
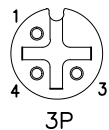
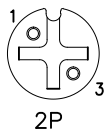

Electrical

| Contacts | 2 | 3 | 4 | 4D | 5 | 5B | 6 | 8 | 12 |
|---------------------------------|---------|---------|---------|---------|--------|--------|--------|--------|----------|
| Rated current/ Rated voltage | 4A/250V | 4A/250V | 4A/250V | 4A/250V | 4A/60V | 4A/60V | 2A/30V | 2A/30V | 1.5A/30V |
| Rated pulse voltage | 2500V | 2500V | 2500V | 2500V | 1500V | 1500V | 800V | 800V | 800V |
| Insulation resistance (MΩ) | ≥100 | ≥100 | ≥100 | ≥100 | ≥100 | ≥100 | ≥100 | ≥100 | ≥100 |
| Contact resistance (mΩ) | ≤5 | ≤5 | ≤5 | ≤5 | ≤5 | ≤5 | ≤5 | ≤5 | ≤5 |

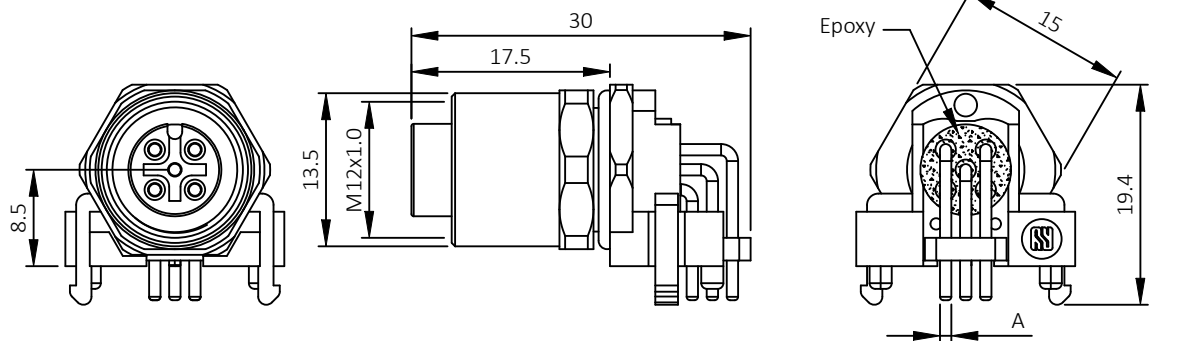

A:
2-5P:Ø1mm
8P:Ø0.8mm
12p:Ø0.6mm

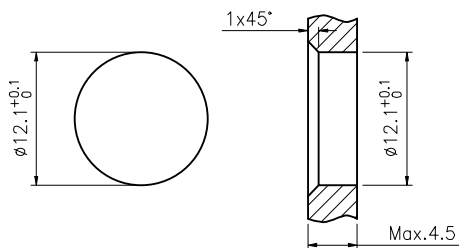

Recommended
Panel cut-out

General features:
Comply with IEC61076-2
Mating Cycles: min 500
Temperature Range: -40 to 85° C
Degree of Protection: IP67

Materials:
Contact:CuSn
Contact plating:Gold plated
Contact insert:PA66+GF UL94 black
Shell:CuZn nickel plated
Nut:CuZn nickel plated
Sealing:NBR black

-TOLERANCES-
UNLESS OTHERWISE
SPECIFIED



RENHOTEC GROUP

UNLESS OTHERWISE SPECIFIED
TOLERANCES FOR MILLIMETERS ARE:
0.5 - 8mm ± 0.20mm
8 - 30mm ± 0.25mm
30 - 120mm ± 0.30mm

| | | | | | |
|--|-------------------|-------|------|------|------|
| PART DESCRIPTION: R/A M12 female, Panel Mount, PCB Type | | | | | |
| Appr: JIM.KING | P/N: RHT-634-3392 | | | | |
| Check: | Date | Scale | Unit | Type | Page |
| Draw: DING | 2024.01.13 | Free | MM | Z | 1/1 |