

REV.	DESCRIPTION	ECN NO.	DATE	DRAWER

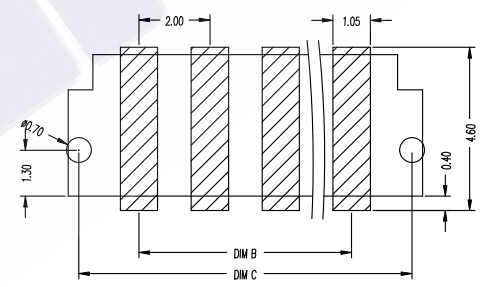

RECOMMENDED PCB LAYOUT  
TOL: (±0.05)

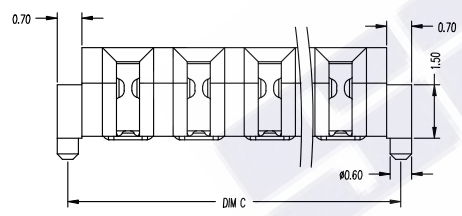
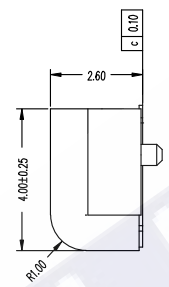
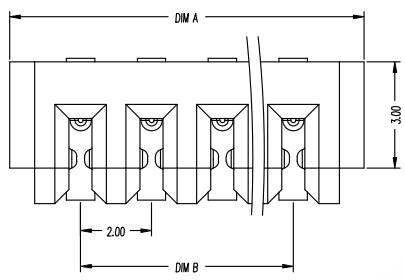
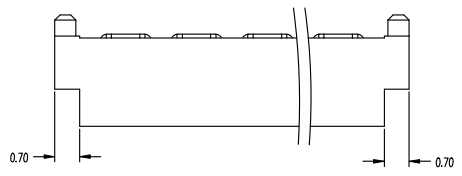
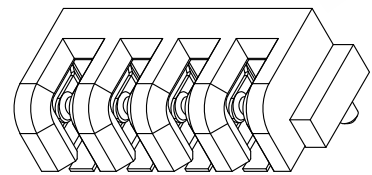

NOTES:

- 1.Material:  
Housing:LCP UL 94V-0,Black  
Terminal: Copper Alloy
- 2.Finish: Plating Gold
- 3.Specification  
Rated Voltage(Max.): 30V AC/DC  
Dielectric Strength: 1KV AC For 1 Minute  
Between Adjacent Terminal, No Breakdown  
Insulation Resistance: 1000 Megohms Min. 500V  
DC For 1 Minute Between Adjacent Terminal  
Operating Temperature: -20°C-80°C
- 4.Order information:

DZZE260CKAAO	22.00	18.00	21.40
DZZE260CJAAO	20.00	16.00	19.40
DZZE260CGAAO	18.00	14.00	17.40
DZZE260CFAAO	16.00	12.00	15.40
DZZE260CEAAO	14.00	10.00	13.40
DZZE260CDAAO	12.00	8.00	11.40
DZZE260CCAAO	10.00	6.00	9.40
DZZE260CBAAO	8.00	4.00	7.40
DZZE260CAAAO	6.00	2.00	5.40
Be filled	DIMA	DIMB	DIMC

DIMENSION IN mm [inch]		三佐部品【中国】股份有限公司	
Tolerance unless otherwise specified			
X. ± --	X.* ± 10*	ITEM : 2.0 Pitch Battery Female	
XX ± 0.38	XX.* ± 5*		
XX.X ± 0.25	XX.X.* ± 2*	PART NO: DZZE260C-□-AAO	Scale: 1 : 1
XXX ± 0.13	XXX.* ± --	DRAW NO: DZZE260	Size: A 4
Approver:	Checker:	Drawer: KEVIN	Rev: A
			Sheet: 1 / 1